

Locknuts KMK with Integral Locking Device

Material: Nut: St47.

Locking insert: Sintered metal.

Design: Metric ISO thread according to DIN 13 part 27.
Tolerance class: 5H or ISO 965/III-1980.

Reusable shaft nut with integrated locking device. Special feature of the shaft nut is the locking insert, integrated into the nut. This insert is threaded and thus does not cause any damage. The locking insert is pressed against the shaft thread with a locking screw and thus prevents the nut from turning.

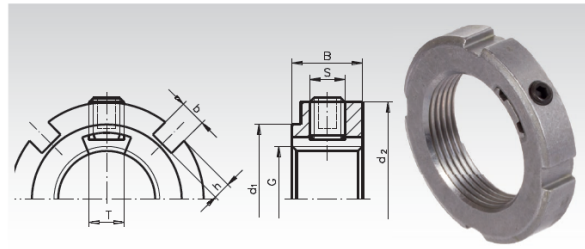

Ordering Details: e.g.: Product No. 653 530 00, Shaft Nut KMK, M10 x 0.75

Product No.	Thread		d ₁ mm	d ₂ mm	B mm	b mm	h mm	S mm	T mm	Fastening Torque of Locking Screw Nm	Permissible Axial Load N	Weight g
	G mm											
653 530 00	M10 x 0,75		16	20	9	3	2	M5	4	4	9800	16
653 532 00	M12 x 1		18	22	9	3	2	M5	4	4	11800	18
653 534 00	M15 x 1		21	25	9	4	2	M5	4	4	14600	21
653 537 00	M17 x 1		24	28	9	4	2	M5	4	4	19600	27
653 540 00	M20 x 1		28	32	9	4	2	M5	4	4	24000	30
653 544 00	M25 x 1,5		34	38	9	5	2	M5	10	4	31500	30
653 548 00	M30 x 1,5		41	45	9	5	2	M5	10	4	36500	60
653 553 00	M35 x 1,5		48	52	9	5	2	M5	10	4	50000	70
653 558 00	M40 x 1,5		53	58	11	6	2,5	M6	12	8	62000	110
653 562 00	M45 x 1,5		60	65	11	6	2,5	M6	12	8	78000	140
653 565 00	M50 x 1,5		65	70	15	6	2,5	M8	12	18	91500	180
653 568 00	M55 x 2		69	75	15	7	3	M8	12	18	91500	190
653 571 00	M60 x 2		74	80	15	7	3	M8	12	18	95000	200