

Phase out of DW-A-S 45 and 50 with casted housings

We will start to phase out the casted housings for the DW-A and the DW-S elements. The DW elements with casted housings are available as standard element until approximately the end of the year. The elements will be removed in future catalogues and future price lists.

Information: The casted housings were offered for many years. We decided to replace the casted housings with aluminium housings. The aluminium DW elements have new article numbers.

Affected articles with casted housings:

Part number: Part name:

01 101 015	DW-A 45x100
01 101 013	DW-A 50x120
01 101 028	DW-A 50x160
01 101 014	DW-A 50x200



Part number: Part name:

01 111 015	DW-S 45x100
01 111 013	DW-S 50x120
01 111 028	DW-S 45x160
01 111 014	DW-S 45x200



Alternative article with aluminium housings:

Part number: Part name:

01 101 044	DW-A 45x100
01 101 046	DW-A 50x120
01 101 047	DW-A 50x160
01 101 048	DW-A 50x200



Part number: Part name:

01 111 214	DW-S 45x100
01 111 216	DW-S 50x120
01 111 217	DW-S 45x160
01 111 218	DW-S 45x200



Proceeding:

- Form, fit and function is equivalent. The inner parts of the new DW-A are unpainted, the inner parts of the new DW-S are electrodeposited galvanic zinc coated.
- Please find additional information about the new DW products in the document: **dcn190404_New product DW 45 and DW 50 with aluminium housings**
- For customer specific parts we will contact you in time.

New product: DW-A / -C / -S 45 and 50 with aluminium housings

As informed with "dcn190403_phase out DW 45 and DW 50 with casted housings" we are proud to present the new products with aluminium housings instead of casted housings.

We decided to enlarge the DW 45 "family" with the element sizes DW 45x80 and DW 45x150.

Extract of the updated product overview on catalogue page 1.4:

DW Light metal profile	DW-A 15 to 38  Page 1.10	DW-C 15 to 38  Page 1.10	DW-S 15 to 38  Page 1.10	
	DW-A 45 and 50  Page 1.10	DW-C 45 and 50  Page 1.10	DW-S 45 and 50  Page 1.10	New Design

Extract of the updated product data on catalogue pages 1.10 and 1.11:

Rubber Suspension Units

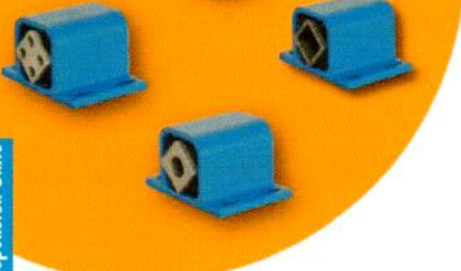

Type DW-A 15 to 50

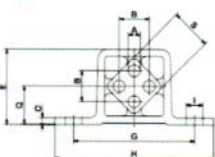

Type DW-C 15 to 50

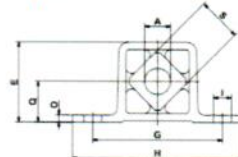

Length dimensions all types size 50x200



DW-A 15 to 50				DW-C 15 to 50				E	G	H	I	O	Q	S	L	L1 ±0.2	M	Weight [kg]
Art. No.	Type	øA ^{+0.5}	B	Art. No.	Type	øA												
01 101 043	DW-A 45x 80	12	35 +0.5	01 121 113	DW-C 45x 80	24 ^{±0.3}	81	115	145	13x27	9	41	45	80	90	-	1.10	
01 101 044	DW-A 45x100			01 121 114	DW-C 45x100		100	110	58	1.35								
01 101 045	DW-A 45x150			01 121 115	DW-C 45x150		150	160	90	2.00								
01 101 046	DW-A 50x120			01 121 116	DW-C 50x120		120	130	60	1.90								
01 101 047	DW-A 50x160	M12x40	40 +0.5	01 121 117	DW-C 50x160	30 ^{±0.3}	88	130	170	17x27	12	45	50	160	170	70	2.50	
01 101 048	DW-A 50x200			01 121 118	DW-C 50x200		200	210	70	3.10								

Housing sizes 45 and 50 ROSTA blue painted.

DW-S 15 to 50		øC	E	G	H	I	O	Q	S	L	L1 ±0.2	M	Weight [kg]
Art. No.	Type												
01 111 213	DW-S 45x 80	35 ^{±0.4}	81	115	145	13x27	9	41	45	80	90	-	1.26
01 111 214	DW-S 45x100									100	110	58	1.60
01 111 215	DW-S 45x150									150	160	90	2.30
01 111 216	DW-S 50x120	40 ^{±0.4}	88	130	170	17x27	12	45	50	120	130	60	2.20
01 111 217	DW-S 50x160									160	170	70	2.90
01 111 218	DW-S 50x200									200	210	70	3.60











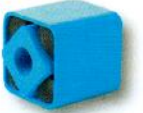
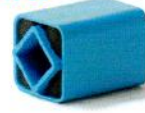



Inner part steel electrodeposited galvanic zinc coating.
Housing sizes 45 and 50 ROSTA blue painted.

Availability:

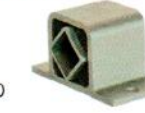
- The new products are available from now, please ask for delivery times
- Prices according to the price list

Selection chart for rubber suspension standard elements with Rubmix 10

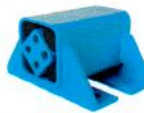
Rubber Suspension Units

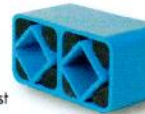
Inner square Housing	A Light metal profile, as from size 60 in steel	C Light metal profile	S Steel tube for plug-in connection	Accessories for housing Steel parts
DR Steel tube	DR-A 15 to 50 Page 1.6 	DR-C 15 to 50 Page 1.6 	DR-S 11 to 50 Page 1.7 	Bracket BR 11 to 50 Page 1.7 
DK Light metal profile	DK-A 15 to 50 Page 1.8 	DK-C on request 	DK-S 11 to 50 Page 1.8 	Bracket BK 11 to 50 Page 1.9 
DW Light metal profile	DW-A 15 to 38 Page 1.10 	DW-C 15 to 38 Page 1.10 	DW-S 15 to 38 Page 1.10 	Accessories for inner square A Steel parts WS 11 to 50 Page 1.13 
	DW-A 45 and 50 Page 1.10 	DW-C 45 and 50 Page 1.10 	DW-S 45 and 50 Page 1.10 	
DW Steel welded construction	DW-A 60 to 100 Page 1.11 			
DO Light metal profile Size 50 in nodular cast iron	DO-A 15 to 50 Page 1.12 	DO-C on request 	DO-S on request 	
Housing Specification inner squares	Ideal for alternating motions over neutral element position. For sizes DR 15–45: Fixation by means of 2 to 4 persistent threaded bars (sizes DR 27–45 also available with threaded holes).	Friction locking of the core by means of one central bolt, can be positioned in full 360° angle-range. For ideal friction locking, please remove paint cover on face side. For alternating element motion of max. ±10°.	For plug-in connection with square profile*. Plug-in length min. 2 x width across flat "C". Connection is not recommendable by alternating motions – play between the plugged squares.	* The square should be made out of bright steel, tolerance h9–h11. Possibly, the edges have to be overwinded (edge-radius in element profile max. 1.5 mm).

Specification

DR-A 15 x 25

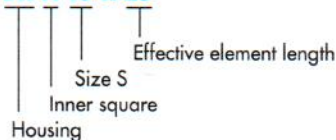

General

- Light metal profiles: extruded profiles, seawater resistant (DIN 1725).
- Blue protection paint: water-soluble paint, coating thickness 40–80 µm.
- Fixation screws: minimum strength class of 8.8
- Welding on elements: do not weld on rubber suspensions – welding heat will affect or destroy the rubber inserts – ask for customized elements
- Most of the elements can be supplied in stainless steel version – also zinc-plated versions or special paintings are available.

Further customized elements: see examples on page 1.14 to 1.19.



www.rosta.com

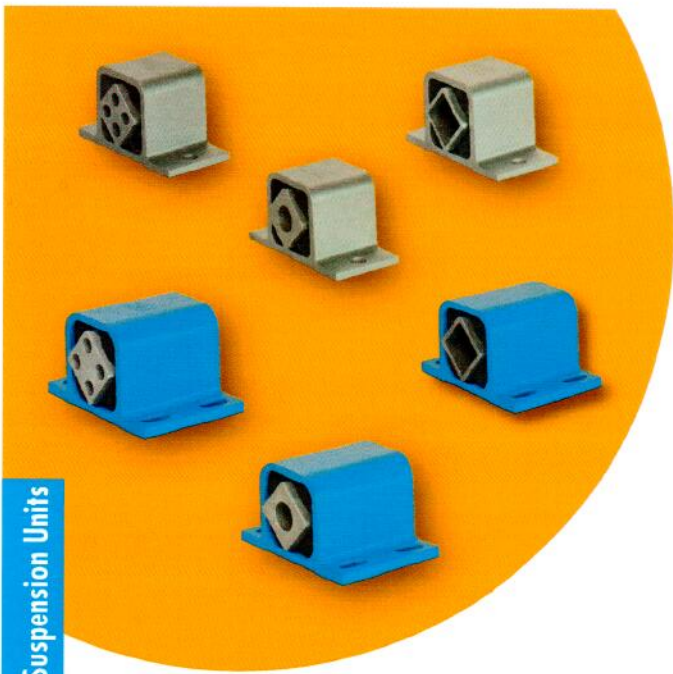

Rubber Suspension Units

Type DW-A 15 to 50

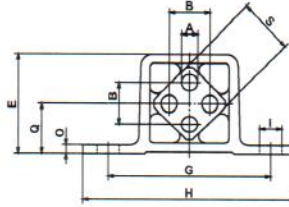

Type DW-C 15 to 50

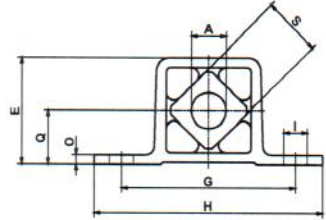

Type DW-S 15 to 50

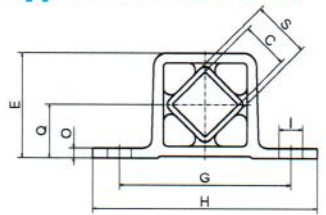

Length dimensions all types

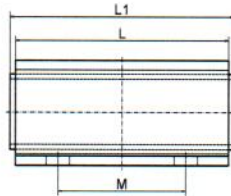
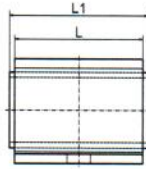

size 50x200

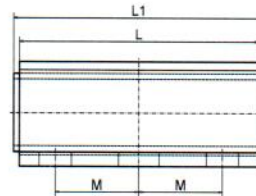

DW-A 15 to 50			DW-C 15 to 50			E	G	H	I	O	Q	S	L	L1 _{-0.3}	M	Weight [kg]	
Art. No.	Type	øA ^{+0.5}	B	Art. No.	Type												øA
01 101 016	DW-A 15x 25	5	10 ±0.2	01 121 101	DW-C 15x 25	10 ^{+0.2}	29	50	65	ø7	3	15	15	25	30	-	0.05
01 101 017	DW-A 15x 40			01 121 102	DW-C 15x 40									40	45	-	0.07
01 101 018	DW-A 15x 60			01 121 103	DW-C 15x 60									60	65	40	0.11
01 101 019	DW-A 18x 30	6	12 ±0.3	01 121 104	DW-C 18x 30	13 ^{-0.2}	35	60	80	ø9	3.5	18	18	30	35	-	0.08
01 101 020	DW-A 18x 50			01 121 105	DW-C 18x 50									50	55	-	0.13
01 101 021	DW-A 18x 80			01 121 106	DW-C 18x 80									80	85	50	0.21
01 101 022	DW-A 27x 40	8	20 ±0.4	01 121 107	DW-C 27x 40	16 ^{+0.3}	49	80	105	ø11	4.5	25	27	40	45	-	0.21
01 101 023	DW-A 27x 60			01 121 108	DW-C 27x 60									60	65	-	0.31
01 101 024	DW-A 27x100			01 121 109	DW-C 27x100									100	105	60	0.52
01 101 025	DW-A 38x 60	10	25 ±0.4	01 121 110	DW-C 38x 60	20 ^{+0.2}	67	100	125	ø13	6	34	38	60	70	-	0.59
01 101 026	DW-A 38x 80			01 121 111	DW-C 38x 80									80	90	40	0.77
01 101 027	DW-A 38x120			01 121 112	DW-C 38x120									120	130	80	1.15
01 101 043	DW-A 45x 80	12	35 ±0.5	01 121 113	DW-C 45x 80	24 ^{+0.3}	81	115	145	13x27	9	41	45	80	90	-	1.10
01 101 044	DW-A 45x100			01 121 114	DW-C 45x100									100	110	58	1.35
01 101 045	DW-A 45x150			01 121 115	DW-C 45x150									150	160	90	2.00
01 101 046	DW-A 50x120	M12x40	40 ±0.5	01 121 116	DW-C 50x120	30 ^{+0.2}	88	130	170	17x27	12	45	50	120	130	60	1.90
01 101 047	DW-A 50x160			01 121 117	DW-C 50x160									160	170	70	2.50
01 101 048	DW-A 50x200			01 121 118	DW-C 50x200									200	210	70	3.10

Housing sizes 45 and 50 ROSTA blue painted.

List of torque and loads on page 1.5.

Further information to customized elements and installation examples as from page 1.14.



www.rosta.com

Rubber Suspension Units

DW-S 15 to 50		□C	E	G	H	I	O	Q	□S	L	L1 ±0.2	M	Weight [kg]
Art. No.	Type												
01 111 201	DW-S 15x 25	11 ^{+0.25}	29	50	65	ø7	3	15	15	25	30	-	0.06
01 111 202	DW-S 15x 40									40	45	-	0.09
01 111 203	DW-S 15x 60									60	65	40	0.13
01 111 204	DW-S 18x 30	12 ^{+0.25}	35	60	80	ø9	3,5	18	18	30	35	-	0.11
01 111 205	DW-S 18x 50									50	55	-	0.18
01 111 206	DW-S 18x 80									80	85	50	0.28
01 111 207	DW-S 27x 40	22 ^{+0.25}	49	80	105	ø11	4,5	25	27	40	45	-	0.23
01 111 208	DW-S 27x 60									60	65	-	0.33
01 111 209	DW-S 27x100									100	105	60	0.56
01 111 210	DW-S 38x 60	30 ^{+0.25}	67	100	125	ø13	6	34	38	60	70	-	0.66
01 111 211	DW-S 38x 80									80	90	40	0.87
01 111 212	DW-S 38x120									120	130	80	1.30
01 111 213	DW-S 45x 80	35 ^{+0.4}	81	115	145	13x27	9	41	45	80	90	-	1.26
01 111 214	DW-S 45x100									100	110	58	1.60
01 111 215	DW-S 45x150									150	160	90	2.30
01 111 216	DW-S 50x120	40 ^{+0.4}	88	130	170	17x27	12	45	50	120	130	60	2.20
01 111 217	DW-S 50x160									160	170	70	2.90
01 111 218	DW-S 50x200									200	210	70	3.60

Inner part steel electrodeposited galvanic zinc coating.

Housing sizes 45 and 50 ROSTA blue painted.

List of torque and loads on page 1.5.

Further information to customized elements and installation examples as from page 1.14.

Type DW-A 60 to 100

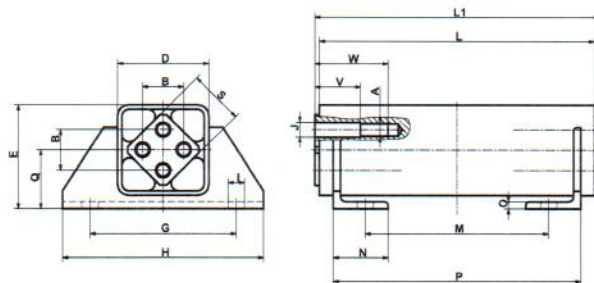
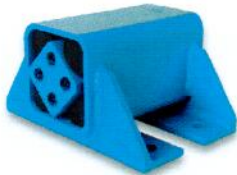

DW-A 60 to 100		A	B	D	E	G	H	øI	øJ	N	O	Q	□S	V	W	L	L1 ±0.2	M	P	Weight [kg]
01 101 031	DW-A 60x150													40	70	150	160	60	130	8.9
01 101 032	DW-A 60x200	M16	45	100	115	160	220	18	16.5	60	8	65	60	50	80	200	210	100	170	11.1
01 101 033	DW-A 60x300													50	80	300	310	200	270	15.9
01 101 034	DW-A 70x200															200	210	100	170	15.4
01 101 035	DW-A 70x300	M20	50	120	140	200	260	22	20.5	65	9	80	70	50	90	300	310	200	270	21.7
01 101 036	DW-A 70x400															400	410	300	370	28.2
01 101 037	DW-A 80x200															200	210	80	170	21.7
01 101 038	DW-A 80x300	M20	60	136	153	220	280	22	20.5	80	10	85	80	50	90	300	310	180	270	30.4
01 101 039	DW-A 80x400															400	410	280	370	39.4
01 101 040	DW-A 100x250															250	260	110	220	43.8
01 101 041	DW-A 100x400	M24	75	170	195	300	380	26	25	100	12	110	100	50	100	400	410	260	370	64.7
01 101 042	DW-A 100x500															500	510	360	470	78.7

List of torque and loads on page 1.5.

Further information to customized elements and installation examples as from page 1.14.