

Taper Bushes

Material: GG20.

Bores ISO E8, feather keyways in accordance with DIN 6885/1.
Screws included in delivery.

Shaft tolerance +0.05/-0.125 mm.

Can be used with or without parallel key, depending on the required torque.

Other bush sizes and bores available at short notice (some in stock).

Assembly instructions see page 824.

Ordering Details: e.g.: Product No. 622 501 10, Taper Bush 1008, 10 mm Bore

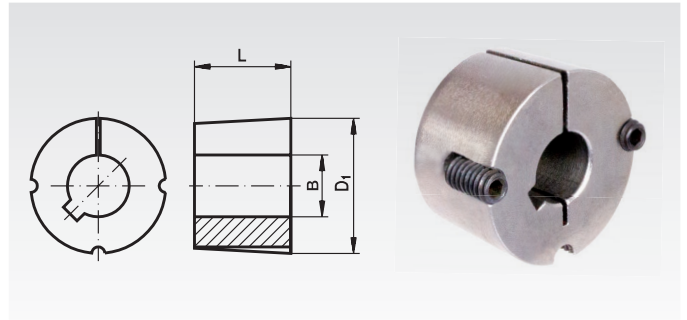

Product No.	Taper bush type	Bore B mm	Key-way mm	L mm	D ₁ mm	Weight g	Product No.	Taper bush type	Bore B mm	Key-way mm	L mm	D ₁ mm	Weight g
622 501 10	1008	10	3	22,3	35,0	160	622 504 12	1610	12	4	25,4	57,0	416
622 501 11	1008	11	4	22,3	35,0	140	622 504 14	1610	14	5	25,4	57,0	412
622 501 12	1008	12	4	22,3	35,0	120	622 504 15	1610	15	5	25,4	57,0	408
622 501 14	1008	14	5	22,3	35,0	118	622 504 16	1610	16	5	25,4	57,0	402
622 501 15	1008	15	5	22,3	35,0	116	622 504 18	1610	18	6	25,4	57,0	390
622 501 16	1008	16	5	22,3	35,0	112	622 504 19	1610	19	6	25,4	57,0	380
622 501 18	1008	18	6	22,3	35,0	100	622 504 20	1610	20	6	25,4	57,0	373
622 501 19	1008	19	6	22,3	35,0	98	622 504 22	1610	22	6	25,4	57,0	366
622 501 20	1008	20	6	22,3	35,0	94	622 504 24	1610	24	8	25,4	57,0	356
622 501 22	1008	22	6	22,3	35,0	80	622 504 25	1610	25	8	25,4	57,0	348
622 501 24 ¹⁾	1008	24	8 ¹⁾	22,3	35,0	70	622 504 28	1610	28	8	25,4	57,0	324
622 501 25 ¹⁾	1008	25	8 ¹⁾	22,3	35,0	68	622 504 30	1610	30	8	25,4	57,0	304
622 502 10	1108	10	3	22,3	38,0	180	622 504 32	1610	32	10	25,4	57,0	280
622 502 11	1108	11	4	22,3	38,0	165	622 504 35	1610	35	10	25,4	57,0	264
622 502 12	1108	12	4	22,3	38,0	154	622 504 38	1610	38	10	25,4	57,0	240
622 502 14	1108	14	5	22,3	38,0	148	622 504 40	1610	40	12	25,4	57,0	210
622 502 16	1108	16	5	22,3	38,0	140	622 504 42	1610	42	12	25,4	57,0	200
622 502 18	1108	18	6	22,3	38,0	132	622 508 20	1615	20	6	38,1	57,0	552
622 502 19	1108	19	6	22,3	38,0	126	622 508 22	1615	22	6	38,1	57,0	540
622 502 20	1108	20	6	22,3	38,0	122	622 508 24	1615	24	8	38,1	57,0	520
622 502 22	1108	22	6	22,3	38,0	112	622 508 25	1615	25	8	38,1	57,0	510
622 502 24	1108	24	8	22,3	38,0	96	622 508 30	1615	30	8	38,1	57,0	446
622 502 25	1108	25	8	22,3	38,0	92	622 508 32	1615	32	10	38,1	57,0	414
622 502 28 ¹⁾	1108	28	8 ¹⁾	22,3	38,0	88	622 508 35	1615	35	10	38,1	57,0	380
622 503 10	1210	10	3	25,4	47,0	282	622 508 38	1615	38	10	38,1	57,0	346
622 503 11	1210	11	4	25,4	47,0	280	622 508 40	1615	40	12	38,1	57,0	340
622 503 12	1210	12	4	25,4	47,0	278	622 508 42 ²⁾	1615	42	12 ²⁾	38,1	57,0	260
622 503 14	1210	14	5	25,4	47,0	274	622 505 12	2012	12	4	31,8	70,0	810
622 503 16	1210	16	5	25,4	47,0	262	622 505 14	2012	14	5	31,8	70,0	800
622 503 18	1210	18	6	25,4	47,0	250	622 505 15	2012	15	5	31,8	70,0	785
622 503 19	1210	19	6	25,4	47,0	244	622 505 16	2012	16	5	31,8	70,0	770
622 503 20	1210	20	6	25,4	47,0	240	622 505 18	2012	18	6	31,8	70,0	762
622 503 22	1210	22	6	25,4	47,0	224	622 505 19	2012	19	6	31,8	70,0	756
622 503 24	1210	24	8	25,4	47,0	208	622 505 20	2012	20	6	31,8	70,0	750
622 503 25	1210	25	8	25,4	47,0	208	622 505 22	2012	22	6	31,8	70,0	736
622 503 28	1210	28	8	25,4	47,0	184	622 505 24	2012	24	8	31,8	70,0	724
622 503 30	1210	30	8	25,4	47,0	168	622 505 25	2012	25	8	31,8	70,0	714
622 503 32	1210	32	10	25,4	47,0	160	622 505 28	2012	28	8	31,8	70,0	684
622 513 14	1215	14	5	38,1	47,0	380	622 505 30	2012	30	8	31,8	70,0	658
622 513 16	1215	16	5	38,1	47,0	370	622 505 32	2012	32	10	31,8	70,0	630
622 513 18	1215	18	6	38,1	47,0	350	622 505 35	2012	35	10	31,8	70,0	604
622 513 19	1215	19	6	38,1	47,0	340	622 505 38	2012	38	10	31,8	70,0	566
622 513 20	1215	20	6	38,1	47,0	335	622 505 40	2012	40	12	31,8	70,0	538
622 513 22	1215	22	6	38,1	47,0	320	622 505 42	2012	42	12	31,8	70,0	510
622 513 24	1215	24	8	38,1	47,0	290	622 505 45	2012	45	14	31,8	70,0	460
622 513 25	1215	25	8	38,1	47,0	285	622 505 48	2012	48	14	31,8	70,0	404
622 513 28	1215	28	8	38,1	47,0	260	622 505 50	2012	50	14	31,8	70,0	372
622 513 30	1215	30	8	38,1	47,0	230							
622 513 32	1215	32	10	38,1	47,0	200							

¹⁾ With flat keyway 1.3mm.

²⁾ With flat keyway 2.2mm.

Taper Bushes

Material: GG20.

Bores ISO E8, feather keyways in accordance with DIN 6885/1.
Screws included in delivery.

Shaft tolerance +0.05/-0.125 mm.

Can be used with or without parallel key, depending on the required torque.

Other bush sizes and bores available at short notice (some in stock).

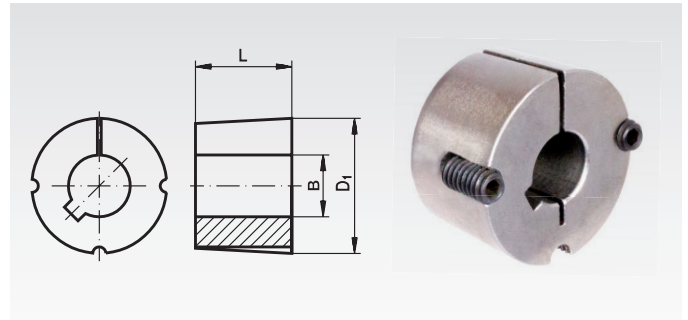

Ordering Details: e.g.: Product No. 622 506 16, Taper Bush 2517, 16 mm Bore

Product No.	Taper bush type	Bore B mm	Key-way mm	L mm	D ₁ mm	Weight g	Product No.	Taper bush type	Bore B mm	Key-way mm	L mm	D ₁ mm	Weight g
622 506 16	2517	16	5	44,5	85,0	1800	622 511 40	3030	40	12	76,2	108,0	3820
622 506 18	2517	18	6	44,5	85,0	1700	622 511 45	3030	45	14	76,2	108,0	3550
622 506 19	2517	19	6	44,5	85,0	1620	622 511 50	3030	50	14	76,2	108,0	3420
622 506 20	2517	20	6	44,5	85,0	1602	622 511 60	3030	60	18	76,2	108,0	2950
622 506 22	2517	22	6	44,5	85,0	1568	622 511 65	3030	65	18	76,2	108,0	2680
622 506 24	2517	24	8	44,5	85,0	1566	622 511 70	3030	70	20	76,2	108,0	2060
622 506 25	2517	25	8	44,5	85,0	1556	622 511 75	3030	75	20	76,2	108,0	1640
622 506 28	2517	28	8	44,5	85,0	1520	622 509 35	3525	35	10	64,9	127,0	4910
622 506 30	2517	30	8	44,5	85,0	1488	622 509 38	3525	38	10	64,9	127,0	4850
622 506 32	2517	32	10	44,5	85,0	1450	622 509 40	3525	40	12	64,9	127,0	4800
622 506 35	2517	35	10	44,5	85,0	1396	622 509 50	3525	50	14	64,9	127,0	4440
622 506 38	2517	38	10	44,5	85,0	1346	622 509 60	3525	60	18	64,9	127,0	4050
622 506 40	2517	40	12	44,5	85,0	1316	622 509 75	3525	75	20	64,9	127,0	3370
622 506 42	2517	42	12	44,5	85,0	1274	622 509 80	3525	80	22	64,9	127,0	3050
622 506 45	2517	45	14	44,5	85,0	1204	622 510 50	3535	50	14	88,9	127,0	6050
622 506 48	2517	48	14	44,5	85,0	1126	622 510 55	3535	55	16	88,9	127,0	5810
622 506 50	2517	50	14	44,5	85,0	1080	622 510 60	3535	60	18	88,9	127,0	5500
622 506 55	2517	55	16	44,5	85,0	958	622 510 65	3535	65	18	88,9	127,0	5200
622 506 60	2517	60	18	44,5	85,0	810	622 510 70	3535	70	20	88,9	127,0	4880
622 506 65 ¹⁾	2517	65	18 ¹⁾	44,5	85,0	650	622 510 75	3535	75	20	88,9	127,0	4460
622 507 25	3020	25	8	50,8	108,0	2910	622 510 80	3535	80	22	88,9	127,0	4080
622 507 28	3020	28	8	50,8	108,0	2790	622 510 90	3535	90	25	88,9	127,0	3210
622 507 30	3020	30	8	50,8	108,0	2840							
622 507 32	3020	32	10	50,8	108,0	2800							
622 507 35	3020	35	10	50,8	108,0	2745							
622 507 38	3020	38	10	50,8	108,0	2700							
622 507 40	3020	40	12	50,8	108,0	2635							
622 507 42	3020	42	12	50,8	108,0	2594							
622 507 45	3020	45	14	50,8	108,0	2515							
622 507 48	3020	48	14	50,8	108,0	2425							
622 507 50	3020	50	14	50,8	108,0	2370							
622 507 55	3020	55	16	50,8	108,0	2234							
622 507 60	3020	60	18	50,8	108,0	2000							
622 507 65	3020	65	18	50,8	108,0	1888							
622 507 70	3020	70	20	50,8	108,0	1700							
622 507 75	3020	75	20	50,8	108,0	1485							

¹⁾ With flat keyway 3.3mm.

Other bush sizes on request.

*Assembly Instructions
Page 824*

Spare screws for Taper Bushes

Material: Steel.

Supply: One screw (order quantity as needed).

Taper bushes have two or (from size 3030) three screws depending on size.

Ordering Details: e.g.: Product No. 622 501 99, Spare Screw, Taper Bush 1008 and 1108

Product No.	to match Taper bush	Size inch	Screw type	Tightening Torque Nm	Weight g
622 501 99	1008 and 1108	1/4"	Set screw with internal hexagon	5.6	1.9
622 503 99	1210 to 1615	3/8"	Set screw with internal hexagon	20	5.2
622 505 99	2012 and 2017	7/16"	Set screw with internal hexagon	30	11
622 506 99	2517 and 2525	1/2"	Set screw with internal hexagon	50	16.4
622 507 99	3020 and 3030	5/8"	Set screw with internal hexagon	90	33.2
622 510 99	3525 and 3535	1/2"	Screw with internal hexagon	90	49.7

Welding Hubs for Taper Bushes

Material: Steel (St52 or comparable), good weldable.

Hub for fixing a chain plate wheel or similar parts with a low priced taper bush onto a shaft.
Taper bush and chain plate wheel have to be ordered separately.
Recommended bore tolerance: H8.

Before welding, a taper bush should be mounted with a piece of shaft into the welding hub to avoid deforming by heat.

Other sizes for taper bushes up to type 5050 are available at short delivery time.

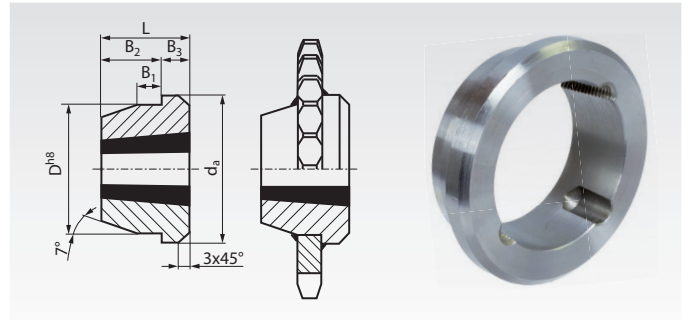

Ordering Details: e.g.: Product No. 140 901 01, Welding Hub for Taper Bush 1210

Product No.	For Taper Bush Type	d _a mm	D ^{h8} mm	B ₁ mm	B ₂ mm	B ₃ mm	L mm	Weight kg
140 901 01	1210	73	60	10	16	9	25	0,31
140 901 02	1215	76	60	11	22	16	38	0,50
140 901 03	1610	83	70	10	16	9	25	0,37
140 901 04	1615	83	70	11	22	16	38	0,60
140 901 05	2012	96	90	12	22	10	32	0,72
140 901 06	2517	127	110	13	26	19	45	1,8
140 901 07	3020	152	130	18	27	24	51	2,6
140 901 08	3030	152	130	19	51	25	76	3,6
140 901 09	3525	184	155	25	40	25	65	7,3
140 901 10	3535	184	155	25	57	32	89	6,4



Taper Bushes page 76