



# Ammeraal Beltech Modular

Innovative belt and chain solutions  
for every industry & application



# Content

uni 3200	page 3 - 4
uni 821 PRR	page 5 - 6
uni 821 PRR4	page 7 - 8
uni 821 RO	page 9 - 10
uni 879 Tab R G4	page 11 - 12
uni 879 Tab Safety	page 13 - 14
uni 879 Tab Safety Finger	page 15 - 16
uni 880 Rib Flex	page 17 - 18
uni 880 Rib	page 19 - 20
uni 882 Tab PRR	page 21 - 22
uni 882 Tab PRR4	page 23 - 24
uni 882 Rib Flex	page 25 - 26
uni 882 Tab SC	page 27 - 28
uni 982 SC	page 29 - 30
uni NH78	page 31 - 32



# Special Plastic Chain

Series **uni 3200** Type -

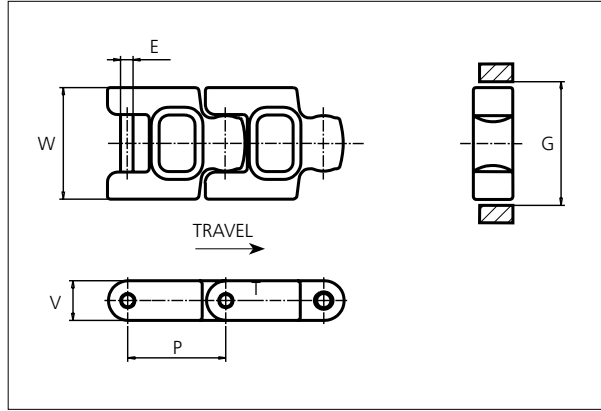

**Special Plastic Chain**  
 Straight running chain  
 Pitch: 50.8 mm (2.00 in)  
 Backflex radius: 60.0 mm (2.40 in)  
 Permissible tensile strength:  
 POM material: 3150 N (708 lbf)  
  
 Delivery: 6.1 m (20.0 ft)  
 No. of links/box: 120

STANDARD

E		G		P		V	
mm	in	mm	in	mm	in	mm	in
6.4	0.25	59.5	2.34	50.8	2.00	20.3	0.80

All dimensions are for chains in POM material.

Width (W)		Material & color	Pin material	Weight	
mm	in			kg/m	lb/ft
57.2	2.25	POM-DI <b>G</b>	<b>SS304</b>	57.2	2.25

Non standard material and color: See uni Material and Color Overview.  
 Non standard pin material: See uni Material and Color Overview.

STRAIGHT RUNNING

PITCH 50.8 MM/2.00 IN



## Sprocket

No of teeth	Pitch diameter		Overall-diameter		Min. ø bore		Max. ø bore		Hub-diameter		A-dimension		B-dimension		Molded PA66 LG	Machined PA66 
	mm	in	mm	in	mm	in	mm	in	mm	in	mm	in	mm	in		
<b>Z8</b>	132.9	5.23	134.0	5.30	19.1	0.80	40.0	1.60	65.0	2.60	51.2	2.00	79.6	3.10		x
<b>Z10</b>	164.5	6.48	160.0	6.30	19.1	0.80	40.0	1.60	65.0	2.60	68.0	2.70	92.4	3.60		x
<b>Z10</b>	164.5	6.48	160.0	6.30	40.0	1.60	70.0	2.80	120.0	4.70	68.0	2.70	92.4	3.60		x
<b>Z12</b>	194.4	7.65	204.0	8.00	19.1	0.80	40.0	1.60	65.0	2.60	84.7	3.30	108.4	4.30		x
<b>Z12</b>	194.4	7.65	204.0	8.00	40.0	1.60	70.0	2.80	120.0	4.70	84.7	3.30	108.4	4.30		x
<b>Z15</b>	244.4	9.62	250.0	9.80	19.1	0.80	40.0	1.60	65.0	2.60	109.4	4.30	132.4	5.20		x
<b>Z15</b>	244.4	9.62	250.0	9.80	40.0	1.60	70.0	2.80	120.0	4.70	109.4	4.30	132.4	5.20		x

Non standard material and color:  
See uni Material and Color Overview.

### Machined sprocket

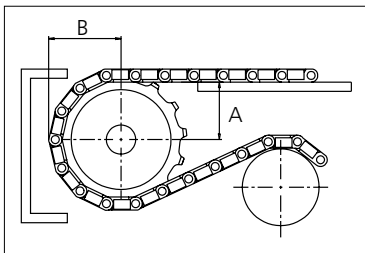

Please ensure that sufficient size shaft and keyway are chosen for corresponding load.

Other sprocket sizes are available upon request  
Width of tooth: 25.0 mm/1.00 in  
Width of sprocket: 42.3 mm/1.70 in  
uni Retainer Rings: See uni Retainer Ring data sheet

uni 3200/1304



*Solid advice*  
For all your belting needs  
Local stock & service  
[www.ammeraalbeltech.com](http://www.ammeraalbeltech.com)

**Ammeraal Beltech Modular A/S**  
Hjulmagervej 21  
DK-7100 Vejle

T +45 7572 3100  
F +45 7572 3348  
admin@unichains.com  
www.unichains.com

This information is subject to alteration due to continuous development. Ammeraal Beltech will not be held liable for the incorrect use of the above stated information. This information replaces previous information. All activities performed and services rendered by Ammeraal Beltech are subject to general terms and conditions of sale and delivery, as applied by its operating companies.



# Special Plastic Chain

Series **uni 821** Type **PRR**

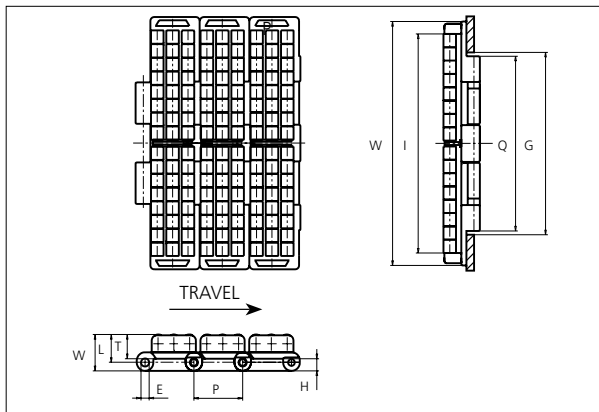

**Special Plastic Chain**  
 Straight running chain  
 Pitch: 38.1 mm (1.50 in)  
 Backflex radius: 225.0 mm (8.90 in)  
 Permissible tensile strength:  
 POM material: 3000 N (674 lbf)  
 Delivery: 3.05 m (10 ft)  
 No. of links/box: 80  
 Axle materials for  $\varnothing 5.0$  mm (0.20 in) accumulation rollers:  
 See uni Material and Color Overview.

STANDARD

E		G		H		I (K750)		I (K1000)		I (K1200)		L		P		Q		T		V	
mm	in	mm	in	mm	in	mm	in	mm	in	mm	in	mm	in	mm	in	mm	in	mm	in	mm	in
6.4	0.25	140.0	5.51	9.5	0.37	174.5	6.87	238.0	9.37	288.8	11.37	22.2	0.87	38.1	1.50	136.5	5.37	19.0	0.75	28.5	1.12

All dimensions are for chains in POM material.

	Width (W)		Base material & color	Roller material & color	Pin material	Weight	
	mm	in				kg/m	lb/ft
<b>K750</b>	190.5	7.50	POM-LF <b>BR</b>	POM-LF <b>BR</b>	<b>SS304</b>	5.1	3.43
<b>K1000</b>	254.0	10.00	-	-	-	-	-
<b>K1200</b>	304.8	12.00	POM-LF <b>BR</b>	POM-LF <b>BR</b>	<b>SS304</b>	8.3	5.58

Non standard material and color: See uni Material and Color Overview.  
 Non standard pin material: See uni Material and Color Overview.

STRAIGHT RUNNING

PITCH 38.1 MM/1.50 IN



## Sprocket

No. of teeth	Pitch diameter		Overall diameter		Min. $\phi$ bore		Max. $\phi$ bore		Hub diameter		Dimension A		Dimension B		Molded PA6 LG	Molded Cast Iron	Machined PA6
	mm	in	mm	in	mm	in	mm	in	mm	in	mm	in	mm	in			
Z19	117.3	4.62	117.0	4.61	20.0	0.79	70.0	2.76	0	0	58.7	2.31	64.5	2.54		x	x
Z21	129.2	5.09	130.0	5.12	20.0	0.79	70.0	2.76	0	0	65.0	2.56	70.5	2.78		x	x
Z23	141.2	5.56	142.0	5.59	20.0	0.79	70.0	2.76	0	0	71.2	2.80	76.5	3.01		x	x
Z25	153.2	6.03	155.0	6.10	20.0	0.79	70.0	2.76	0	0	77.4	3.05	82.5	3.25		x	x
Z27	165.2	6.50	167.0	6.57	20.0	0.79	100.0	3.93	0	0	83.6	3.29	88.5	3.48		x	x
Z29	177.2	6.98	179.0	7.05	20.0	0.79	110.0	4.33	0	0	89.8	3.54	94.6	3.72		x	x
Z31	189.3	7.45	192.0	7.56	20.0	0.79	120.0	4.72	0	0	95.9	3.78	100.6	3.96		x	x

## Two part sprocket

No. of teeth	Pitch diameter		Overall diameter		Min. $\phi$ bore		Max. $\phi$ bore		Hub diameter		Dimension A		Dimension B		Molded PA6 LG	Molded Cast Iron	Machined PA6
	mm	in	mm	in	mm	in	mm	in	mm	in	mm	in	mm	in			
Z25	153.2	6.03	155.0	6.10	30.0	1.18	40.0	1.57	58.0	2.28	77.4	3.05	82.5	3.25	x		

Non standard material and color:  
See uni Material and Color Overview.

Cast iron sprocket



Machined sprocket



Molded two part sprocket

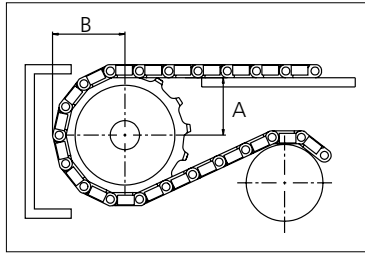

Please ensure that sufficient size shaft and keyway are chosen for corresponding load.

Other sprocket sizes are available upon request

Width of tooth: 79.4 mm/3.13 in

Width of sprocket: 79.4 mm/3.13 in

uni Retainer Rings: See uni Retainer Ring data sheet

uni Idler: See uni Idler data sheet

uni Guide Rings can be mounted on cast iron and machined sprockets. See uni Guide Rings data sheet

uni 821 PRR/150908



Conveyor Belts



Seamless Belts

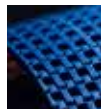

Modular Belts



Timing Belts



Transmission Belts



Fabrication & service

Expert advice, quality solutions and local service for all your belting needs  
[www.ammeraalbeltech.com](http://www.ammeraalbeltech.com)

**Ammeraal Beltech Modular A/S**  
Hjulmagervej 21  
DK-7100 Vejle

T +45 7572 3100  
F +45 7572 3348  
admin@unichains.com  
www.unichains.com

This information is subject to alteration due to continuous development. Ammeraal Beltech will not be held liable for the incorrect use of the above stated information. This information replaces previous information. All activities performed and services rendered by Ammeraal Beltech are subject to general terms and conditions of sale and delivery, as applied by its operating companies.



# Special Plastic Chain

Series **uni 821** Type **PRR4**

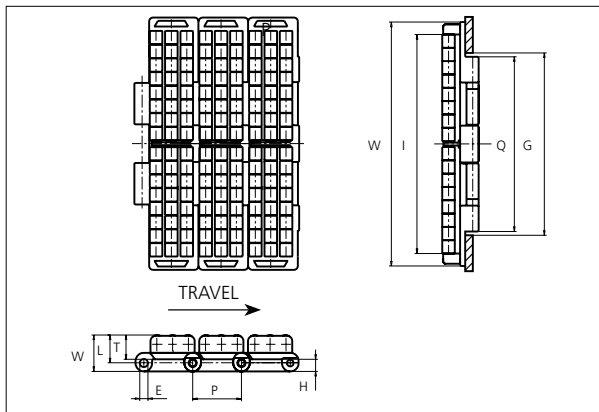

**Special Plastic Chain**  
 Straight running chain  
 Pitch: 38.1 mm (1.50 in)  
 Backflex radius: 225.0 mm (8.90 in)  
 Permissible tensile strength:  
 POM material: 3000 N (674 lbf)  
 Delivery: 3.05 m (10 ft)  
 No. of links/box: 80  
 Axle materials for  $\varnothing 5.0$  mm (0.20 in) accumulation rollers: See uni Material and Color Overview.  
 Overview.

NON STANDARD

E		G		H		I (K750)		I (K1000)		I (K1200)		L		P		Q		T		V	
mm	in	mm	in	mm	in	mm	in	mm	in	mm	in	mm	in	mm	in	mm	in	mm	in	mm	in
6.4	0.25	140.0	5.51	9.5	0.37	174.5	6.87	238.0	9.37	288.8	11.37	22.2	0.87	38.1	1.50	136.5	5.37	19.0	0.75	28.5	1.12

All dimensions are for chains in POM material.

	Width (W)		Recommended base material & color	Recommended roller material & color	Recommended pin material	Weight	
	mm	in				kg/m	lb/ft
<b>K750</b>	190.5	7.50	POM-LF <b>BR</b>	POM-D <b>K</b>	<b>SS304</b>	6.9	4.64
<b>K1000</b>	254.0	10.00	POM-LF <b>BR</b>	POM-D <b>K</b>	<b>SS304</b>	8.8	5.91
<b>K1200</b>	304.8	12.00	POM-LF <b>BR</b>	POM-D <b>K</b>	<b>SS304</b>	10.2	6.85

Non standard material and color: See uni Material and Color Overview.

Non standard pin material: See uni Material and Color Overview.

STRAIGHT RUNNING

PITCH 38.1 MM/1.50 IN



## Sprocket

No. of teeth	Pitch diameter		Overall diameter		Min. $\phi$ bore		Max. $\phi$ bore		Hub diameter		Dimension A		Dimension B		Molded PA6 LG	Molded Cast Iron	Machined PA6
	mm	in	mm	in	mm	in	mm	in	mm	in	mm	in	mm	in			
<b>Z19</b>	117.3	4.62	117.0	4.61	20.0	0.79	70.0	2.76	0	0	58.7	2.31	64.5	2.54		x	x
<b>Z21</b>	129.2	5.09	130.0	5.12	20.0	0.79	70.0	2.76	0	0	65.0	2.56	70.5	2.78		x	x
<b>Z23</b>	141.2	5.56	142.0	5.59	20.0	0.79	70.0	2.76	0	0	71.2	2.80	76.5	3.01		x	x
<b>Z25</b>	153.2	6.03	155.0	6.10	20.0	0.79	70.0	2.76	0	0	77.4	3.05	82.5	3.25		x	x
<b>Z27</b>	165.2	6.50	167.0	6.57	20.0	0.79	100.0	3.93	0	0	83.6	3.29	88.5	3.48		x	x
<b>Z29</b>	177.2	6.98	179.0	7.05	20.0	0.79	110.0	4.33	0	0	89.8	3.54	94.6	3.72		x	x
<b>Z31</b>	189.3	7.45	192.0	7.56	20.0	0.79	120.0	4.72	0	0	95.9	3.78	100.6	3.96		x	x

## Two part sprocket

No. of teeth	Pitch diameter		Overall diameter		Min. $\phi$ bore		Max. $\phi$ bore		Hub diameter		Dimension A		Dimension B		Molded PA6 LG	Molded Cast Iron	Machined PA6
	mm	in	mm	in	mm	in	mm	in	mm	in	mm	in	mm	in			
<b>Z25</b>	153.2	6.03	155.0	6.10	30.0	1.18	40.0	1.57	58.0	2.28	77.4	3.05	82.5	3.25	x		

Non standard material and color:  
See uni Material and Color Overview.

### Cast iron sprocket



### Machined sprocket



### Molded two part sprocket

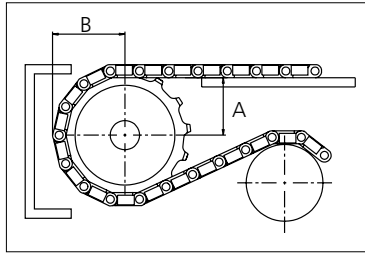

Please ensure that sufficient size shaft and keyway are chosen for corresponding load.

Other sprocket sizes are available upon request

Width of tooth: 79.4 mm/3.13 in

Width of sprocket: 79.4 mm/3.13 in

uni Retainer Rings: See uni Retainer Ring data sheet

uni Idler: See uni Idler data sheet

uni Guide Rings can be mounted on cast iron and machined sprockets. See uni Guide Rings data sheet

uni 821 PRR4/150908



Conveyor Belts



Seamless Belts

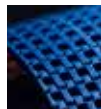

Modular Belts



Timing Belts

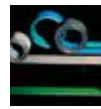

Transmission Belts



Fabrication & service

Expert advice, quality solutions and local service for all your belting needs  
[www.ammeraalbeltech.com](http://www.ammeraalbeltech.com)

**Ammeraal Beltech Modular A/S**  
Hjulmagervej 21  
DK-7100 Vejle

T +45 7572 3100  
F +45 7572 3348  
admin@unichains.com  
www.unichains.com

This information is subject to alteration due to continuous development. Ammeraal Beltech will not be held liable for the incorrect use of the above stated information. This information replaces previous information. All activities performed and services rendered by Ammeraal Beltech are subject to general terms and conditions of sale and delivery, as applied by its operating companies.





# Special Plastic Chain

Series **uni 821** Type **RO**

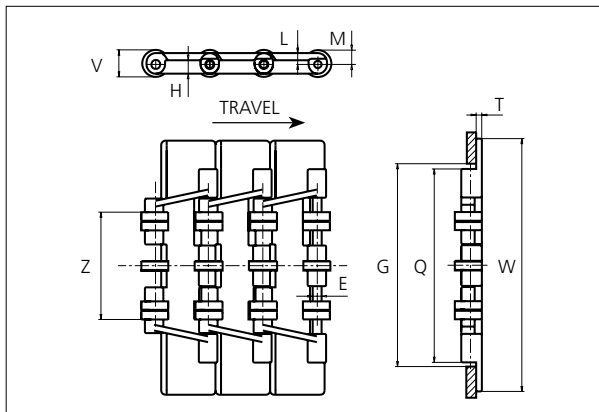
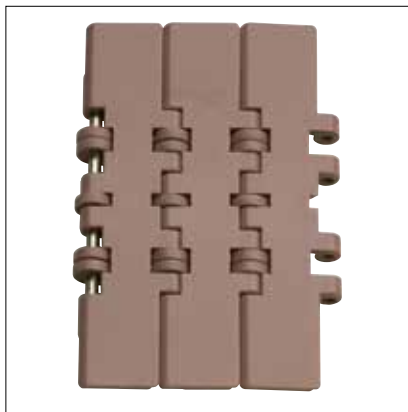

**Special Plastic Chain**  
 Straight running chain  
 Pitch: 38.1 mm (1.50 in)  
 Backflex radius: 75.0 mm (3.00 in)  
 Permissible tensile strength:  
 POM material: 2500 N (562 lbf)  
  
 Delivery: 3.048 m (10 ft)  
 No. of links/box: 80

NON STANDARD

E		G		H		L		M		P		Q		T		V		Z	
mm	in	mm	in	mm	in	mm	in	mm	in	mm	in	mm	in	mm	in	mm	in	mm	in
6.4	0.25	140.0	5.51	9.5	0.37	8.0	0.31	9.5	0.37	38.1	1.50	136.5	5.37	5.0	0.20	19.0	0.75	75.0	2.95

All dimensions are for chains in POM material.

	Width (W)		Recommended material & color	Recommended roller material & color	Recommended pin material	Weight	
	mm	in				kg/m	lb/ft
<b>K750</b>	190.5	7.50	POM-LF <b>BR</b>	POM-LF <b>BR</b>	<b>SS304</b>	2.6	1.75

Non standard material and color: See uni Material and Color Overview.

Non standard pin material: See uni Material and Color Overview.

STRAIGHT RUNNING

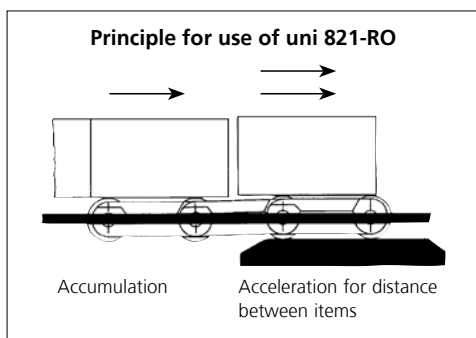

PITCH 38.1 MM/1.50 IN



## Sprocket

No. of teeth	Pitch diameter		Overall diameter		Min. ø bore		Max. ø bore		Hub diameter		A-dimension		B-dimension		Molded PA66 LG	Molded Cast Iron	Machined PA66
	mm	in	mm	in	mm	in	mm	in	mm	in	mm	in	mm	in			
<b>Z21</b>	129.2	5.09	130.0	5.12	18.0	0.71	70.0	2.76	0	0	65.0	2.56	71.8	2.83			x

### Molded sprocket

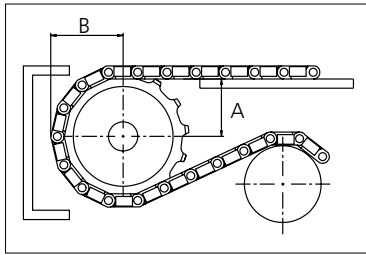

**Please ensure that sufficient size shaft and keyway are chosen for corresponding load.**

Non standard material and color:  
See uni Material and Color Overview.

Other sprocket sizes are available upon request  
Width of tooth: 13.8 mm/0.54 in  
Width of sprocket: 135.0 mm/5.30 in  
uni Retainer Rings: See uni Retainer Ring data sheet

uni 821 RO/150817



Expert advice, quality solutions and local service for all your belting needs  
[www.ammeraalbeltech.com](http://www.ammeraalbeltech.com)

**Ammeraal Beltech Modular A/S**  
Hjulmagervej 21  
DK-7100 Vejle

T +45 7572 3100  
F +45 7572 3348  
admin@unichains.com  
www.unichains.com

This information is subject to alteration due to continuous development. Ammeraal Beltech will not be held liable for the incorrect use of the above stated information. This information replaces previous information. All activities performed and services rendered by Ammeraal Beltech are subject to general terms and conditions of sale and delivery, as applied by its operating companies.



# Special Plastic Chain

Series **uni 879** Type **Tab R G4**

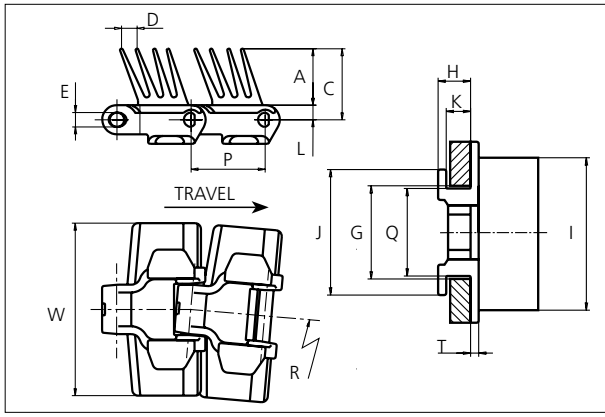

**Special Plastic Chain**  
 Side flexing chain  
 Pitch: 38.1 mm (1.50 in)  
 Backflex radius: 200 mm (7.87 in)  
 Permissible tensile strength:  
 POM material: 2250 N (506 lbf)  
  
 Delivery: 3.05 m (10 ft)  
 No. of links/box: 80

STANDARD

A		C		D		E		G		H		I		J		K		L		P		Q		T	
mm	in	mm	in	mm	in	mm	in	mm	in	mm	in	mm	in	mm	in	mm	in	mm	in	mm	in	mm	in	mm	in
29.0	1.14	37.5	1.48	9.0	0.36	7.1	0.28	44.5	1.75	15.9	0.63	75.0	2.95	61.5	2.42	11.9	0.47	8.5	0.33	38.1	1.50	42.9	1.69	5.0	0.20

All dimensions are for chains in POM material.

	Width (W)		Recommended material & color	Pin material	Weight		Min. radius (R)	
	mm	in			kg/m	lb/ft	mm	in
<b>K325</b>	82.6	3.25	POM-LF <b>BR</b> 04 <b>K</b>	<b>SS304</b>	1.3	0.87	200	7.87

Non standard material and color. See uni Material and Color Overview.  
 Non standard pin material: See uni Material and Color Overview.

SIDE FLEXING

PITCH 38.1 MM/1.50 IN



## Sprocket

No. of teeth	Pitch diameter		Overall diameter		Min. $\phi$ bore		Max. $\phi$ bore		Hub diameter		Dimension A		Dimension B		Molded PA66 LG	Molded Cast Iron	Machined PA66
	mm	in	mm	in	mm	in	mm	in	mm	in	mm	in	mm	in			
<b>Z9</b>	111.4	4.39	109.7	4.32	20.0	0.80	40.0	1.60	70.0	2.76	55.9	2.20	63.2	2.49	x	x	
<b>Z10</b>	123.3	4.85	122.3	4.81	20.0	0.80	40.0	1.60	70.0	2.76	62.2	2.45	69.2	2.72	x	x	
<b>Z11</b>	135.2	5.32	134.8	5.31	20.0	0.80	40.0	1.60	70.0	2.76	68.4	2.69	75.1	2.96	x	x	
<b>Z12</b>	147.2	5.80	147.2	5.80	20.0	0.80	40.0	1.60	70.0	2.76	74.6	2.94	81.1	3.19	x	x	
<b>Z15</b>	183.3	7.22	184.3	7.26	20.0	0.80	40.0	1.60	70.0	2.76	93.2	3.67	99.2	3.91	x	x	

## Two part sprocket

No. of teeth	Pitch diameter		Overall diameter		Min. $\phi$ bore		Max. $\phi$ bore		Hub diameter		Dimension A		Dimension B		Molded PA66 LG	Molded Cast Iron	Machined PA66
	mm	in	mm	in	mm	in	mm	in	mm	in	mm	in	mm	in			
<b>Z9</b>	111.4	4.39	109.7	4.32	20.0	0.80	40.0	1.60	70.0	2.76	55.9	2.20	63.2	2.49	x		
<b>Z10</b>	123.3	4.85	122.3	4.81	20.0	0.80	40.0	1.60	70.0	2.76	62.2	2.45	69.2	2.72	x		
<b>Z11</b>	135.2	5.32	134.8	5.31	20.0	0.80	40.0	1.60	70.0	2.76	68.4	2.69	75.1	2.96	x		
<b>Z12</b>	147.2	5.80	147.2	5.80	20.0	0.80	40.0	1.60	70.0	2.76	74.6	2.94	81.1	3.19	x		

### Molded sprocket



### Cast iron sprocket



### Molded two part sprocket

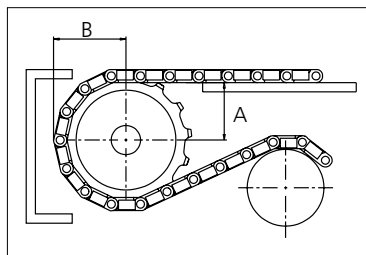

Please ensure that sufficient size shaft and keyway are chosen for corresponding load.

Non standard material and color:  
See uni Material and Color Overview.

Other sprocket sizes are available upon request

Width of tooth: 15.8 mm/0.62 in

Width of sprocket: 42.3 mm/1.67 in

uni Retainer Rings: See uni Retainer Ring data sheet

uni Idler: See uni Idler data sheet



Conveyor Belts



Seamless Belts

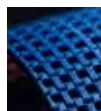

Modular Belts



Timing Belts



Transmission Belts



Fabrication & service

Expert advice, quality solutions and local service for all your belting needs  
[www.ammeraalbeltech.com](http://www.ammeraalbeltech.com)

**Ammeraal Beltech Modular A/S**  
Hjulmagervej 21  
DK-7100 Vejle

T +45 7572 3100  
F +45 7572 3348  
admin@unichains.com  
www.unichains.com

This information is subject to alteration due to continuous development. Ammeraal Beltech will not be held liable for the incorrect use of the above stated information. This information replaces previous information. All activities performed and services rendered by Ammeraal Beltech are subject to general terms and conditions of sale and delivery, as applied by its operating companies.



# Special Plastic Chain

Series **uni 879** Type **Tab Safety**

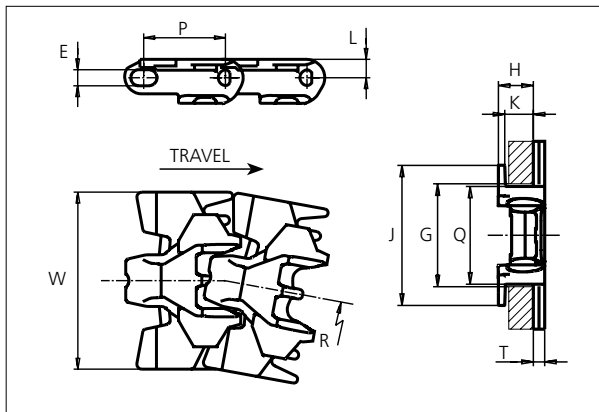
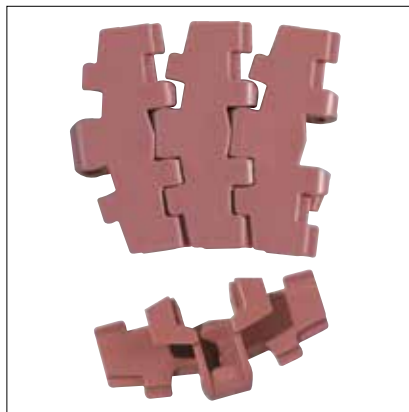

**Special Plastic Chain**  
 Side flexing chain  
 Pitch: 38.1 mm (1.50 in)  
 Backflex radius: 75.0 mm (3.00 in)  
 Permissible tensile strength:  
 POM material: 2250 N (506 lbf)  
  
 Delivery: 3.05 m (10 ft)  
 No. of links/box: 80

E		G		H		J		K		L		P		Q		T	
mm	in	mm	in	mm	in	mm	in	mm	in	mm	in	mm	in	mm	in	mm	in
7.1	0.28	44.5	1.75	15.9	0.63	61.5	2.42	11.9	0.47	8.5	0.33	38.1	1.50	43.1	1.70	5.0	0.20

All dimensions are for chains in POM material.

	Width (W)		Material & color	Pin material	Weight		Min. radius (R)	
	mm	in			kg/m	lb/ft	mm	in
<b>K325</b>	82.6	3.25	POM-LFI <b>BR</b>	<b>SS304</b>	1.0	0.67	200	7.87
<b>K450</b>	114.3	4.50	-	-	-	-	-	-

Non standard material and color: See uni Material and Color Overview.  
 Non standard pin material: See uni Material and Color Overview.

STANDARD

SIDE FLEXING

PITCH 38.1 MM/1.50 IN



## Sprocket

No. of teeth	Pitch diameter		Overall diameter		Min. $\phi$ bore		Max. $\phi$ bore		Hub diameter		Dimension A		Dimension B		Molded PA66 LG	Molded Cast Iron	Machined PA66
	mm	in	mm	in	mm	in	mm	in	mm	in	mm	in	mm	in			
Z9	111.4	4.39	109.7	4.32	20.0	0.80	40.0	1.60	70.0	2.76	55.9	2.20	63.2	2.49	x	x	
Z10	123.3	4.85	122.3	4.81	20.0	0.80	40.0	1.60	70.0	2.76	62.2	2.45	69.2	2.72	x	x	
Z11	135.2	5.32	134.8	5.31	20.0	0.80	40.0	1.60	70.0	2.76	68.4	2.69	75.1	2.96	x	x	
Z12	147.2	5.80	147.2	5.80	20.0	0.80	40.0	1.60	70.0	2.76	74.6	2.94	81.1	3.19	x	x	
Z15	183.3	7.22	184.3	7.26	20.0	0.80	40.0	1.60	70.0	2.76	93.2	3.67	99.2	3.91	x	x	

## Two part sprocket

No. of teeth	Pitch diameter		Overall diameter		Min. $\phi$ bore		Max. $\phi$ bore		Hub diameter		Dimension A		Dimension B		Molded PA66 LG	Molded Cast Iron	Machined PA66
	mm	in	mm	in	mm	in	mm	in	mm	in	mm	in	mm	in			
Z9	111.4	4.39	109.7	4.32	20.0	0.80	40.0	1.60	70.0	2.76	55.9	2.20	63.2	2.49	x		
Z10	123.3	4.85	122.3	4.81	20.0	0.80	40.0	1.60	70.0	2.76	62.2	2.45	69.2	2.72	x		
Z11	135.2	5.32	134.8	5.31	20.0	0.80	40.0	1.60	70.0	2.76	68.4	2.69	75.1	2.96	x		
Z12	147.2	5.80	147.2	5.80	20.0	0.80	40.0	1.60	70.0	2.76	74.6	2.94	81.1	3.19	x		

Non standard material and color:  
See uni Material and Color Overview.

### Molded sprocket



### Cast iron sprocket



### Molded two part sprocket

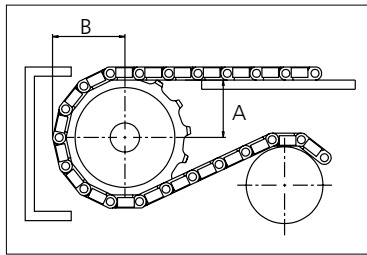

Please ensure that sufficient size shaft and keyway are chosen for corresponding load.

Other sprocket sizes are available upon request

Width of tooth: 15.8 mm/0.62 in

Width of sprocket: 42.3 mm/1.67 in

uni Retainer Rings: See uni Retainer Ring data sheet

uni Idler: See uni Idler data sheet



Conveyor Belts



Seamless Belts



Modular Belts



Timing Belts

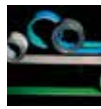

Transmission Belts



Fabrication & service

Solid advice  
For all your belting needs  
Local stock & service  
[www.ammeraalbeltech.com](http://www.ammeraalbeltech.com)

**Ammeraal Beltech Modular A/S**  
Hjulmagervej 21  
DK-7100 Vejle

T +45 7572 3100  
F +45 7572 3348  
admin@unichains.com  
www.unichains.com

This information is subject to alteration due to continuous development. Ammeraal Beltech will not be held liable for the incorrect use of the above stated information. This information replaces previous information. All activities performed and services rendered by Ammeraal Beltech are subject to general terms and conditions of sale and delivery, as applied by its operating companies.



# Special Plastic Chain

Series **uni 879** Type **Tab Safety Finger**

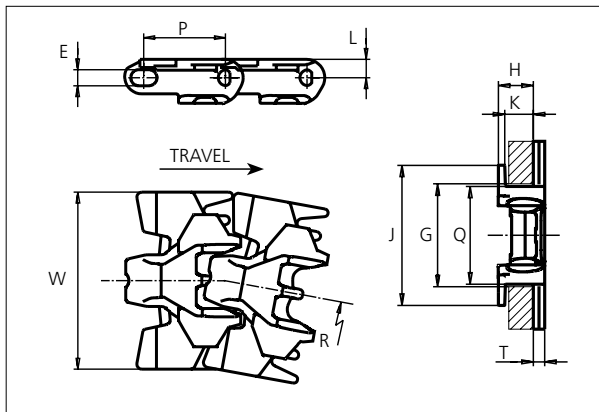

**Special Plastic Chain**  
 Side flexing chain  
 Pitch: 38.1 mm (1.50 in)  
 Backflex radius: 90 mm (3.50 in)  
 Permissible tensile strength:  
 POM material: 2250 N (506 lbf)  
  
 Delivery: 3.05 m (10 ft)  
 No. of links/box: 80

E		G		H		J		K		L		P		Q		T	
mm	in	mm	in	mm	in	mm	in	mm	in	mm	in	mm	in	mm	in	mm	in
7.1	0.28	44.5	1.75	15.9	0.63	61.5	2.42	11.9	0.47	8.5	0.33	38.1	1.50	43.1	1.70	5.0	0.20

All dimensions are for chains in POM material.

	Width (W)		Material & color	Pin material	Weight		Min. radius (R)	
	mm	in			kg/m	lb/ft	mm	in
<b>K325</b>	82.6	3.25	POM-DI <b>W</b>	<b>SS304</b>	1.0	0.67	200	7.87

Non standard material and color: See uni Material and Color Overview.  
 Non standard pin material: See uni Material and Color Overview.

## Accessories

### Rubber Top/NON STANDARD

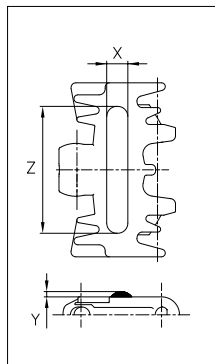

When ordering, please state the required distance between the Rubber Top.

Other Non Standard rubber profiles:  
 See uni Rubber Profile Overview.

Width	Link material	Rubber material	Z		X		Y	
			mm	in	mm	in	mm	in
<b>K325</b>	POM-DI <b>W</b>	05 <b>I</b>	60	2.36	10	0.39	2.5	0.10

### Product Support

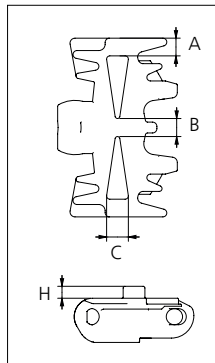
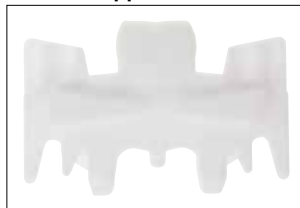

Width	Link material	H		A		B		C	
		mm	in	mm	in	mm	in	mm	in
<b>K325</b>	POM-DI <b>W</b>	5.5	0.22						
		10.0	0.39	8.2	0.32	7.3	0.29	10.2	0.40
		17.0	0.67						



STANDARD

SIDE FLEXING

PITCH 38.1 MM/1.50 IN

### Sprocket

No. of teeth	Pitch diameter		Overall diameter		Min. ø bore		Max. ø bore		Hub diameter		Dimension A		Dimension B		Molded PA66 LG	Molded Cast Iron	Machined PA66 N
	mm	in	mm	in	mm	in	mm	in	mm	in	mm	in	mm	in			
Z9	111.4	4.39	109.7	4.32	20.0	0.80	40.0	1.60	70.0	2.76	55.9	2.20	63.2	2.49	x	x	
Z10	123.3	4.85	122.3	4.81	20.0	0.80	40.0	1.60	70.0	2.76	62.2	2.45	69.2	2.72	x	x	
Z11	135.2	5.32	134.8	5.31	20.0	0.80	40.0	1.60	70.0	2.76	68.4	2.69	75.1	2.96	x	x	
Z12	147.2	5.80	147.2	5.80	20.0	0.80	40.0	1.60	70.0	2.76	74.6	2.94	81.1	3.19	x	x	
Z15	183.3	7.22	184.3	7.26	20.0	0.80	40.0	1.60	70.0	2.76	93.2	3.67	99.2	3.91	x	x	

### Two part sprocket

No. of teeth	Pitch diameter		Overall diameter		Min. ø bore		Max. ø bore		Hub diameter		Dimension A		Dimension B		Molded PA66 LG	Molded Cast Iron	Machined PA66 N
	mm	in	mm	in	mm	in	mm	in	mm	in	mm	in	mm	in			
Z9	111.4	4.39	109.7	4.32	20.0	0.80	40.0	1.60	70.0	2.76	55.9	2.20	63.2	2.49	x		
Z10	123.3	4.85	122.3	4.81	20.0	0.80	40.0	1.60	70.0	2.76	62.2	2.45	69.2	2.72	x		
Z11	135.2	5.32	134.8	5.31	20.0	0.80	40.0	1.60	70.0	2.76	68.4	2.69	75.1	2.96	x		
Z12	147.2	5.80	147.2	5.80	20.0	0.80	40.0	1.60	70.0	2.76	74.6	2.94	81.1	3.19	x		

Non standard material and color:  
See uni Material and Color Overview.

### Molded sprocket      Cast iron sprocket      Molded two part sprocket

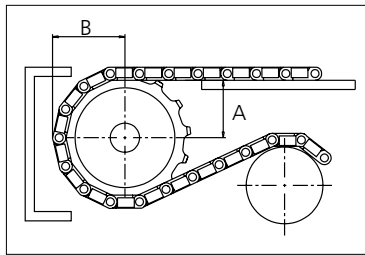

Please ensure that sufficient size shaft and keyway are chosen for corresponding load.

Other sprocket sizes are available upon request  
Width of tooth: 15.8 mm/0.62 in  
Width of sprocket: 42.3 mm/1.67 in  
uni Retainer Rings: See uni Retainer Ring data sheet  
uni Idler: See uni Idler data sheet

uni 879 Tab Safety Finger/150819



Expert advice, quality solutions and local service for all your belting needs  
[www.ammeraalbeltech.com](http://www.ammeraalbeltech.com)

**Ammeraal Beltech Modular A/S**  
Hjulgagervej 21  
DK-7100 Vejle

T +45 7572 3100  
F +45 7572 3348  
admin@unichains.com  
www.unichains.com

This information is subject to alteration due to continuous development. Ammeraal Beltech will not be held liable for the incorrect use of the above stated information. This information replaces previous information. All activities performed and services rendered by Ammeraal Beltech are subject to general terms and conditions of sale and delivery, as applied by its operating companies.





# Special Plastic Chain

Series **uni 880** Type **Rib Flex**

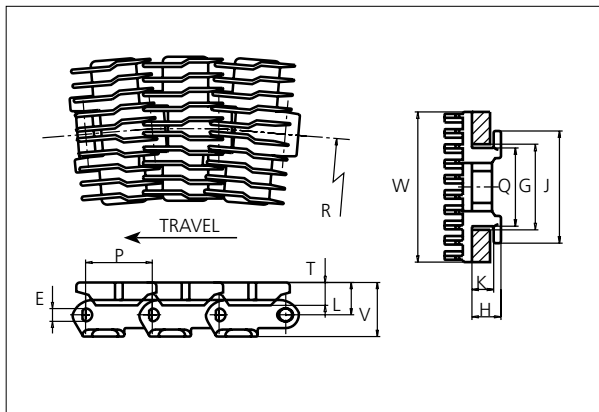
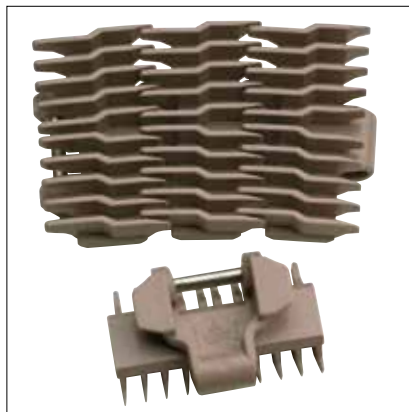

**Special Plastic Chain**  
 Side flexing chain  
 Pitch: 38.1 mm (1.50 in)  
 Backflex radius: 90.0 mm (3.5 in)  
 Permissible tensile strength:  
 POM material: 1800 N (405 lbf)  
  
 Delivery: 3.05 m (10 ft)  
 No. of links/box: 80

NON STANDARD

E		G		H		J		K		L		P		Q		T		V	
mm	in	mm	in	mm	in	mm	in	mm	in	mm	in	mm	in	mm	in	mm	in	mm	in
7.2	0.28	44.5	1.75	15.9	0.63	61.5	2.42	11.9	0.47	18.5	0.73	38.1	1.50	42.9	1.69	14.9	0.59	30.7	1.21

All dimensions are for chains in POM material.

	Width (W)		Recommended material & color	Recommended pin material	Weight		Min. radius (R)	
	mm	in			kg/m	lb/ft	mm	in
<b>K250</b>	63.5	2.50	POM-LF <b>BR</b>	<b>SS304</b>	1.2	0.81	457	17.99
<b>K325</b>	82.6	3.25	POM-LF <b>BR</b>	<b>SS304</b>	1.3	0.87	457	17.99
<b>K450</b>	114.3	4.50	POM-LF <b>BR</b>	<b>SS304</b>	1.5	1.01	457	17.99

Non standard material and color: See uni Material and Color Overview.  
 Non standard pin material: See uni Material and Color Overview.

SIDE FLEXING

## Accessories

### Finger plates

#### Single Sided

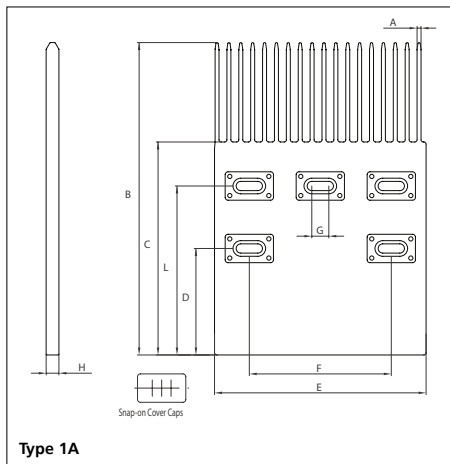

#### Single Sided

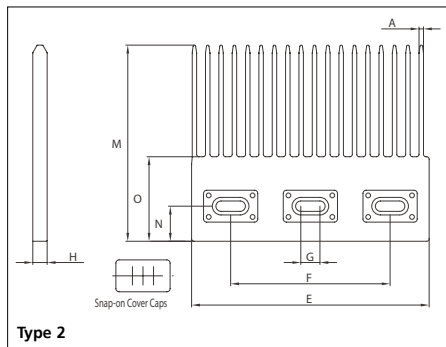

**Material for finger plates:** POM-LF **BR**  
 Non standard material and color:  
 See uni Material and Color Overview.

#### Double Sided

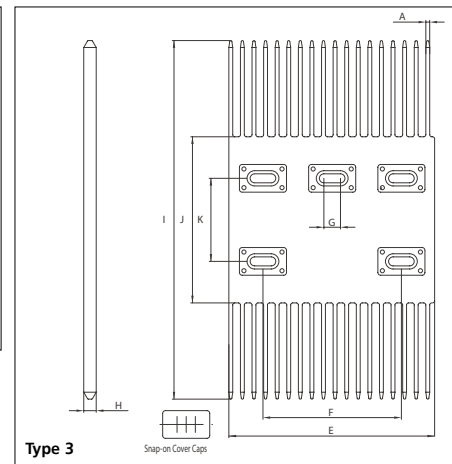

For the ribbed versions of uni special chains finger plates are available to facilitate product transfer between two conveyors. The finger plates are supplied with cover caps to close the screw holes. The cover caps can easily be removed with a screw driver.



A		B		C		D		E		F		G		H	
mm	in	mm	in	mm	in	mm	in	mm	in	mm	in	mm	in	mm	in
2.8	0.11	220.0	8.66	150.0	5.91	75.0	2.95	149.0	5.87	100.0	3.94	12.0	0.47	9.0	0.35
I		J		K		L		M		N		O		-	
mm	in	mm	in	mm	in	mm	in	mm	in	mm	in	mm	in	mm	in
259.0	10.20	120.0	4.72	60.0	2.36	119.0	4.69	123.0	4.84	22.0	0.87	53.0	2.09	-	-

PITCH 38.1 MM/1.50 IN

### Sprocket

No. of teeth	Pitch diameter		Overall diameter		Min. ø bore		Max. ø bore		Hub diameter		Dimension A		Dimension B		Molded PA66 LG	Molded Cast Iron	Machined PA66
	mm	in	mm	in	mm	in	mm	in	mm	in	mm	in	mm	in			
Z9	111.4	4.39	109.7	4.32	20.0	0.80	40.0	1.60	70.0	2.76	55.9	2.20	63.2	2.49	x	x	
Z10	123.3	4.85	122.3	4.81	20.0	0.80	40.0	1.60	70.0	2.76	62.2	2.45	69.2	2.72	x	x	
Z11	135.2	5.32	134.8	5.31	20.0	0.80	40.0	1.60	70.0	2.76	68.4	2.69	75.1	2.96	x	x	
Z12	147.2	5.80	147.2	5.80	20.0	0.80	40.0	1.60	70.0	2.76	74.6	2.94	81.1	3.19	x	x	
Z15	183.3	7.22	184.3	7.26	20.0	0.80	40.0	1.60	70.0	2.76	93.2	3.67	99.2	3.91	x	x	

### Two part sprocket

No. of teeth	Pitch diameter		Overall diameter		Min. ø bore		Max. ø bore		Hub diameter		Dimension A		Dimension B		Molded PA66 LG	Molded Cast Iron	Machined PA66
	mm	in	mm	in	mm	in	mm	in	mm	in	mm	in	mm	in			
Z9	111.4	4.39	109.7	4.32	20.0	0.80	40.0	1.60	70.0	2.76	55.9	2.20	63.2	2.49	x		
Z10	123.3	4.85	122.3	4.81	20.0	0.80	40.0	1.60	70.0	2.76	62.2	2.45	69.2	2.72	x		
Z11	135.2	5.32	134.8	5.31	20.0	0.80	40.0	1.60	70.0	2.76	68.4	2.69	75.1	2.96	x		
Z12	147.2	5.80	147.2	5.80	20.0	0.80	40.0	1.60	70.0	2.76	74.6	2.94	81.1	3.19	x		

Non standard material and color:  
See uni Material and Color Overview.

### Molded sprocket      Cast iron sprocket      Molded two part sprocket

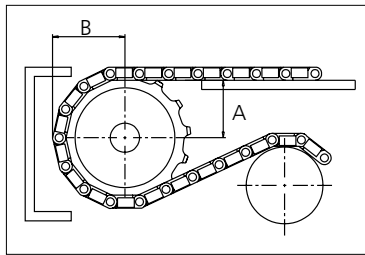

Please ensure that sufficient size shaft and keyway are chosen for corresponding load.

Other sprocket sizes are available upon request  
Width of tooth: 15.8 mm/0.62 in  
Width of sprocket: 42.3 mm/1.67 in  
uni Retainer Rings: See uni Retainer Ring data sheet  
uni Idler: See uni Idler data sheet

uni 880 Rib Flex/1401



Solid advice  
For all your belting needs  
Local stock & service  
[www.ammeraalbeltech.com](http://www.ammeraalbeltech.com)

**Ammeraal Beltech Modular A/S**  
Hjulmagervej 21  
DK-7100 Vejle

T +45 7572 3100  
F +45 7572 3348  
admin@unichains.com  
www.unichains.com

This information is subject to alteration due to continuous development. Ammeraal Beltech will not be held liable for the incorrect use of the above stated information. This information replaces previous information. All activities performed and services rendered by Ammeraal Beltech are subject to general terms and conditions of sale and delivery, as applied by its operating companies.



# Special Plastic Chain

Series **uni 880** Type **Rib**

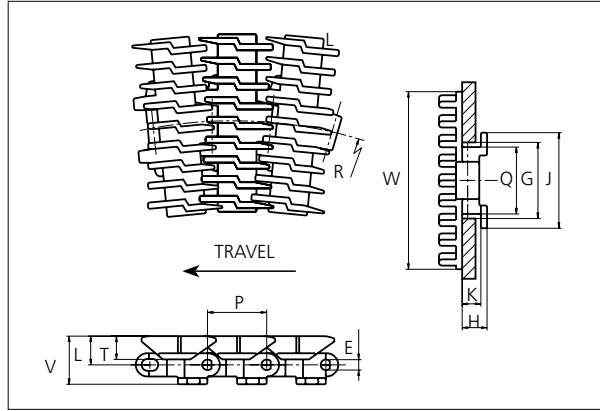
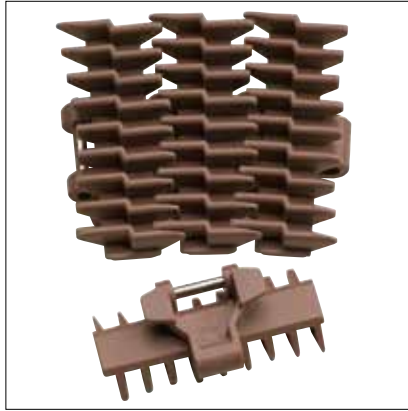

**Special Plastic Chain**  
 Side flexing chain  
 Pitch: 38.1 mm (1.50 in)  
 Backflex radius: 35.0 mm (1.4 in)  
 Permissible tensile strength:  
 POM material: 1800 N (405 lbf)  
  
 Delivery: 3.05 m (10 ft)  
 No. of links/box: 80

NON STANDARD

E		G		H		J		K		L		P		Q		T		V	
mm	in	mm	in	mm	in	mm	in	mm	in	mm	in	mm	in	mm	in	mm	in	mm	in
7.1	0.28	44.5	1.75	16.0	0.63	61.5	2.42	11.9	0.47	18.5	0.73	38.1	1.50	42.9	1.69	15.0	0.59	31.1	1.22

All dimensions are for chains in POM material.

## Accessories

### Finger plates

#### Single Sided

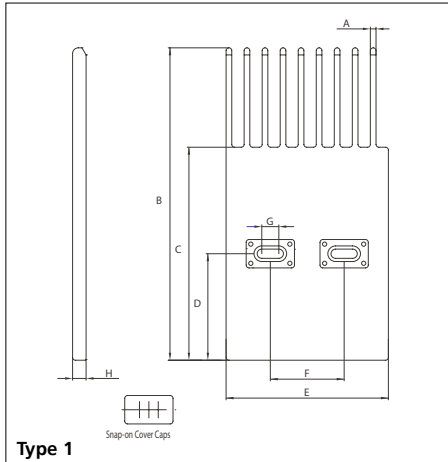

#### Single Sided

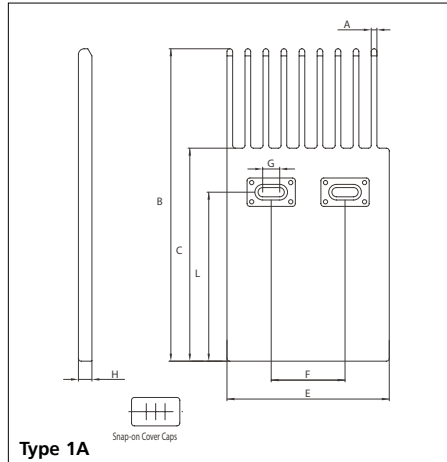

#### Single Sided

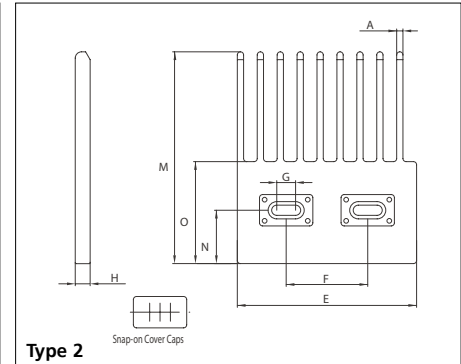

**Material for finger plates:** POM-LF **BR**

Non standard material and color:  
 See uni Material and Color Overview.

For the ribbed versions of uni special chains finger plates are available to facilitate product transfer between two conveyors. The finger plates are supplied with cover caps to close the screw holes. The cover caps can easily be removed with a screw driver.

A		B		C		D		E		F	
mm	in	mm	in	mm	in	mm	in	mm	in	mm	in
4.0	0.16	220.0	8.66	150.0	5.91	75.0	2.95	114.3	4.50	52.0	2.05

G		H		L		M		N		O	
mm	in	mm	in	mm	in	mm	in	mm	in	mm	in
12.0	0.47	9.5	0.37	119.0	4.69	135.0	5.31	34.0	1.34	65.0	2.56

SIDE FLEXING

PITCH 38.1 MM/1.50 IN



### Sprocket

No. of teeth	Pitch diameter		Overall diameter		Min. ø bore		Max. ø bore		Hub diameter		Dimension A		Dimension B		Molded PA66 LG	Molded Cast Iron	Machined PA66
	mm	in	mm	in	mm	in	mm	in	mm	in	mm	in	mm	in			
Z9	111.4	4.39	109.7	4.32	20.0	0.80	40.0	1.60	70.0	2.76	55.9	2.20	63.2	2.49	x	x	
Z10	123.3	4.85	122.3	4.81	20.0	0.80	40.0	1.60	70.0	2.76	62.2	2.45	69.2	2.72	x	x	
Z11	135.2	5.32	134.8	5.31	20.0	0.80	40.0	1.60	70.0	2.76	68.4	2.69	75.1	2.96	x	x	
Z12	147.2	5.80	147.2	5.80	20.0	0.80	40.0	1.60	70.0	2.76	74.6	2.94	81.1	3.19	x	x	
Z15	183.3	7.22	184.3	7.26	20.0	0.80	40.0	1.60	70.0	2.76	93.2	3.67	99.2	3.91	x	x	

### Two part sprocket

No. of teeth	Pitch diameter		Overall diameter		Min. ø bore		Max. ø bore		Hub diameter		Dimension A		Dimension B		Molded PA66 LG	Molded Cast Iron	Machined PA66
	mm	in	mm	in	mm	in	mm	in	mm	in	mm	in	mm	in			
Z9	111.4	4.39	109.7	4.32	20.0	0.80	40.0	1.60	70.0	2.76	55.9	2.20	63.2	2.49	x		
Z10	123.3	4.85	122.3	4.81	20.0	0.80	40.0	1.60	70.0	2.76	62.2	2.45	69.2	2.72	x		
Z11	135.2	5.32	134.8	5.31	20.0	0.80	40.0	1.60	70.0	2.76	68.4	2.69	75.1	2.96	x		
Z12	147.2	5.80	147.2	5.80	20.0	0.80	40.0	1.60	70.0	2.76	74.6	2.94	81.1	3.19	x		

Non standard material and color:  
See uni Material and Color Overview.

### Molded sprocket      Cast iron sprocket      Molded two part sprocket

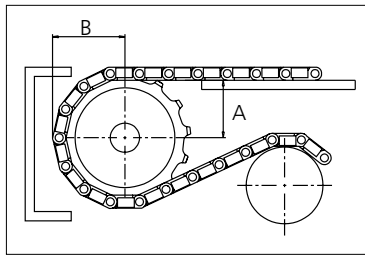

Please ensure that sufficient size shaft and keyway are chosen for corresponding load.

Other sprocket sizes are available upon request  
Width of tooth: 15.8 mm/0.62 in  
Width of sprocket: 42.3 mm/1.67 in  
uni Retainer Rings: See uni Retainer Ring data sheet  
uni Idler: See uni Idler data sheet

uni 880 Rib/1401



*Solid advice*  
For all your belting needs  
Local stock & service  
[www.ammeraalbeltech.com](http://www.ammeraalbeltech.com)

**Ammeraal Beltech Modular A/S**  
Hjulmagervej 21  
DK-7100 Vejle

T +45 7572 3100  
F +45 7572 3348  
admin@unichains.com  
www.unichains.com

This information is subject to alteration due to continuous development. Ammeraal Beltech will not be held liable for the incorrect use of the above stated information. This information replaces previous information. All activities performed and services rendered by Ammeraal Beltech are subject to general terms and conditions of sale and delivery, as applied by its operating companies.



# Special Plastic Chains

Series **uni 882** Type **Tab PRR**

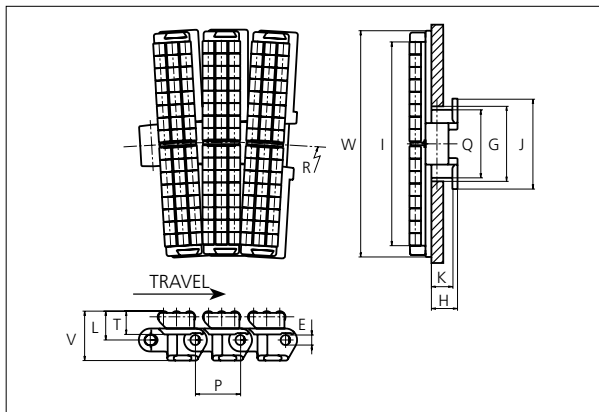

### Special Plastic Chains

Side flexing chain  
 Pitch: 38.1 mm (1.50 in)  
 Backflex radius: 101.0 mm (4.0 in)  
 Permissible tensile strength:  
 POM material: 4000 N (899 lbf)  
 Delivery: 3.048 m (10 ft)  
 No. of links/box: 80  
 Axle materials for ø5.0 mm (0.20 in) accumulation rollers: See uni Material and Color Overview.  
 Overview.

STANDARD

E		G		H		I (K325)		I (K400)		I (K750)		J		K		L		P		Q		T		V			
mm	in	mm	in	mm	in	mm	in	mm	in	mm	in	mm	in	mm	in	mm	in	mm	in	mm	in	mm	in	mm	in	mm	in
8.7	0.34	59.5	2.34	22.2	0.87	79.3	3.12	98.3	3.87	174.5	6.87	62.2	3.00	17.5	0.69	23.5	0.93	38.1	1.50	57.2	2.25	19.0	0.75	41.2	1.62		

All dimensions are for chains in POM material.

	Width (W)		Base material & color	Roller material & color	Pin material	Weight		Min. radius (R)	
	mm	in				kg/m	lb/ft	mm	in
<b>K375</b>	95.3	3.75	POM-LF BR	POM-LF BR	SS304	3.4	2.28	610	24.02
<b>K450</b>	114.3	4.50	POM-LF BR	POM-LF BR	SS304	3.9	2.62	610	24.02
<b>K750</b>	190.5	7.50	POM-LF BR	POM-LF BR	SS304	5.6	3.76	610	24.02

Non standard material and color: See uni Material and Color Overview.  
 Non standart pin material: See uni Material and Color Overview.

SIDE FLEXING

PITCH 38.1 MM/1.50 IN



### Sprocket

No of teeth	Pitch diameter		Overall-diameter		Min. ø bore		Max. ø bore		Hub-diameter		A-dimension		B-dimension		Molded PA66 LG	Molded Cast Iron	Machined PA66
	mm	in	mm	in	mm	in	mm	in	mm	in	mm	in	mm	in			
Z9	111.4	4.39	112.7	4.44	20.0	0.79	45.0	1.77	60.0	2.36	57.1	2.25	65.4	2.57	x	x	
Z10	123.3	4.85	125.0	4.92	20.0	0.79	45.0	1.77	65.0	2.56	63.4	2.50	71.3	2.81	x	x	
Z11	135.2	5.32	137.4	5.41	20.0	0.79	50.0	1.97	73.5	2.89	69.6	2.74	77.3	3.04	x	x	
Z12	147.2	5.80	150.6	5.93	20.0	0.79	50.0	1.97	73.5	2.89	75.8	2.98	83.3	3.28	x	x	
Z15	183.3	7.22	186.9	7.36	20.0	0.79	50.0	1.97	120.0	4.72	94.3	3.71	101.3	3.99		x	x

### Two part sprocket

No of teeth	Pitch diameter		Overall-diameter		Min. ø bore		Max. ø bore		Hub-diameter		A-dimension		B-dimension		Molded PA66 LG	Molded Cast Iron	Machined PA66
	mm	in	mm	in	mm	in	mm	in	mm	in	mm	in	mm	in			
Z9	111.4	4.39	112.7	4.31	20.0	0.79	45.0	1.77	60.0	2.36	57.1	2.25	65.4	2.57	x		
Z10	123.3	4.85	125.0	4.81	20.0	0.79	45.0	1.77	65.0	2.56	63.4	2.50	71.3	2.81	x		
Z11	135.2	5.32	137.4	5.30	20.0	0.79	50.0	1.97	73.5	2.89	69.6	2.74	77.3	3.04	x		
Z12	147.2	5.80	150.6	5.79	20.0	0.79	50.0	1.97	73.5	2.89	75.8	2.98	83.3	3.28	x		

#### Molded sprocket



#### Cast iron sprocket



#### Machined sprocket



#### Molded two part sprocket



Non standard material and color:  
See uni Material and Color Overview.

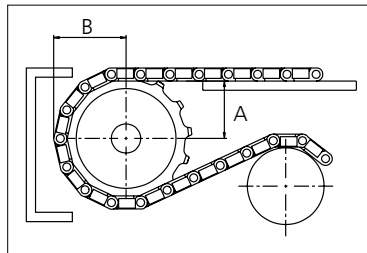

Please ensure that sufficient size shaft and keyway are chosen for corresponding load.

Other sprocket sizes are available upon request  
Width of tooth: 22.20 mm/0.87 in  
Width of sprocket: 42.3 mm/1.70 in  
uni Retainer Rings: See uni Retainer Ring data sheet

uni 882 Tab PRR/1 304



Solid advice  
For all your belting needs  
Local stock & service  
[www.ammeraalbeltech.com](http://www.ammeraalbeltech.com)

**Ammeraal Beltech Modular A/S**  
Hjulmagervej 21  
DK-7100 Vejle

T +45 7572 3100  
F +45 7572 3348  
admin@unichains.com  
www.unichains.com

This information is subject to alteration due to continuous development. Ammeraal Beltech will not be held liable for the incorrect use of the above stated information. This information replaces previous information. All activities performed and services rendered by Ammeraal Beltech are subject to general terms and conditions of sale and delivery, as applied by its operating companies.



# Special Plastic Chain

Series **uni 882** Type **Tab PRR4**

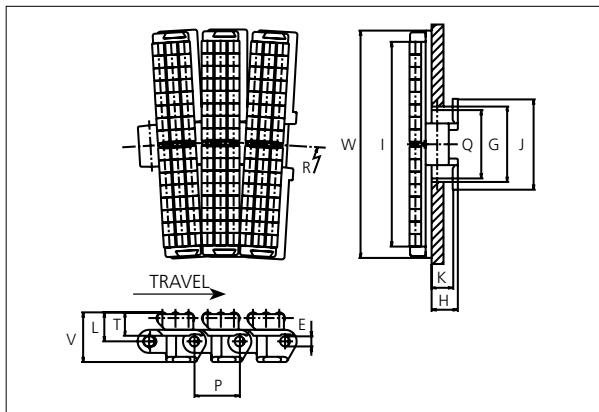

**Special Plastic Chain**  
 Side flexing chain  
 Pitch: 38.1 mm (1.50 in)  
 Backflex radius: 101.0 mm (4.0 in)  
 Permissible tensile strength:  
 POM material: 4000 N (899 lbf)  
  
 Delivery: 3.048 m (10 ft)  
 No. of links/box: 80  
  
 Axle materials for  $\varnothing 4.0$  mm (0.16 in)  
 accumulation rollers: See  
 uni Material and Color Overview.

NON STANDARD

E		G		H		I (K325)		I (K400)		I (K750)		J		K		L		P		Q		T		V	
mm	in	mm	in	mm	in	mm	in	mm	in	mm	in	mm	in	mm	in	mm	in	mm	in	mm	in	mm	in	mm	in
8.7	0.34	59.5	2.34	22.2	0.87	79.3	3.12	98.3	3.87	174.5	6.87	76.2	3.00	17.5	0.69	23.5	0.93	38.1	1.50	57.2	2.25	19.0	0.75	41.2	1.62

All dimensions are for chains in POM material.

	Width (W)		Recommended base material & color	Recommended roller material & color	Recommended pin material	Weight		Min. radius (R)	
	mm	in				kg/m	lb/ft	mm	in
<b>K375</b>	95.3	3.75	POM-LF <b>BR</b>	POM-D <b>K</b>	<b>SS304</b>	3.4	2.30	610	24.02
<b>K450</b>	114.3	4.50	POM-LF <b>BR</b>	POM-D <b>K</b>	<b>SS304</b>	3.9	2.55	610	24.02
<b>K750</b>	190.5	7.50	POM-LF <b>BR</b>	POM-D <b>K</b>	<b>SS304</b>	5.7	3.83	610	24.02

Non standard material and color: See uni Material and Color Overview.  
 Non standart pin material: See uni Material and Color Overview.

SIDE FLEXING

PITCH 38.1 MM/1.50 IN



### Sprocket

No of teeth	Pitch diameter		Overall-diameter		Min. ø bore		Max. ø bore		Hub-diameter		A-dimension		B-dimension		Molded PA66 LG	Molded Cast Iron	Machined PA66
	mm	in	mm	in	mm	in	mm	in	mm	in	mm	in	mm	in			
Z9	111.4	4.39	112.7	4.44	20.0	0.79	45.0	1.77	60.0	2.36	57.1	2.25	65.4	2.57	x	x	
Z10	123.3	4.85	125.0	4.92	20.0	0.79	45.0	1.77	65.0	2.56	63.4	2.50	71.3	2.81	x	x	
Z11	135.2	5.32	137.4	5.41	20.0	0.79	50.0	1.97	73.5	2.89	69.6	2.74	77.3	3.04	x	x	
Z12	147.2	5.80	150.6	5.93	20.0	0.79	50.0	1.97	73.5	2.89	75.8	2.98	83.3	3.28	x	x	
Z15	183.3	7.22	186.9	7.36	20.0	0.79	50.0	1.97	120.0	4.72	94.3	3.71	101.3	3.99		x	x

### Two part sprocket

No of teeth	Pitch diameter		Overall-diameter		Min. ø bore		Max. ø bore		Hub-diameter		A-dimension		B-dimension		Molded PA66 LG	Molded Cast Iron	Machined PA66
	mm	in	mm	in	mm	in	mm	in	mm	in	mm	in	mm	in			
Z9	111.4	4.39	112.7	4.31	20.0	0.79	45.0	1.77	60.0	2.36	57.1	2.25	65.4	2.57	x		
Z10	123.3	4.85	125.0	4.81	20.0	0.79	45.0	1.77	65.0	2.56	63.4	2.50	71.3	2.81	x		
Z11	135.2	5.32	137.4	5.30	20.0	0.79	50.0	1.97	73.5	2.89	69.6	2.74	77.3	3.04	x		
Z12	147.2	5.80	150.6	5.79	20.0	0.79	50.0	1.97	73.5	2.89	75.8	2.98	83.3	3.28	x		

#### Molded sprocket



#### Cast iron sprocket



#### Machined sprocket



#### Molded two part sprocket



Non standard material and color:  
See uni Material and Color Overview.

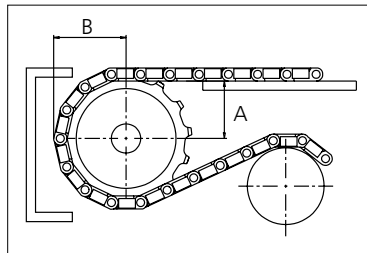

Please ensure that sufficient size shaft and keyway are chosen for corresponding load.

Other sprocket sizes are available upon request  
Width of tooth: 22.20 mm/0.87 in  
Width of sprocket: 42.3 mm/1.70 in  
uni Retainer Rings: See uni Retainer Ring data sheet

uni 882 Tab PRR4/1304



Solid advice  
For all your belting needs  
Local stock & service  
[www.ammeraalbeltech.com](http://www.ammeraalbeltech.com)

**Ammeraal Beltech Modular A/S**  
Hjulmagervej 21  
DK-7100 Vejle

T +45 7572 3100  
F +45 7572 3348  
admin@unichains.com  
www.unichains.com

This information is subject to alteration due to continuous development. Ammeraal Beltech will not be held liable for the incorrect use of the above stated information. This information replaces previous information. All activities performed and services rendered by Ammeraal Beltech are subject to general terms and conditions of sale and delivery, as applied by its operating companies.





# Special Plastic Chain

Series **uni 882** Type **Rib Flex**

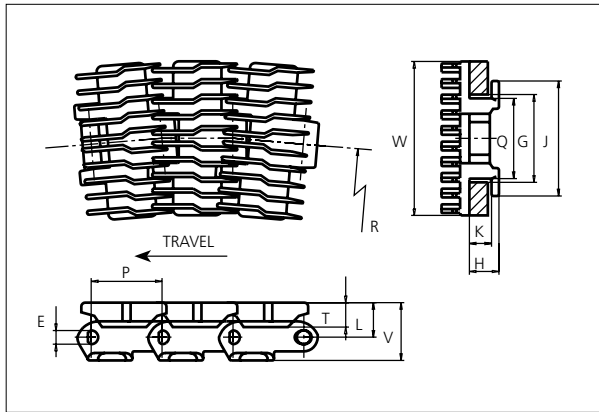

**Special Chains**  
 Side flexing chain  
 Pitch: 38.1 mm (1.50 in)  
 Backflex radius: 75.0 mm (3.00 in)  
 Permissible tensile strength:  
 POM material: 4000 N (899 lbf)  
  
 Delivery: 3.048 m (10 ft)  
 No. of links/box: 80

E		G		H		J		K		L		P		Q		T		V	
mm	in	mm	in	mm	in	mm	in	mm	in	mm	in	mm	in	mm	in	mm	in	mm	in
8.7	0.34	59.5	2.34	22.2	0.87	76.20	3.00	17.5	0.69	19.7	0.78	38.1	1.50	57.2	2.25	15.0	0.59	37.0	1.46

All dimensions are for chains in POM material.

	Width (W)		Recommended material & color	Recommended pin material	Weight		min. radius R	
	mm	in			kg/m	lb/ft	mm	in
<b>K600</b>	147.4	5.80	POM-LF <b>BR</b>	<b>SS304</b>	2.4	1.61	610.0	24.02

Non standard material and color: See uni Material and Color Overview.  
 Non standard pin material: See uni Material and Color Overview.

## Accessories

### Finger plates

#### Single Sided

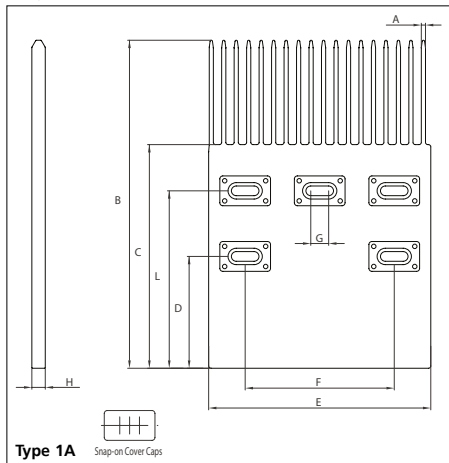

#### Single Sided

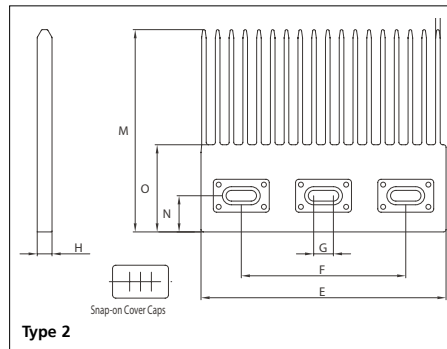

**Material for finger plates: POM-LF BR**

Non standard material and color:  
 See uni Material and Color Overview.

#### Double Sided

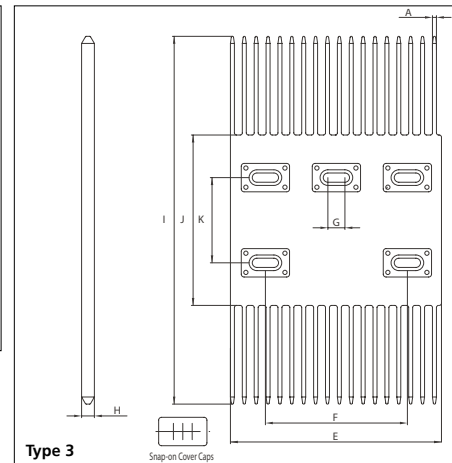

For the ribbed versions of uni special chains finger plates are available to facilitate product transfer between two conveyors.

The finger plates are supplied with cover caps to close the screw holes. The cover caps can easily be removed with a screw driver.

A		B		C		D		E		F		G		H	
mm	in	mm	in	mm	in	mm	in	mm	in	mm	in	mm	in	mm	in
2.8	0.11	220.0	8.66	150.0	5.91	75.0	2.95	149.0	5.87	100.0	3.94	12.0	0.47	9.0	0.35

I		J		K		L		M		N		O		-	
mm	in	mm	in	mm	in	mm	in	mm	in	mm	in	mm	in	mm	in
259.0	10.20	120.0	4.72	60.0	2.36	119.0	4.69	123.0	4.84	22.0	0.87	53.0	2.09	-	-



NON STANDARD

SIDE FLEXING

PITCH 38.1 MM/1.50 IN

### Sprocket

No of teeth	Pitch diameter		Overall-diameter		Min. ø bore		Max. ø bore		Hub-diameter		A-dimension		B-dimension		Molded PA66 LG	Molded Cast Iron	Machined PA66
	mm	in	mm	in	mm	in	mm	in	mm	in	mm	in	mm	in			
Z9	111.4	4.39	112.7	4.44	20.0	0.79	45.0	1.77	60.0	2.36	57.1	2.25	65.4	2.57	x	x	
Z10	123.3	4.85	125.0	4.92	20.0	0.79	45.0	1.77	65.0	2.56	63.4	2.50	71.3	2.81	x	x	
Z11	135.2	5.32	137.4	5.41	20.0	0.79	50.0	1.97	73.5	2.89	69.6	2.74	77.3	3.04	x	x	
Z12	147.2	5.80	150.6	5.93	20.0	0.79	50.0	1.97	73.5	2.89	75.8	2.98	83.3	3.28	x	x	
Z15	183.3	7.22	186.9	7.36	20.0	0.79	50.0	1.97	120.0	4.72	94.3	3.71	101.3	3.99		x	x

### Two part sprocket

No of teeth	Pitch diameter		Overall-diameter		Min. ø bore		Max. ø bore		Hub-diameter		A-dimension		B-dimension		Molded PA66 LG	Molded Cast Iron	Machined PA66
	mm	in	mm	in	mm	in	mm	in	mm	in	mm	in	mm	in			
Z9	111.4	4.39	112.7	4.31	20.0	0.79	45.0	1.77	60.0	2.36	57.1	2.25	65.4	2.57	x		
Z10	123.3	4.85	125.0	4.81	20.0	0.79	45.0	1.77	65.0	2.56	63.4	2.50	71.3	2.81	x		
Z11	135.2	5.32	137.4	5.30	20.0	0.79	50.0	1.97	73.5	2.89	69.6	2.74	77.3	3.04	x		
Z12	147.2	5.80	150.6	5.79	20.0	0.79	50.0	1.97	73.5	2.89	75.8	2.98	83.3	3.28	x		

#### Molded sprocket



#### Cast iron sprocket



#### Machined sprocket



#### Molded two part sprocket



Non standard material and color:  
See uni Material and Color Overview.

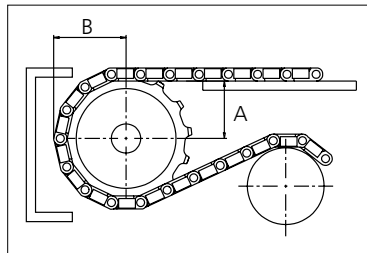

Please ensure that sufficient size shaft and keyway are chosen for corresponding load.

Other sprocket sizes are available upon request  
Width of tooth: 22.20 mm/0.87 in  
Width of sprocket: 42.3 mm/1.70 in  
uni Retainer Rings: See uni Retainer Ring data sheet

uni 882 Rib Flex/1304



Solid advice  
For all your belting needs  
Local stock & service  
[www.ammeraalbeltech.com](http://www.ammeraalbeltech.com)

**Ammeraal Beltech Modular A/S**  
Hjulmagervej 21  
DK-7100 Vejle

T +45 7572 3100  
F +45 7572 3348  
admin@unichains.com  
www.unichains.com

This information is subject to alteration due to continuous development. Ammeraal Beltech will not be held liable for the incorrect use of the above stated information. This information replaces previous information. All activities performed and services rendered by Ammeraal Beltech are subject to general terms and conditions of sale and delivery, as applied by its operating companies.



# Special Plastic Chain

Series **uni 882** Type **Tab SC**

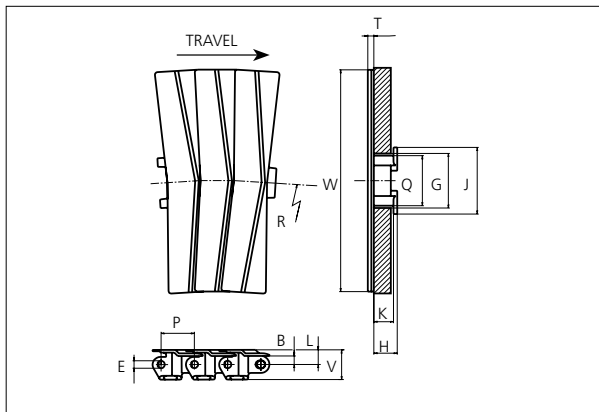

**Special Plastic Chain**  
 Side flexing chain  
 Pitch: 38.1 mm (1.50 in)  
 Backflex radius: 125.0 mm (4.90 in)  
 Permissible tensile strength:  
 POM material: 4000 N (899 lbf)  
  
 Delivery: 3.048 m (10 ft)  
 No. of links/box: 80

STANDARD

B		E		G		H		J		K		L		P		Q		T		V	
mm	in	mm	in	mm	in	mm	in	mm	in	mm	in	mm	in	mm	in	mm	in	mm	in	mm	in
9.7	0.38	8.7	0.34	59.5	2.34	21.9	0.86	76.2	3.00	17.5	0.69	16.7	0.66	38.1	1.50	57.2	2.25	7.0	0.28	29.0	1.14

All dimensions are for chains in POM material.

	Width (W)		Material & color	Pin material	Weight		min. radius R	
	mm	in			kg/m	lb/ft	mm	in
<b>K450</b>	114.3	4.50	POM-LF <b>BR</b>	<b>SS304</b>	2.2	1.48	610	24.02
<b>K750</b>	190.5	7.50	POM-LF <b>BR</b>	<b>SS304</b>	3.0	2.01	610	24.02
<b>K1000</b>	254.0	10.00	POM-LF <b>BR</b>	<b>SS304</b>	3.4	2.28	610	24.02

Non standard material and color: See uni Material and Color Overview.  
 Non standard pin material: See uni Material and Color Overview.

SIDE FLEXING

PITCH 38.1 MM/1.50 IN



## Sprocket

No of teeth	Pitch diameter		Overall-diameter		Min. ø bore		Max. ø bore		Hub-diameter		A-dimension		B-dimension		Molded PA66 LG	Molded Cast Iron	Machined PA66
	mm	in	mm	in	mm	in	mm	in	mm	in	mm	in	mm	in			
Z9	111.4	4.39	112.7	4.44	20.0	0.79	45.0	1.77	60.0	2.36	62.0	2.44	73.3	2.89	x	x	
Z10	123.3	4.85	125.0	4.92	20.0	0.79	45.0	1.77	65.0	2.56	68.3	2.69	79.3	3.12	x	x	
Z11	135.2	5.32	137.4	5.41	20.0	0.79	50.0	1.97	73.5	2.89	74.6	2.94	85.2	3.35	x	x	
Z12	147.2	5.80	150.6	5.93	20.0	0.79	50.0	1.97	73.5	2.89	80.8	3.18	91.2	3.59	x	x	
Z15	183.3	7.22	186.9	7.36	20.0	0.79	50.0	1.97	120.0	4.72	99.3	3.91	109.1	4.30		x	x

## Two part sprocket

No of teeth	Pitch diameter		Overall-diameter		Min. ø bore		Max. ø bore		Hub-diameter		A-dimension		B-dimension		Molded PA66 LG	Molded Cast Iron	Machined PA66
	mm	in	mm	in	mm	in	mm	in	mm	in	mm	in	mm	in			
Z9	111.4	4.39	112.7	4.31	20.0	0.79	45.0	1.77	60.0	2.36	62.0	2.44	73.3	2.89	x		
Z10	123.3	4.85	125.0	4.81	20.0	0.79	45.0	1.77	65.0	2.56	68.3	2.69	79.3	3.12	x		
Z11	135.2	5.32	137.4	5.30	20.0	0.79	50.0	1.97	73.5	2.89	74.6	2.94	85.2	3.35	x		
Z12	147.2	5.80	150.6	5.79	20.0	0.79	50.0	1.97	73.5	2.89	80.8	3.18	91.2	3.59	x		

### Molded sprocket



### Cast iron sprocket



### Machined sprocket



### Molded two part sprocket



Non standard material and color:  
See uni Material and Color Overview.

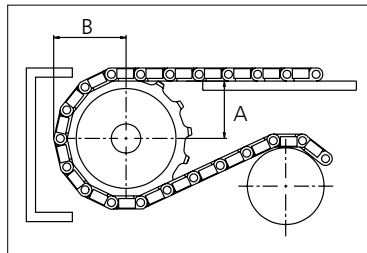

Please ensure that sufficient size shaft and keyway are chosen for corresponding load.

Other sprocket sizes are available upon request  
Width of tooth: 22.20 mm/0.87 in  
Width of sprocket: 42.3 mm/1.70 in  
uni Retainer Rings: See uni Retainer Ring data sheet

uni 882 Tab SC/1304



Solid advice  
For all your belting needs  
Local stock & service  
[www.ammeraalbeltech.com](http://www.ammeraalbeltech.com)

**Ammeraal Beltech Modular A/S**  
Hjulmagervej 21  
DK-7100 Vejle

T +45 7572 3100  
F +45 7572 3348  
admin@unichains.com  
www.unichains.com

This information is subject to alteration due to continuous development. Ammeraal Beltech will not be held liable for the incorrect use of the above stated information. This information replaces previous information. All activities performed and services rendered by Ammeraal Beltech are subject to general terms and conditions of sale and delivery, as applied by its operating companies.



# Special Plastic Chain

Series **uni 982** Type **SC**

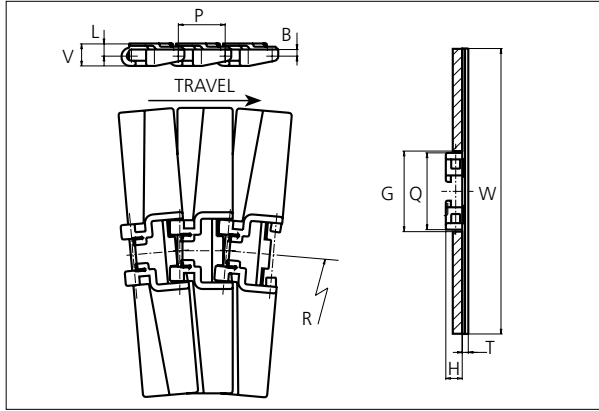

**Special Plastic Chain**  
 Side flexing chain  
 Pitch: 50.0 mm (1.97 in)  
 Backflex radius: 200 mm (7.9 in)  
 Permissible tensile strength:  
 POM material: 1000 N (225 lbf)  
  
 Delivery: 3.050 m (10 ft)  
 No. of links/box: 80

NON STANDARD

B		G		H		L		P		Q		T		V	
mm	in	mm	in	mm	in	mm	in	mm	in	mm	in	mm	in	mm	in
7.0	0.28	85.0	3.35	17.5	0.69	13.5	0.53	50.0	1.97	82.0	3.23	6.5	0.26	24.0	0.95

All dimensions are for chains in POM material.

Width (W)		Recommended material & color	Weight		Min. radius (R)	
mm	in		kg/m	lb/ft	mm	in
254.0	10.00	POM-SLF <b>B</b> AR <b>W</b>	1.6	1.07	610.0	24.02

Non standard material and color: See uni Material and Color Overview.

SIDE FLEXING

PITCH 50.0 MM/1.97 IN



## Sprocket

No of teeth	Pitch diameter		Overall diameter		Min. ø bore		Max. ø bore		Hub diameter		A-dimension		B-dimension		Molded PA66 LG	Machined PA66
	mm	in	mm	in	mm	in	mm	in	mm	in	mm	in	mm	in		
<b>Z10</b>	161.8	6.37			19.1	0.75	40.0	1.57	64.0	2.52						x

Non standard material and color:  
See uni Material and Color Overview.

### Machined sprocket

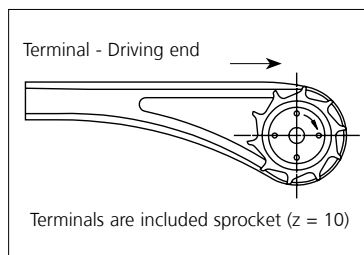
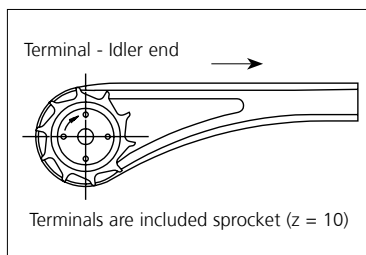
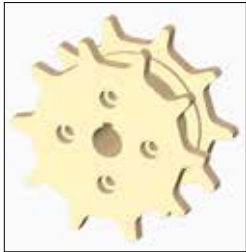

**Please ensure that sufficient size shaft and keyway are chosen for corresponding load.**

Other sprocket sizes are available upon request  
Width of tooth: 25.0 mm/1.00 in  
Width of sprocket: 42.3 mm/1.70 in  
uni Retainer Rings: See uni Retainer Ring data sheet

uni 982 SC/1304



*Solid advice*  
For all your belting needs  
Local stock & service  
[www.ammeraalbeltech.com](http://www.ammeraalbeltech.com)

**Ammeraal Beltech Modular A/S**  
Hjulmagervej 21  
DK-7100 Vejle

T +45 7572 3100  
F +45 7572 3348  
admin@unichains.com  
www.unichains.com

This information is subject to alteration due to continuous development. Ammeraal Beltech will not be held liable for the incorrect use of the above stated information. This information replaces previous information. All activities performed and services rendered by Ammeraal Beltech are subject to general terms and conditions of sale and delivery, as applied by its operating companies.



# Special Plastic Chain

Series **uni NH78** Type -

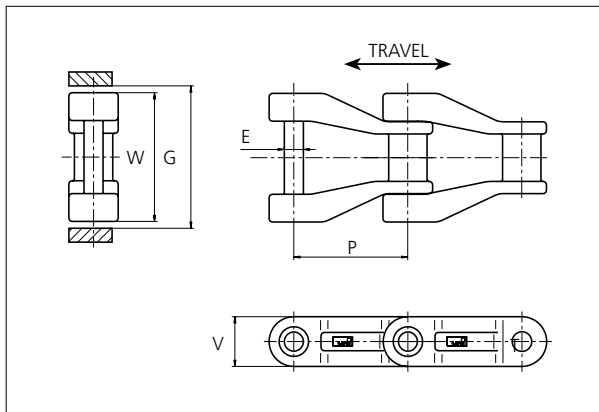

**Special Plastic Chain**  
 Straight running chain  
 Pitch: 66.3 mm (2.61 in)  
 Backflex radius: 75 mm (3 in)  
 Permissible tensile strength:  
 T1: (POM) 9000 N\* (2023 lbf)  
 T2: (POM) 7000 N (1574 lbf)  
 T3: (POM) 6000 N (1349 lbf)  
 T4: (POM) 6000 N (1349 lbf)  
 T5: (POM) 5000 N (1124 lbf)  
 \* For PA6: 7000 N (1574 lbf)  
 Delivery: 6.1 m (20 ft)  
 No. of links/box: 92

STANDARD

E		G		P		V	
mm	in	mm	in	mm	in	mm	in
11.0	0.43	78.0	3.07	66.3	2.61	28.6	1.13

All dimensions are for chains in POM material.

## Standard material & colors

	Width (W)		Material & color	Pin material	Pin fixing	Pin ø		Weight	
	mm	in				mm	in	kg/m	lb/ft
uni NH78 T1	74.0	2.91	POM-LF <span style="background-color: #c00000; color: white; padding: 2px;">BR</span> POM-D <span style="background-color: #808080; color: white; padding: 2px;">G</span>	SS304	Staked	11.0	0.43	2.1	1.41

STRAIGHT RUNNING

## Non Standard material & colors

	Width (W)		Material & color	Pin material	Pin fixing	Pin ø		Weight	
	mm	in				mm	in	kg/m	lb/ft
uni NH78 T1	74.0	2.91	POM-D <span style="background-color: #808080; color: white; padding: 2px;">G</span>	SS304	Staked	11.0	0.43	2.1	1.41
uni NH78 T2	74.0	2.91	PBT-GR <span style="background-color: #000000; color: white; padding: 2px;">K</span> PA6-GF <span style="background-color: #000000; color: white; padding: 2px;">K</span>	SS304	Staked	11.0	0.43	2.1	1.41
uni NH78 T3	74.0	2.91	PA6-GF <span style="background-color: #000000; color: white; padding: 2px;">K</span>	SS304	Staked (PE sleeve)	10.0	0.39	2.1	1.41
uni NH78 T4	74.0	2.91	PA6-GF <span style="background-color: #000000; color: white; padding: 2px;">K</span>	SS304	Cotterpin (PE sleeve)	10.0	0.39	2.1	1.41
uni NH78 T5	74.0	2.91	PP-AR <span style="background-color: #ffff00; border: 1px solid black; padding: 2px;">N</span>	SS304	Staked	11.0	0.43	2.1	1.41

PITCH 66.3 MM/2.61 IN

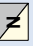

## Sprocket

No. of teeth	Pitch diameter		Overall-diameter		Min. ø bore		Max. ø bore		Hub-diameter		A-dimension		B-dimension		Molded PA66 LG	Machined PA66 
	mm	in	mm	in	mm	in	mm	in	mm	in	mm	in	mm	in		
<b>Z6</b>	132.6	5.22	137.4	5.40	20.0	0.80	40.0	1.60	65.0	2.60	43.1	1.70	80.6	3.20		x
<b>Z8</b>	173.3	6.82	182.6	7.20	20.0	0.80	40.0	1.60	65.0	2.60	65.8	2.60	100.9	4.00		x
<b>Z10</b>	214.5	8.44	226.6	8.90	20.0	0.80	50.0	2.00	73.5	2.90	87.7	3.50	121.6	4.80		x

Non standard material and color:  
See uni Material and Color Overview.

### Machined sprocket

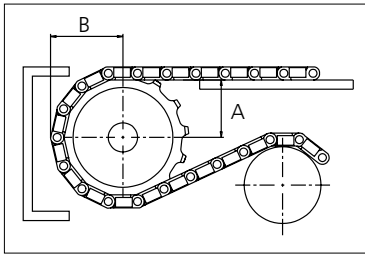

Please ensure that sufficient size shaft and keyway are chosen for corresponding load.

Other sprocket sizes are available upon request  
Width of tooth: 15.8 mm/0.62 in  
Width of sprocket: 42.3 mm/1.67 in  
uni Retainer Rings: See uni Retainer Ring data sheet

uni NH78/160107



Conveyor Belts



Seamless Belts

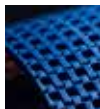

Modular Belts



Timing Belts

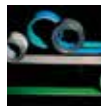

Transmission Belts



Fabrication & service

Expert advice, quality solutions and local service for all your belting needs  
[www.ammeraalbeltech.com](http://www.ammeraalbeltech.com)

**Ammeraal Beltech Modular A/S**  
Hjulmagervej 21  
DK-7100 Vejle

T +45 7572 3100  
F +45 7572 3348  
admin@unichains.com  
www.unichains.com

This information is subject to alteration due to continuous development. Ammeraal Beltech will not be held liable for the incorrect use of the above stated information. This information replaces previous information. All activities performed and services rendered by Ammeraal Beltech are subject to general terms and conditions of sale and delivery, as applied by its operating companies.



# Local Contacts

## Austria

T +43 171728 133  
info-de@ammeraalbeltech.com  
www.ammeraalbeltech.at

## Belgium

T +32 2 466 03 00  
info-be@ammeraalbeltech.com  
www.ammeraalbeltech.be

## Canada

T +1 905 890 1311  
info-ca@ammeraalbeltech.com  
www.ammeraalbeltech.com

## Chile

T +56 2 233 12900  
info-cl@ammeraalbeltech.com  
www.ammeraalbeltech.cl

## China

T +86 512 8287 2709  
info-cn@ammeraalbeltech.com  
www.ammeraalbeltech.com.cn

## Czech Republic

T +420 567 117 211  
info-cz@ammeraalbeltech.com  
www.ammeraalbeltech.cz

## Denmark

T + 45 7572 3100  
info-dk@ammeraalbeltech.com  
www.unichains.com

## Finland

T +358 207 911 400  
info-fi@ammeraalbeltech.com  
www.ammeraalbeltech.fi

## France

T +33 3 20 90 36 00  
info-fr@ammeraalbeltech.com  
www.ammeraalbeltech.fr

## Germany

T +49 4152 937-0  
info-de@ammeraalbeltech.com  
www.ammeraalbeltech.de

## Hungary

T +36 30 311 6099  
info-hu@ammeraalbeltech.com  
www.ammeraalbeltech.hu

## India

T +91 44 265 34 244  
info-in@ammeraalbeltech.com  
www.ammeraalbeltech.com

## Italy

T +39 051 660 60 06  
info-it@ammeraalbeltech.com  
www.ammeraalbeltech.it

## Luxembourg

T +352 26 48 38 56  
info-lu@ammeraalbeltech.com  
www.ammeraal-beltech.lu

## Malaysia

T +60 3 806 188 49  
info-my@ammeraalbeltech.com  
www.ammeraalbeltech.com

## Netherlands

T +31 72 57 51212  
info-nl@ammeraalbeltech.com  
www.ammeraalbeltech.nl

## Poland

T +48 32 44 77 179  
info-pl@ammeraalbeltech.com  
www.ammeraalbeltech.com

## Portugal

T +351 22 947 94 40  
info-pt@ammeraalbeltech.com  
www.ammeraalbeltech.pt

## Singapore

T +65 62739767  
info-sg@ammeraalbeltech.com  
www.ammeraalbeltech.com

## Slovakia

T +421 2 55648541-2  
info-sk@ammeraalbeltech.com  
www.ammeraalbeltech.sk

## South Korea

T +82 31 448 3613-7  
info-kr@ammeraalbeltech.com  
www.ammeraalbeltech.co.kr

## Spain

T +34 93 718 3054  
info-es@ammeraalbeltech.com  
www.ammeraalbeltech.es

## Sweden

T +46 44 780 3010  
info-se@ammeraalbeltech.com  
www.ammeraalbeltech.se

## Switzerland

T +41 55 2253 535  
info-ch@ammeraalbeltech.com  
www.ammeraalbeltech.ch

## Thailand

T +66 2 902 2604-13  
info-th@ammeraalbeltech.com  
www.ammeraalbeltech.com

## United Kingdom

T +44 1992 500550  
info-uk@ammeraalbeltech.com  
www.ammeraalbeltech.co.uk

## United States

T +1 847 673 6720  
info-us@ammeraalbeltech.com  
www.ammeraalbeltech.com

## Vietnam

T +84 8 376 562 05  
info-vn@ammeraalbeltech.com  
www.ammeraalbeltech.com.vn

## Global Headquarters:

### Ammeraal Beltech Holding B.V.

P.O. Box 38  
1700 AA Heerhugowaard  
The Netherlands

T +31 (0)72 575 1212  
F +31 (0)72 571 6455

info@ammeraalbeltech.com  
www.ammeraalbeltech.com

Expert advice, quality solutions  
and local service  
for all your belting needs

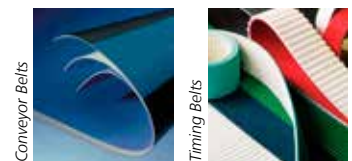

Conveyor Belts

Timing Belts

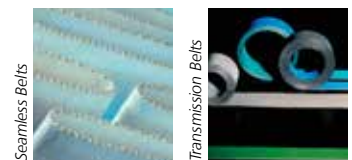

Seamless Belts

Transmission Belts



Modular Belts

Fabrication & service

... and 150 more service contact points on [www.ammeraalbeltech.com](http://www.ammeraalbeltech.com)