



Ammeraal Beltech Modular

Innovative belt and chain solutions
for every industry & application



Content

uni Flex L-OSB R2.2

page 3 - 6

uni Flex L-OSB R2.5/3.0/3.5/4.0

page 7 - 8



Plastic Modular Belt

Series **uni Flex L-OSB** Type **65% Open Radius 2.2**

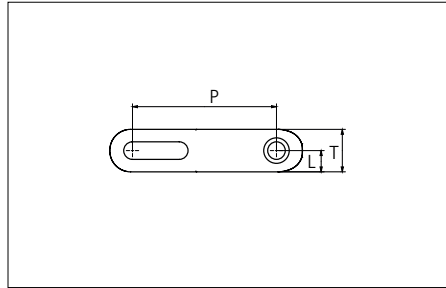

Sideflexing belt
 Nominal pitch: 50.8 mm (2.00 in)
 Surface type: Open
 Surface opening: 65%
 Backflex radius: 65.0 mm (2,56 in)
 Pin diameter: 6.0 mm (0.24 in)
 Min. inside radius: R2.2 x belt width

Belt material & color	POM-D B	PP B	mm	in		mm	in	
			P (Nominal)	50.8	2.00	T	15.0	0.59
Pin and lock material & color	PA6.6 B		L	7.5	0.29	-	-	-

Non standard material and color: See uni Material and Color Overview.

Alternative pin and lock materials:

⚡ Snap Pin A1: PP **W** PBT **LG** PA6.6 **B** ⚡ Lockpin: PBT **LG**

Belt width		Permissible tensile force (Belt/pin material)								Belt weight (Belt/pin material)				*Min. No. drive sprocket per shaft	Number of wear strips (Min. No.)	
		POM-D/PA6.6				PP/PA6.6				POM-D/PA6.6		PP/PA6.6			**Carry (pcs)	**Return (pcs)
		Straight sections		Curve sections		Straight sections		Curve sections		kg/m	lb/ft	kg/m	lb/ft			
mm	in	N	lbf	N	lbf	N	lbf	N	lbf	kg/m	lb/ft	kg/m	lb/ft			
305	12.0	5429	1220	3300	742	4087	919	2080	468	2.0	1.36	1.5	0.99	3	3	2
407	16.0	6490	1459	3300	742	4923	1107	2080	468	2.7	1.82	2.0	1.32	3	3	2
509	20.0	7551	1697	3300	742	5760	1295	2080	468	3.4	2.27	2.5	1.65	5	4	2
610	24.0	8601	1934	3300	742	6588	1481	2080	468	4.1	2.72	2.9	1.98	5	5	3
712	28.0	9662	2172	3300	742	7424	1669	2080	468	4.7	3.18	3.4	2.31	5	5	3
813	32.0	10712	2408	3300	742	8253	1855	2080	468	5.4	3.63	3.9	2.64	7	6	3
915	36.0	11773	2647	3300	742	9089	2043	2080	468	6.1	4.08	4.4	2.97	7	7	4
1016	40.0	12823	2883	3300	742	9917	2229	2080	468	6.7	4.53	4.9	3.30	7	7	4
1118	44.0	13884	3121	3300	742	10754	2417	2080	468	7.4	4.99	5.4	3.63	9	8	4
1219	48.0	14935	3357	3300	742	11582	2604	2080	468	8.1	5.44	5.9	3.96	9	9	5
1321	52.0	15995	3596	3300	742	12418	2792	2080	468	8.8	5.89	6.4	4.29	9	9	5
1422	56.0	17046	3832	3300	742	13246	2978	2080	468	9.4	6.35	6.9	4.62	11	10	5
1524	60.0	18107	4070	3300	742	14083	3166	2080	468	10.1	6.80	7.4	4.95	11	11	6
1626	64.0	19167	4309	3300	742	14919	3354	2080	468	10.8	7.26	7.9	5.28	11	11	6
1727	68.0	20218	4545	3300	742	15747	3540	2080	468	11.5	7.71	8.3	5.61	13	12	6

Additional standard belt widths are available in steps of 101.6 mm (4.00 in). Additional non-standard belt widths are available in steps of mm 50.8 (2.00 in).

1930	76.0	22329	5020	3300	742	17412	3914	2080	468	12.8	8.61	9.3	6.26	13	13	7
------	------	-------	------	------	-----	-------	------	------	-----	------	------	-----	------	----	----	---



General belt tolerance is +0/-0.4% at 23°C/73°F. For exact belt width contact Customer Service.

*Max load per Drive Sprocket. Belt material: POM-D 1000 N (225 lbf), PP 550 N (123 lbf).

**Max spacing between wear strips, Carry: 152 mm (6 in); Return: 304 mm (12 in).

Belt needs support rollers or flanged rollers at each belt edge for support.

□ = Single Link

STANDARD

SIDE FLEXING

PITCH 50.8 MM/2.00 IN

Accessories

Side Guard

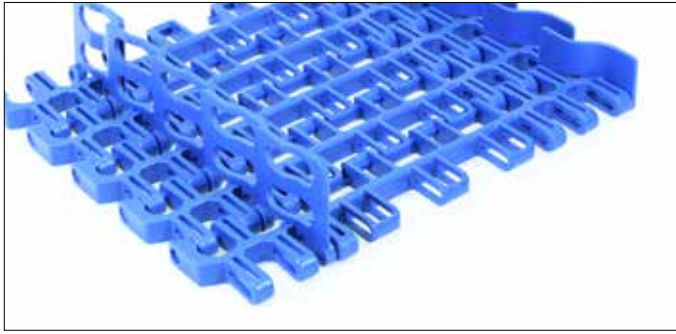

Side Guard Open

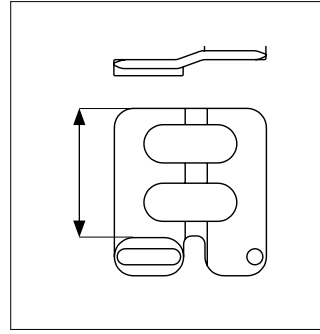

Side Guard

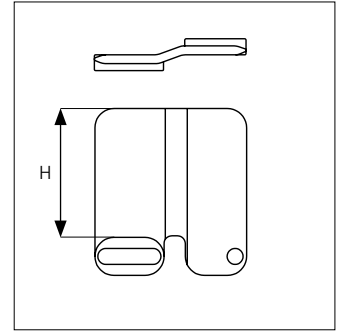

Type	Side Guard Material & color	H	
		mm	in
Side Guard	POM-D B W	10.0	0.39
		25.4	1.00
		50.0	1.97
Side Guard Open		50.0	1.97

* Min. indent for Side Guard is: 80.0 mm (3.15 in) and Increment 25.4 mm (1.00 in)
 Non Standard material and color: See uni Material and Color Overview.

Design Guidelines

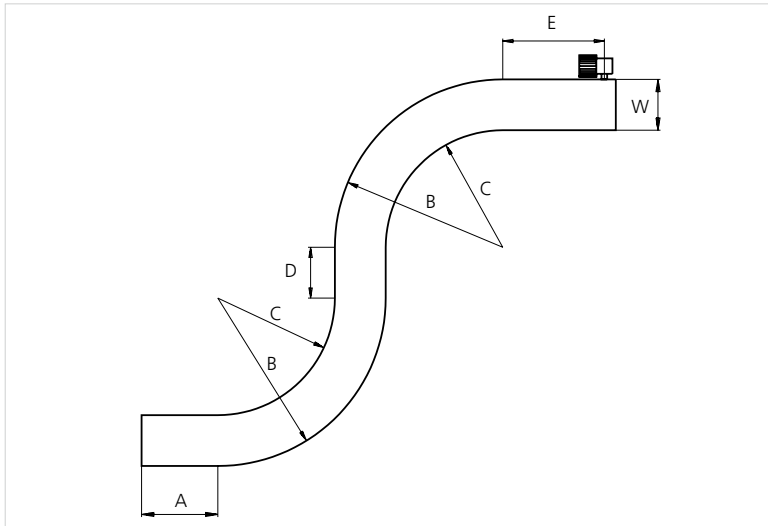

uni Flex L-OSB 65% Open Radius 2.2	
A	min. 1.5 x W
B	min 3.2 x W
C	min 2.2 x W
D	min 2 x W
E	min 2 x W, min.
W	Belt width



Conveyor Belts



Seamless Belts



Modular Belts



Timing Belts



Transmission Belts



Fabrication & service

Expert advice, quality solutions
and local service
for all your belting needs
www.ammeraalbeltech.com

Ammeraal Beltech Modular A/S
Hjulmagervej 21
DK-7100 Vejle

T +45 7572 3100
F +45 7572 3348
admin@unichains.com
www.unichains.com

This information is subject to alteration due to continuous development. Ammeraal Beltech will not be held liable for the incorrect use of the above stated information. This information replaces previous information. All activities performed and services rendered by Ammeraal Beltech are subject to general terms and conditions of sale and delivery, as applied by its operating companies.



Plastic Modular Belt

Series **uni Flex L-OSB** Type **65% Open Radius 2.5/3.0/3.5/4.0**

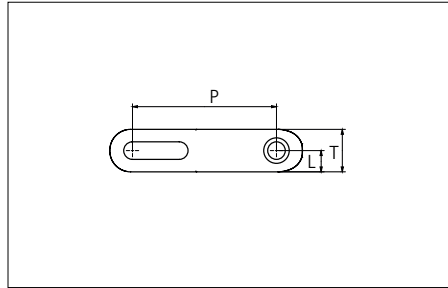
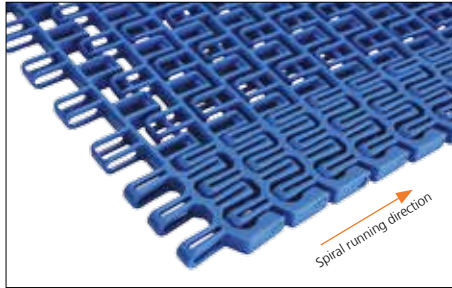

Sideflexing belt
 Nominal pitch: 50.8 mm (2.00 in)
 Surface type: Open
 Surface opening: 65%
 Backflex radius: 65.0 mm (2,56 in)
 Pin diameter: 6.0 mm (0.24 in)
 Min. inside radius:
 2.5 / 3.0 / 3.5 / 4.0 x belt width

Recommended Belt material & color	POM-D B	mm	in		mm	in	
		P (Nominal)	50.8	2.00	T	15.0	0.59
Recommended Pin material & color	PA6.6 B	L	7.5	0.29	-	-	-

Other non standard material and color: See uni Material and Color Overview.
 Alternative pin and lock: Snap Pin A1

Belt width		Permissible tensile force (Belt/pin material)								Belt weight (Belt/pin material)				*Min. No. drive sprocket per shaft	Number of wear strips (Min. No.)	
		POM-D/PA6.6				PP/PA6.6				POM-D/PA6.6		PP/PA6.6			Carry (pcs)	Return (pcs)
		Straight sections		Curve sections		Straight sections		Curve sections		kg/m	lb/ft	kg/m	lb/ft			
mm	in	N	lbf	N	lbf	N	lbf	N	lbf	kg/m	lb/ft	kg/m	lb/ft			
326	12.8	5803	1304	3300	742	4368	982	2080	468	2.2	1.45	1.6	1.06	3	2	2
428	16.9	6864	1543	3300	742	5205	1170	2080	468	2.8	1.91	2.1	1.39	3	2	2
530	20.9	7924	1781	3300	742	6041	1358	2080	468	3.5	2.37	2.6	1.72	4	2	2
631	24.8	8975	2018	3300	742	6869	1544	2080	468	4.2	2.82	3.0	2.05	4	3	3
733	28.9	10036	2256	3300	742	7706	1732	2080	468	4.9	3.27	3.5	2.38	5	3	3
834	32.8	11086	2492	3300	742	8534	1918	2080	468	5.5	3.72	4.0	2.71	5	3	3
936	36.9	12147	2731	3300	742	9370	2106	2080	468	6.2	4.18	4.5	3.04	5	3	3
1037	40.8	13197	2967	3300	742	10199	2293	2080	468	6.9	4.63	5.0	3.37	6	4	4
1139	44.8	14258	3205	3300	742	11035	2481	2080	468	7.6	5.08	5.5	3.70	6	4	4
1240	48.8	15308	3441	3300	742	11863	2667	2080	468	8.2	5.53	6.0	4.03	6	4	4
1342	52.8	16369	3680	3300	742	12700	2855	2080	468	8.9	5.99	6.5	4.36	7	5	5
1443	56.8	17420	3916	3300	742	13528	3041	2080	468	9.6	6.44	7.0	4.68	7	5	5

Additional standard belt widths are available in steps of 101.6 mm (4.00 in). Additional non-standard belt widths are available in steps of 50.8 mm (2.00 in).

General belt tolerance is +0/-0.4% at 23°C/73°F. For exact belt width contact Customer Service. Non standard belt width on request.

*Max. Load per Drive Sprocket. Belt material: POM-D 1000 N (225 lbf), PP 550 N (123 lbf).

Belt needs support rollers or flanged rollers at each belt edge for support.

= Single Link



NON STANDARD

SIDE FLEXING

PITCH 50.8 MM/2.00 IN

Accessories

Side Guard Outside Only



Side Guard Outside Only

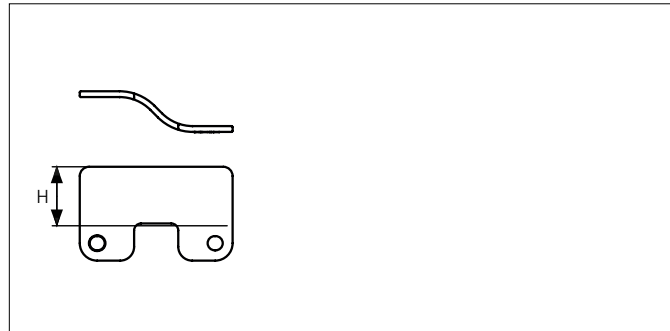

Type	Recommended Material & color	H	
		mm	in
Side Guard Outside Only	POM-D B	25.4	1.00

* Min. indent for Side Guard is: 80.0 mm (3.15 in) and Increment 25.4 mm (1.00 in)
 Non Standard material and color: See uni Material and Color Overview.

Sprocket

No. of teeth	Pilot Bore	Bore size												Overall diameter	Pitch diameter	Hub diameter	Dimension A	Dimension B	Single row/Two way	Double row/Two way	Molded PA6 LG	Machined PA6 N				
		in	0.75	0.79	0.98	1.00	1.18	1.25	1.50	1.57	2.36	2.50	3.54													
		mm	19.1	20.0	25.0	25.4	30.0	31.8	38.1	40.0	60.0	63.5	90.0													
Z08	x				●	●			●				134.6	5.30	131.5	5.18	107.6	4.23	54.4	2.15	74.9	2.95	x			x
Z10	x				●	●	●		●				168.3	6.63	164	6.46	141.3	5.56	71.4	2.81	90.8	3.57	x			x
Z12	x				●		●	●	●		■		203.5	8.01	196.5	7.74	176.5	6.94	88.2	3.47	106.8	4.20	x			x
Z15	x				●		●	●	●	●	■		253.4	9.98	245.4	9.66	226.4	8.91	113.2	4.46	131.0	5.16	x			x

■ Machined sprocket



● Machined sprocket

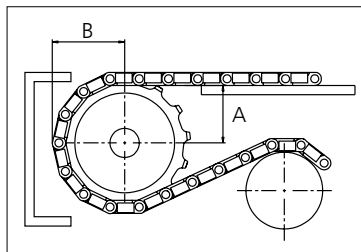
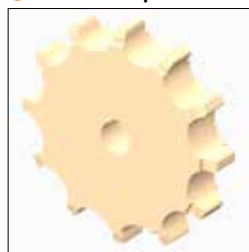

Non standard material and color: See uni Material and Color Overview.

Other sprocket sizes are available upon request
 Two-part sprocket are available upon request
 Other bore sizes are available upon request
 uni Retainer Rings: See uni Retainer Ring data sheet
 Width of tooth = 30.0 mm (1.18 in)
 Width of sprocket = 40.0 mm (1.57 in)

Max. load per sprocket shown does not take bore size into account.
 Please also ensure that sufficient size shaft is chosen for corresponding load.

For correct sprocket position: See uni Assembly Instructions for uni Flex L-OSB.
 For more detailed sprocket information, contact Customer Service.

uni Flex L-OSB 65% Open NON STANDARD/150407



Conveyor Belts



Seamless Belts



Modular Belts



Timing Belts

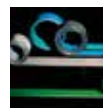

Transmission Belts



Fabrication & service

Expert advice, quality solutions and local service for all your belting needs
www.ammeraalbeltech.com

Ammeraal Beltech Modular A/S
 Hjulmagervej 21
 DK-7100 Vejle

T +45 7572 3100
 F +45 7572 3348
 admin@unichains.com
 www.unichains.com

This information is subject to alteration due to continuous development. Ammeraal Beltech will not be held liable for the incorrect use of the above stated information. This information replaces previous information. All activities performed and services rendered by Ammeraal Beltech are subject to general terms and conditions of sale and delivery, as applied by its operating companies.

Local Contacts

Austria

T +43 171728 133
info-de@ammeraalbeltech.com
www.ammeraalbeltech.at

Belgium

T +32 2 466 03 00
info-be@ammeraalbeltech.com
www.ammeraalbeltech.be

Canada

T +1 905 890 1311
info-ca@ammeraalbeltech.com
www.ammeraalbeltech.com

Chile

T +56 2 233 12900
info-cl@ammeraalbeltech.com
www.ammeraalbeltech.cl

China

T +86 512 8287 2709
info-cn@ammeraalbeltech.com
www.ammeraalbeltech.com.cn

Czech Republic

T +420 567 117 211
info-cz@ammeraalbeltech.com
www.ammeraalbeltech.cz

Denmark

T + 45 7572 3100
info-dk@ammeraalbeltech.com
www.unichains.com

Finland

T +358 207 911 400
info-fi@ammeraalbeltech.com
www.ammeraalbeltech.fi

France

T +33 3 20 90 36 00
info-fr@ammeraalbeltech.com
www.ammeraalbeltech.fr

Germany

T +49 4152 937-0
info-de@ammeraalbeltech.com
www.ammeraalbeltech.de

Hungary

T +36 30 311 6099
info-hu@ammeraalbeltech.com
www.ammeraalbeltech.hu

India

T +91 44 265 34 244
info-in@ammeraalbeltech.com
www.ammeraalbeltech.com

Italy

T +39 051 660 60 06
info-it@ammeraalbeltech.com
www.ammeraalbeltech.it

Luxembourg

T +352 26 48 38 56
info-lu@ammeraalbeltech.com
www.ammeraal-beltech.lu

Malaysia

T +60 3 806 188 49
info-my@ammeraalbeltech.com
www.ammeraalbeltech.com

Netherlands

T +31 72 57 51212
info-nl@ammeraalbeltech.com
www.ammeraalbeltech.nl

Poland

T +48 32 44 77 179
info-pl@ammeraalbeltech.com
www.ammeraalbeltech.com

Portugal

T +351 22 947 94 40
info-pt@ammeraalbeltech.com
www.ammeraalbeltech.pt

Singapore

T +65 62739767
info-sg@ammeraalbeltech.com
www.ammeraalbeltech.com

Slovakia

T +421 2 55648541-2
info-sk@ammeraalbeltech.com
www.ammeraalbeltech.sk

South Korea

T +82 31 448 3613-7
info-kr@ammeraalbeltech.com
www.ammeraalbeltech.co.kr

Spain

T +34 93 718 3054
info-es@ammeraalbeltech.com
www.ammeraalbeltech.es

Sweden

T +46 44 780 3010
info-se@ammeraalbeltech.com
www.ammeraalbeltech.se

Switzerland

T +41 55 2253 535
info-ch@ammeraalbeltech.com
www.ammeraalbeltech.ch

Thailand

T +66 2 902 2604-13
info-th@ammeraalbeltech.com
www.ammeraalbeltech.com

United Kingdom

T +44 1992 500550
info-uk@ammeraalbeltech.com
www.ammeraalbeltech.co.uk

United States

T +1 847 673 6720
info-us@ammeraalbeltech.com
www.ammeraalbeltech.com

Vietnam

T +84 8 376 562 05
info-vn@ammeraalbeltech.com
www.ammeraalbeltech.com.vn

Global Headquarters:

Ammeraal Beltech Holding B.V.

P.O. Box 38
1700 AA Heerhugowaard
The Netherlands

T +31 (0)72 575 1212
F +31 (0)72 571 6455

info@ammeraalbeltech.com
www.ammeraalbeltech.com

Expert advice, quality solutions
and local service
for all your belting needs

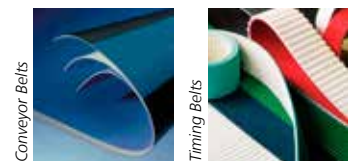

Conveyor Belts

Timing Belts

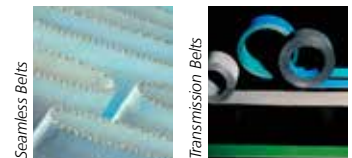

Seamless Belts

Transmission Belts



Modular Belts

Fabrication & service

... and 150 more service contact points on www.ammeraalbeltech.com