

Ammeraal Beltech Modular

Innovative belt and chain solutions
for every industry & application



Content

uni OPB 4 C	page 3 - 6
uni OPB 4 Vacuum	page 7 - 10
uni OPB 4V 23% Fine-meshed	page 11 - 14
uni OPB 4V 23% Rib	page 15 - 18
uni OPB 4V 23%	page 19 - 22
uni OPB 4V 36%	page 23 - 26
uni OPB 4V C	page 27 - 30
uni OPB 4V Rough	page 31 - 34
uni OPB 4V Vacuum	page 35 - 38
uni OPB 8 20%	page 39 - 42
uni OPB 8 25%	page 43 - 46
uni OPB 8 C	page 47 - 50
uni OPB 8M C	page 51 - 54
uni OPB 8P C	page 55 - 58
uni OPB 8 Rough	page 59 - 62



Plastic Modular Belt

Series **uni OPB 4** Type **C**

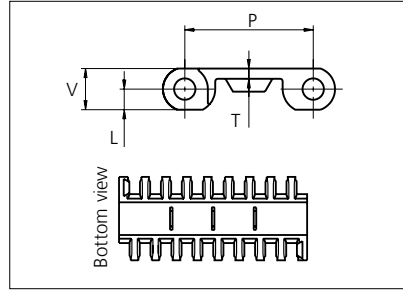

Straight running belt
 Nominal pitch: 50.0 mm (1.97 in)
 Surface type: Flat
 Surface opening: Closed
 Backflex radius: 75.0 mm (3.00 in)
 Pin diameter: ø8 mm (1.97 in)

*uni-chains recommends this travel direction. However, travel in both directions is possible.

Recommended belt material & color	POM-D W		mm	in		mm	in
		P (Nominal)	50.0	1.97	V	16.0	0.63
Recommended pin and lock material & color	PA6.6 N						
		L	8.0	0.31	T	4.0	0.16

Non standard material and color: See uni Material and Color Overview.

Alternative materials: Belt: POM-LF, POM-SLF, PP, PE, PA6.6 and PA6.6H Rodlock: PP **W** Endlock: PP **W** **G** **B** and PE **W** **B**
 Lockpin: PE **W** PA6.6 **N** PP **W** Pin: PP **W** PE **W** SS304 and SS316

Belt width		Permissible tensile force (Belt/pin material)						Belt weight (Belt/pin material)						*Min. No. drive sprocket per shaft	Number of wear strips (Min. No.)	
		POM-D/PA6.6		PP/PA6.6		PE/PA6.6		POM-D/PA6.6		PP/PA6.6		PE/PA6.6			**Carry (pcs)	**Return (pcs)
mm	in	N	lbf	N	lbf	N	lbf	kg/m	lb/ft	kg/m	lb/ft	kg/m	lb/ft			
152	6.0	1672	376	836	188	502	113	1.8	1.20	1.1	0.77	1.2	0.83	2	2	2
303	11.9	3333	749	1667	375	1000	225	3.5	2.38	2.3	1.53	2.5	1.65	3	3	2
455	17.9	5005	1125	2503	563	1502	338	5.3	3.58	3.4	2.29	3.7	2.48	4	4	2
606	23.9	6666	1499	3333	749	2000	450	7.1	4.76	4.5	3.05	4.9	3.30	5	5	3
758	29.8	8338	1874	4169	937	2501	562	8.9	5.96	5.7	3.82	6.1	4.13	6	6	3
909	35.8	9999	2248	5000	1124	3000	674	10.6	7.15	6.8	4.58	7.4	4.95	7	7	4
1061	41.8	11671	2624	5836	1312	3501	787	12.4	8.34	8.0	5.35	8.6	5.78	8	8	4
1212	47.7	13332	2997	6666	1499	4000	899	14.2	9.53	9.1	6.11	9.8	6.60	9	9	5
1364	53.7	15004	3373	7502	1686	4501	1012	16.0	10.73	10.2	6.88	11.0	7.43	10	10	5
1515	59.6	16665	3746	8333	1873	5000	1124	17.7	11.91	11.4	7.64	12.3	8.25	11	11	6
1667	65.6	18337	4122	9169	2061	5501	1237	19.5	13.11	12.5	8.40	13.5	9.07	12	12	6
1818	71.6	19998	4496	9999	2248	5999	1349	21.3	14.29	13.6	9.16	14.7	9.90	13	13	7
1970	77.6	21670	4871	10835	2436	6501	1461	23.0	15.49	14.8	9.93	16.0	10.72	14	14	7

Additional standard belt widths are available in steps of 151.5 mm (5.96 in.) Additional non-standard belt widths are available in steps of 33.5 mm (1.32 in.)

2576	101.4	28336	6370	14168	3185	8501	1911	30.1	20.26	19.3	12.98	20.9	14.02	18	18	9
------	-------	-------	------	-------	------	------	------	------	-------	------	-------	------	-------	----	----	---

Additional standard belt widths are available in steps of 151.5 mm (5.96 in.) Additional non-standard belt widths are available in steps of 33.5 mm (1.32 in.)

2879	113.3	31669	7119	15835	3560	9501	2136	33.7	22.64	21.6	14.51	23.3	15.67	20	20	10
------	-------	-------	------	-------	------	------	------	------	-------	------	-------	------	-------	----	----	----

General belt tolerance is +0/-0.4% at 23°C/73°F and 50% RH. For exact belt width contact Customer Service. Non standard belt width on request.

*Max. Load per Drive Sprocket. Belt material: POM 2500 N (562 lbf), PP 1200 N (270 lbf), PE 500 N (270 lbf)

**Max. Spacing between wear strips, Carry: 152 mm (6 in.); Return: 304 mm (12 in.)



NON STANDARD

STRAIGHT RUNNING

PITCH 50.0 MM/1.97 IN

Accessories

Rubber Top

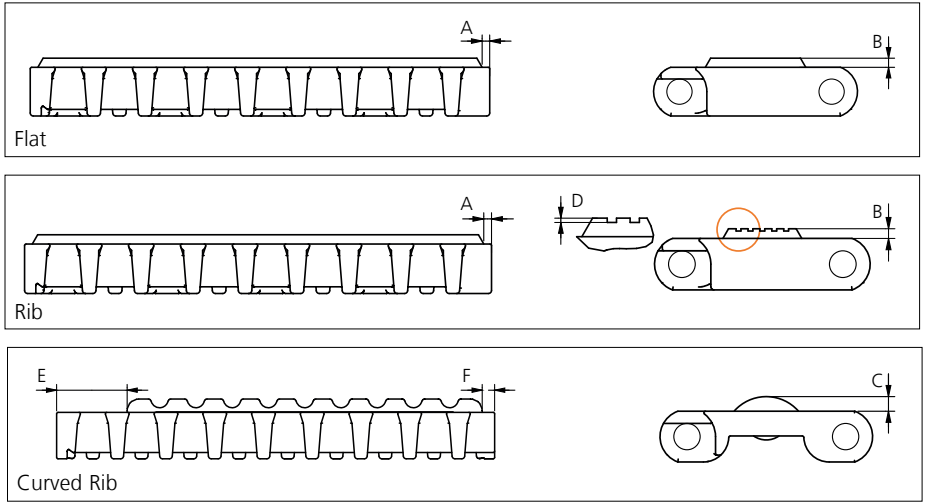

Type	Belt Material & color	Rubber Material & color	A		B		C		D		E		F		Link size	Width	
			mm	in	mm	in	mm	in	mm	in	mm	in	mm	in		mm	in
Flat	POM-LF BR	03 N															
Rib	POM-D W		2.5	0.10	3.0	0.12	4.5	0.18	0.7	0.03	24.0	0.94	4.0	0.16	K600	150.5	5.93
Curved Rib	POM-D W	03 K															

Other Non Standard Rubber profiles: See uni Rubber Profile Overview.

Accessories

Flight

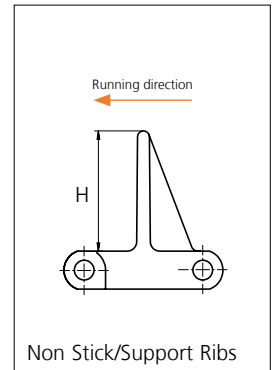
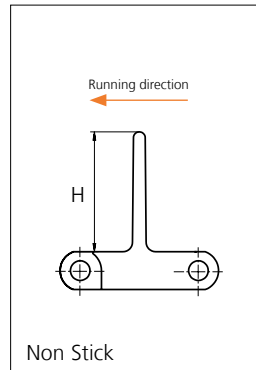

Type	Recommended Material & color	H		Link size	Width		Indent	
		mm	in		mm	in	mm	in
Non Stick	PP-HW B	50.8	2.00	K600	151.0	5.94	0.0	0.00
Non Stick/		76.2	3.00					
Support Ribs		101.6	4.00					

Non Standard material and color: See uni Material and Color Overview.

Accessories

Side Guard

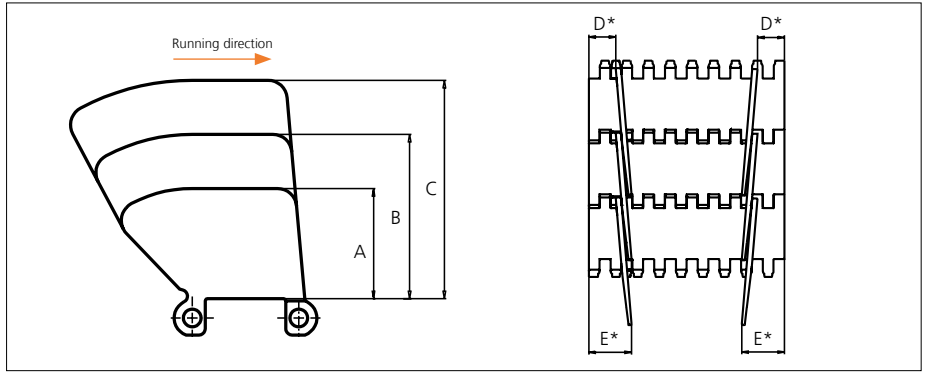

Type	Recommended Material & color	A		B		C		D*		E*	
		mm	in	mm	in	mm	in	mm	in	mm	in
Closed	PP-HW B	51.8	2.04	77.2	3.04	102.6	4.04	21.0	0.83	34.0	1.34

* Min. indent Increment : 8.4 mm (0.33 in)

Note: Backflex radius when side guard are used: 200.0 mm (7.90 in)

Non Standard material and color: See uni Material and Color Overview.

Accessories

Tab

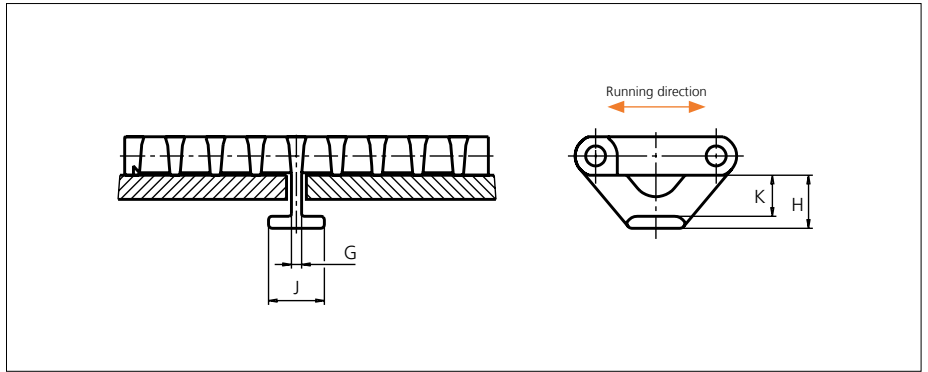

Type	Recommended Material & color	G		H		J		K	
		mm	in	mm	in	mm	in	mm	in
Bottom Hold Down	POM-D W	4.2	0.17	22.0	0.87	23.2	0.92	17.0	0.67
	POM-LF B								
	PP W								

Non Standard material and color: See uni Material and Color Overview.

Accessories

Non Standard uni AmFlight

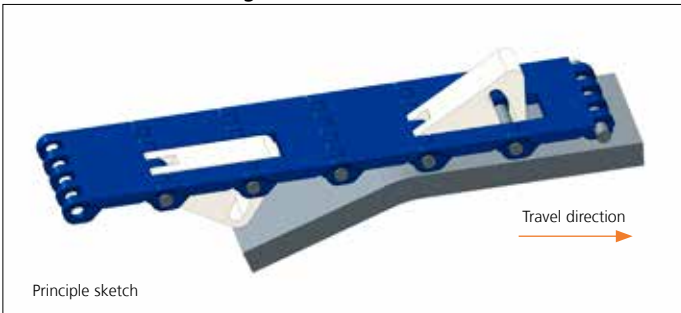

Other Non Standard option: See uni AmFlight Overview.

Sprocket

No of teeth	Bore size													Overall diameter		Pitch-diameter		Hub-diameter		A-dimension		B-dimension		Single row/Two way	Double row/Two way	Molded PA6 LG	Machined PA6 N
	Pilot Bore	in	0.75	0.78	0.98	1.00	1.18	1.25	1.50	1.57	2.36	2.50	3.54														
	mm	19.1	20.0	25.0	25.4	30.0	31.8	38.1	40.0	60.0	63.5	90.0	mm	in	mm	in	mm	in	mm	in							
Z06	x				●	●	●	■	■				94.5	3.72	100.3	3.95	65	2.56	35.5	1.40	58.6	2.31	x		x		
Z08	x				●	●	●	■	■				129	5.08	131.1	5.16	65	2.56	52.6	2.07	74	2.91	x		x		
Z10	x					●	●	■	■				160.1	6.30	162.4	6.39	65	2.56	69.2	2.72	89.7	3.53	x		x		
Z12	x					●	●	■	■				191.5	7.54	193.9	7.63	65	2.56	85.7	3.37	105.5	4.15	x		x		
Z13	x					●		■	■				207.3	8.16	209.7	8.26	72	2.83	93.8	3.69	113.4	4.46	x		x		
Z13											■		207.3	8.16	209.7	8.26	150	5.91	93.8	3.69	113.4	4.46	x			x	
Z16	x					●		■	■		■		254.8	10.03	257.3	10.13	200	7.87	118.2	4.65	137.1	5.40	x			x	

■ Molded sprocket

● Molded sprocket

■ Machined sprocket

● Machined sprocket

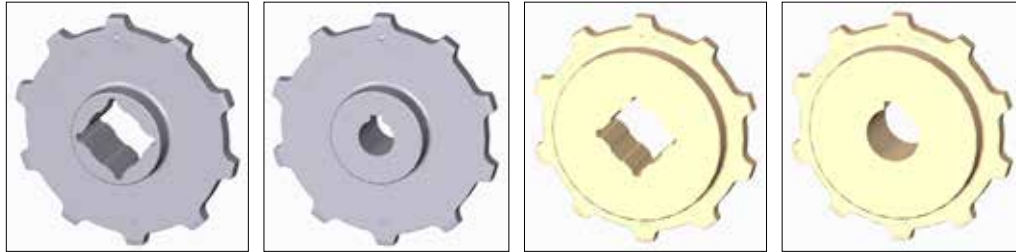

Non standard material and color: See uni Material and Color Overview.

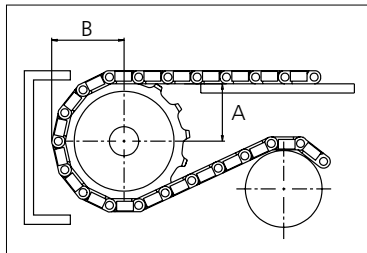

Other sprocket sizes are available upon request.
 Two-part sprocket are available upon request.
 Round bores are always delivered with keyway.
 Other bore sizes are available upon request.
 uni Retainer Rings: See uni Retainer Ring data sheet
 Width of tooth = 11.0 mm (0.43 in)
 Width of sprocket = 42.3 mm (1.67 in)

Max load per sprocket shown does not take bore size into account.
 Please also ensure that sufficient size shaft is chosen for corresponding load.

For correct sprocket position: See uni Assembly Instructions for uni OPB.
 For more detailed sprocket information, contact Customer Service.

uni OPB C 4/1301



Solid advice
 For all your belting needs
 Local stock & service
www.ammeraalbeltech.com

Ammeraal Beltech Modular A/S
 Hjulmagervej 21
 DK-7100 Vejle

T +45 7572 3100
 F +45 7572 3348
 admin@unichains.com
 www.unichains.com

This information is subject to alteration due to continuous development. Ammeraal Beltech will not be held liable for the incorrect use of the above stated information. This information replaces previous information. All activities performed and services rendered by Ammeraal Beltech are subject to general terms and conditions of sale and delivery, as applied by its operating companies.



Plastic Modular Belt

Series **uni OPB 4V** Type **Vacuum**

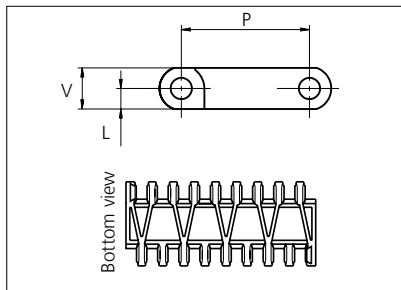

Straight running belt
 Nominal pitch: 50.0 mm (1.97 in)
 Surface type: Flat
 Surface opening: \varnothing 5.5 mm (0.22 in)
 Backflex radius: 75.0 mm (3.00 in)
 Pin diameter: \varnothing 8 mm (1.97 in)

*uni-chains recommends this travel direction. However, travel in both directions is possible.

Recommended belt material & color	POM-D W	mm	in	mm	in		
		P (Nominal)	50.0	1.97	V	16.0	0.63
Recommended pin and lock material & color	PP W	L	8.0	0.31	-	-	-

Non standard material and color: See uni Material and Color Overview.

Alternative materials: Belt: POM-LF, POM-SLF, PP, PE, PA6.6 and PA6.6H

Rodlock: PP **W**

Endlock: PP **W** **G** **B** and PE **W** **B**

Lockpin: PE **W** PA6.6 **N** PP **W**

Pin: PP **W** PE **W** SS304 and SS316

Belt width		Permissible tensile force (Belt/pin material)						Belt weight (Belt/pin material)						*Min. No. drive sprocket per shaft	Number of wear strips (Min. No.)	
		POM-D/PA6.6		PP/PA6.6		PE/PA6.6		POM-D/PA6.6		PP/PA6.6		PE/PA6.6			**Carry (pcs)	**Return (pcs)
mm	in	N	lbf	N	lbf	N	lbf	kg/m	lb/ft	kg/m	lb/ft	kg/m	lb/ft			
151	5.9	3322	747	1661	373	997	224	1.8	1.19	1.1	0.76	1.2	0.82	2	2	2
302	11.9	6644	1494	3322	747	1993	448	3.5	2.37	2.3	1.52	2.4	1.64	3	3	2
453	17.8	9966	2240	4983	1120	2990	672	5.3	3.56	3.4	2.28	3.7	2.47	4	4	2
604	23.8	13288	2987	6644	1494	3986	896	7.1	4.75	4.5	3.04	4.9	3.29	5	5	3
755	29.7	16610	3734	8305	1867	4983	1120	8.8	5.94	5.7	3.81	6.1	4.11	6	6	3
906	35.7	19932	4481	9966	2240	5980	1344	10.6	7.12	6.8	4.57	7.3	4.93	7	7	4
1057	41.6	23254	5227	11627	2614	6976	1568	12.4	8.31	7.9	5.33	8.6	5.75	8	8	4
1208	47.6	26576	5974	13288	2987	7973	1792	14.1	9.50	9.1	6.09	9.8	6.58	9	9	5
1359	53.5	29898	6721	14949	3361	8969	2016	15.9	10.69	10.2	6.85	11.0	7.40	10	10	5
1510	59.4	33220	7468	16610	3734	9966	2240	17.7	11.87	11.3	7.61	12.2	8.22	11	11	6
1661	65.4	36542	8215	18271	4107	10963	2464	19.4	13.06	12.5	8.37	13.5	9.04	12	12	6
1812	71.3	39864	8961	19932	4481	11959	2688	21.2	14.25	13.6	9.13	14.7	9.86	13	13	7
1963	77.3	43186	9708	21593	4854	12956	2912	23.0	15.44	14.7	9.89	15.9	10.69	14	14	7

Additional standard belt widths are available in steps of 151.0 mm (5.94 in.) Additional non-standard belt widths are available in steps of 33.6 mm (1.32 in.)

2567	101.1	56474	12695	28237	6348	16942	3809	30.0	20.18	19.3	12.94	20.8	13.97	18	18	9
------	-------	-------	-------	-------	------	-------	------	------	-------	------	-------	------	-------	----	----	---

Additional standard belt widths are available in steps of 151.0 mm (5.94 in.) Additional non-standard belt widths are available in steps of 33.6 mm (1.32 in.)

2869	113.0	63118	14189	31559	7094	18935	4257	33.6	22.56	21.5	14.46	23.2	15.62	20	20	10
------	-------	-------	-------	-------	------	-------	------	------	-------	------	-------	------	-------	----	----	----

General belt tolerance is +0/-0.4% at 23°C/73°F and 50% RH. For exact belt width contact Customer Service. Non standard belt width on request

*Max. Load per Drive Sprocket. Belt material: POM 2500 N (562 lbf), PP 1200 N (270 lbf), PE 500 N (270 lbf)

**Max. Spacing between wear strips, Carry: 152 mm (6 in) ; Return: 304 mm (12 in)

= Single Link



NON STANDARD

STRAIGHT RUNNING

PITCH 50.0 MM/1.97 IN

Accessories

Tab

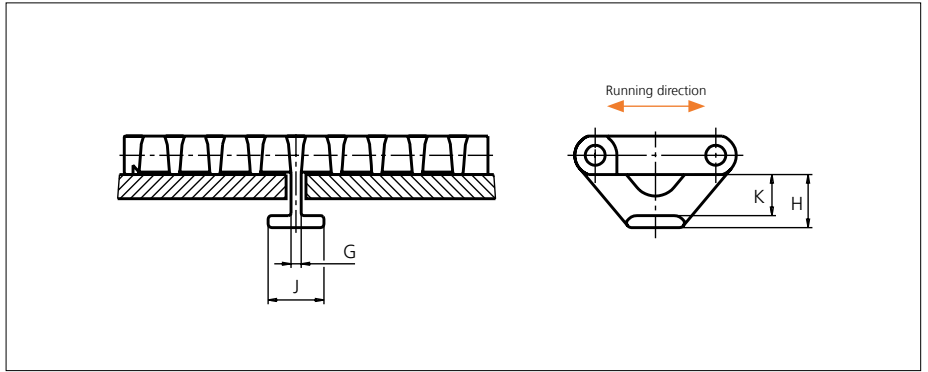

Type	Recommended material & color	G		H		J		K	
		mm	in	mm	in	mm	in	mm	in
Bottom Hold Down	POM-D W	4.2	0.17	22.0	0.87	23.2	0.92	17.0	0.67
	POM-LF B								
	PP W								

Non Standard material and color: See uni Material and Color Overview.

Sprocket

No of teeth	Bore size													Overall diameter		Pitch-diameter		Hub-diameter		A-dimension		B-dimension		Single row/Two way	Double row/Two way	Machined	
	Pilot Bore	mm	in	0.75	0.78	0.98	1.00	1.18	1.25	1.50	1.57	2.36	2.50													3.54	mm
														19.1	20.0	25.0	25.4	30.0	31.8	38.1	40.0	60.0	63.5	90.0			
Z06	x						●	●	●	■	■			94.5	3.72	100.3	3.95	65	2.56	35.5	1.40	58.6	2.31	x		x	
Z08	x						●	●	●	■	■			129	5.08	131.1	5.16	65	2.56	52.6	2.07	74	2.91	x		x	
Z10	x							●	●	■	■			160.1	6.30	162.4	6.39	65	2.56	69.2	2.72	89.7	3.53	x		x	
Z12	x							●	●	■	■			191.5	7.54	193.9	7.63	65	2.56	85.7	3.37	105.5	4.15	x		x	
Z13	x						●			■	■			207.3	8.16	209.7	8.26	72	2.83	93.8	3.69	113.4	4.46	x		x	
Z13												■		207.3	8.16	209.7	8.26	150	5.91	93.8	3.69	113.4	4.46	x			x
Z16	x						●		■	■	■		■	254.8	10.03	257.3	10.13	200	7.87	118.2	4.65	137.1	5.40	x			x

■ Molded sprocket

● Molded sprocket

■ Machined sprocket

● Machined sprocket

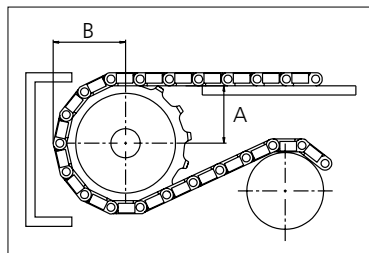
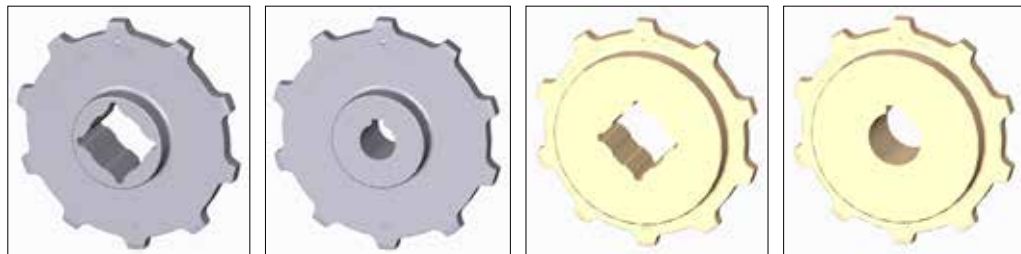

Other sprocket sizes are available upon request.
 Two-part sprocket are available upon request.
 Round bores are always delivered with keyway.
 Other bore sizes are available upon request.
 uni Retainer Rings: See uni Retainer Ring data sheet
 Width of tooth = 11.0 mm (0.43 in)
 Width of sprocket = 42.3 mm (1.67 in)

Max load per sprocket shown does not take bore size into account.
 Please also ensure that sufficient size shaft is chosen for corresponding load.

For correct sprocket position: See uni Assembly Instructions for uni OPB.
 For more detailed sprocket information, contact Customer Service.

Non standard material and color: See uni Material and Color Overview.



Conveyor



Seamless



Modular



Timing



Transmission



Fabrication & service

Solid advice
For all your belting needs
Local stock & service
www.ammeraalbeltech.com

Ammeraal Beltech Modular A/S
Hjulmagervej 21
DK-7100 Vejle

T +45 7572 3100
F +45 7572 3348
admin@unichains.com
www.unichains.com

This information is subject to alteration due to continuous development. Ammeraal Beltech will not be held liable for the incorrect use of the above stated information. This information replaces previous information. All activities performed and services rendered by Ammeraal Beltech are subject to general terms and conditions of sale and delivery, as applied by its operating companies.



Plastic Modular Belt

Serie **uni OPB 4V** Type **23% Fine-meshed**

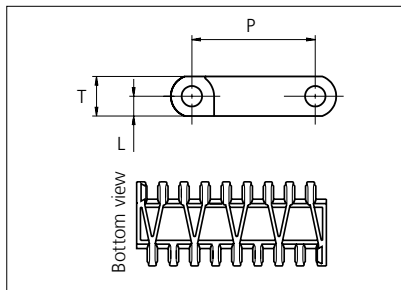

Straight running belt
 Nominal pitch: 50.0 mm (1.97 in)
 Surface type: Flat
 Surface opening: 23%
 Backflex radius: 75.0 mm (3.00 in)
 Pin diameter: 8 mm (1.97 in)

*uni-chains recommends this travel direction. However, travel in both directions is possible.

Belt material & color	PP-HW B	PP W		mm	in		mm	in	
Pin and lock material & color	PP-HW LB	PP W		P (Nominal)	50.0	1.97	T	16.0	0.63
				L	8.0	0.31	-	-	-

Non standard material and color: See uni Material and Color Overview.

Alternative pin and lock materials: Trilock: PP-HW **LB** Endlock: PP **W** **G** **B** and PE **W** **B** Lockpin: PE **W** PA6.6 **N** **B** and PBT **LG**
 Pin: PP **W** PE **W** PBT **LG** SS304 and SS316

Belt width		Permissible tensile force (Belt/pin material)				Belt weight (Belt/pin material)				*Min. No. drive sprocket per shaft	Number of wear strips (Min. No.)	
		PP-HW/PP-HW		PP/PP-HW		PP-HW/PP-HW		PP/PP-HW			**Carry (pcs)	**Return (pcs)
mm	in	N	lbf	N	lbf	kg/m	lb/ft	kg/m	lb/ft			
118	4.6	1296	291	1296	291	0.8	0.54	0.8	0.54	2	2	2
152	6.0	1672	376	1672	376	1.0	0.69	1.0	0.69	2	2	2
186	7.3	2046	460	2046	460	1.3	0.85	1.3	0.85	2	2	2
303	11.9	3333	749	3333	749	2.1	1.38	2.1	1.38	3	3	2
455	17.9	5005	1125	5005	1125	3.1	2.08	3.1	2.08	4	4	2
606	23.9	6666	1499	6666	1499	4.1	2.77	4.1	2.77	5	5	3
758	29.8	8338	1874	8338	1874	5.2	3.46	5.2	3.46	6	6	3
909	35.8	9999	2248	9999	2248	6.2	4.15	6.2	4.15	7	7	4
1061	41.8	11671	2624	11671	2624	7.2	4.85	7.2	4.85	8	8	4
1212	47.7	13332	2997	13332	2997	8.2	5.54	8.2	5.54	9	9	5
1364	53.7	15004	3373	15004	3373	9.3	6.23	9.3	6.23	10	10	5
1515	59.6	16665	3746	16665	3746	10.3	6.92	10.3	6.92	11	11	6
1667	65.6	18337	4122	18337	4122	11.3	7.62	11.3	7.62	12	12	6

Additional standard belt widths are available in steps of 151.5 mm (5.96 in). Additional non-standard belt widths are available in steps of 33.7 mm (1.33 in).

2576	101.4	28336	6370	28336	6370	17.5	11.77	17.5	11.77	18	18	9
------	-------	-------	------	-------	------	------	-------	------	-------	----	----	---

Additional standard belt widths are available in steps of 151.5 mm (5.96 in). Additional non-standard belt widths are available in steps of 33.7 mm (1.33 in).

2879	113.3	31669	7119	31669	7119	19.6	13.16	19.6	13.16	20	20	10
------	-------	-------	------	-------	------	------	-------	------	-------	----	----	----

General belt tolerance is +0/-0.4% at 23°C/73°F and 50% RH. For exact belt width contact Customer Service. Non standard belt width on request.

Belt widths in PP-HW is 0.4 % wider than the belt widths in the table above.

*Max. Load per Drive Sprocket. Belt material: POM 2500 N (562 lbf), PP 1200 N (270 lbf), PE 500 N (270 lbf)

**Max. Spacing between wear strips, Carry: 152 mm (6 in); Return: 304 mm (12 in)

= Single Link



STANDARD

STRAIGHT RUNNING

PITCH 50.0 MM/1.97 IN

Accessories

Flight

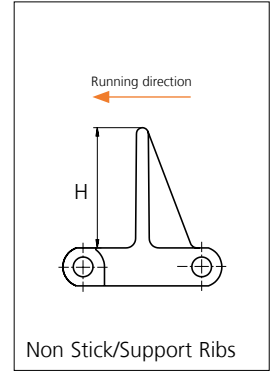
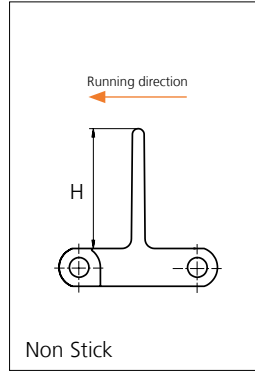

Type	Flight material & color	H		Link size	Width		Indent	
		mm	in		mm	in	mm	in
Non Stick	PP-HW B PP W	50.8	2.00	K600	151.0	5.94	0.0	0.00
Non Stick/ Support Ribs		76.2	3.00					
		101.6	4.00					

Non Standard material and color: See uni Material and Color Overview.

Accessories

Side Guard

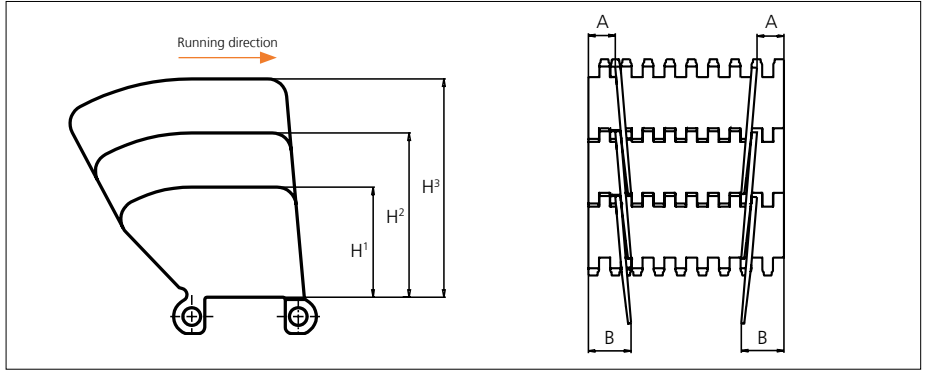

Type	Material & color	H ¹		H ²		H ³		A*		B*	
		mm	in	mm	in	mm	in	mm	in	mm	in
Closed	PP-HW B PP W	51.8	2.04	77.2	3.04	102.6	4.04	21.0	0.83	34.0	1.34

* Min. indent Increment : 8.4 mm (0.33 in).

Note: Backflex radius when side guards are used: 200.0 mm (7.90 in)

Non Standard material and color: See uni Material and Color Overview.

Accessories

Tab/NON STANDARD

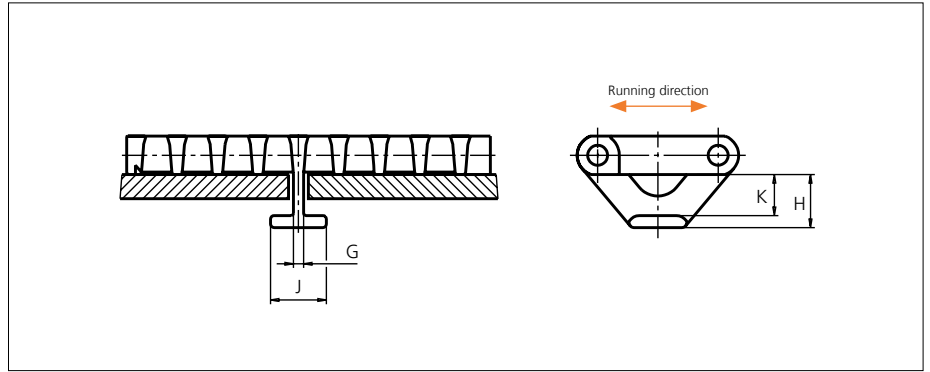

Type	Belt material & color	G		H		J		K	
		mm	in	mm	in	mm	in	mm	in
Bottom Hold Down	POM-D W	4.2	0.17	22.0	0.87	23.2	0.92	17.0	0.67
	POM-LF B								
	PP W								

Non Standard material and color: See uni Material and Color Overview.

Accessories

Reinforcement Link

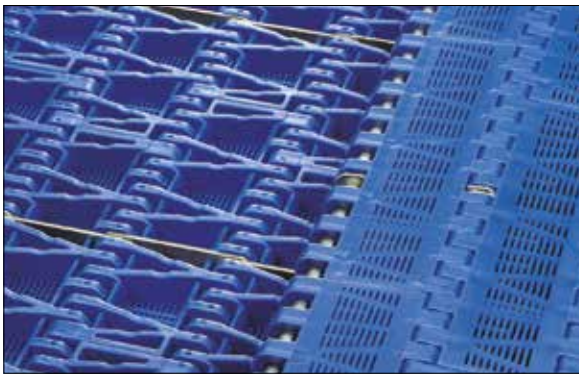

The use of uni-chains belts with the SS reinforcement /pitch control links in blanchers, cookers and other high temperature applications will reduce belt elongation due to temperature by more than 90%. This will simplify the belt take-up system and reduce maintenance.

uni-chains recommends one reinforcement link per K600 module.

Type	Material & color	N/row	Lbf/row
Steel Link	SS316	2500	562

Note: Reinforcement links require the use of SS pins.

Non Standard material and color: See uni Material and Color Overview.

Sprocket

No of teeth	Bore size													Overall diameter		Pitch-diameter		Hub-diameter		A-dimension		B-dimension		Single row/Two way	Double row/Two way	Molded PA6 LG	Machined PA6 N
	Pilot Bore	in	0.75	0.78	0.98	1.00	1.18	1.25	1.50	1.57	2.36	2.50	3.54														
	mm	19.1	20.0	25.0	25.4	30.0	31.8	38.1	40.0	60.0	63.5	90.0	mm	in	mm	in	mm	in	mm	in							
Z06	x				●	●	●	■	■				94.5	3.72	100.3	3.95	65	2.56	35.5	1.40	58.6	2.31	x		x		
Z08	x				●	●	●	■	■				129	5.08	131.1	5.16	65	2.56	52.6	2.07	74	2.91	x		x		
Z10	x					●	●	■	■				160.1	6.30	162.4	6.39	65	2.56	69.2	2.72	89.7	3.53	x		x		
Z12	x					●	●	■	■				191.5	7.54	193.9	7.63	65	2.56	85.7	3.37	105.5	4.15	x		x		
Z13	x					●		■	■				207.3	8.16	209.7	8.26	72	2.83	93.8	3.69	113.4	4.46	x		x		
Z13													207.3	8.16	209.7	8.26	150	5.91	93.8	3.69	113.4	4.46	x			x	
Z16	x					●		■	■				254.8	10.03	257.3	10.13	200	7.87	118.2	4.65	137.1	5.40	x			x	

■ Molded sprocket

● Molded sprocket

■ Machined sprocket

● Machined sprocket

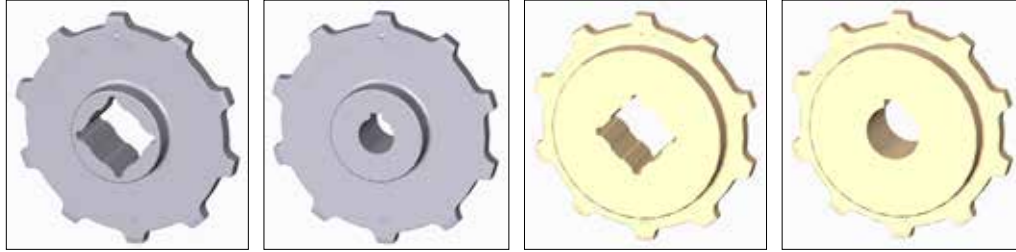

Non standard material and color: See uni Material and Color Overview.

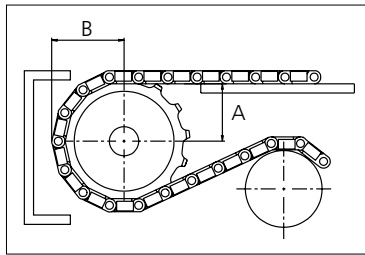

Other sprocket sizes are available upon request.
 Two-part sprocket are available upon request.
 Round bores are always delivered with keyway.
 Other bore sizes are available upon request
 uni Retainer Rings: See uni Retainer Ring data sheet
 Width of tooth = 11.0 mm (0.43 in)
 Width of sprocket = 42.3 mm (1.67 in)

Max load per sprocket shown does not take bore size into account.
 Please also ensure that sufficient size shaft is chosen for corresponding load.

For correct sprocket position: See uni Assembly Instructions for uni OPB.
 For more detailed sprocket information. contact Customer Service.

uni OPB 4V 23% Fine Meshed /150819



Expert advice, quality solutions and local service for all your belting needs
www.ammeraalbeltech.com

Ammeraal Beltech Modular A/S
 Hjulmagervej 21
 DK-7100 Vejle

T +45 7572 3100
 F +45 7572 3348
 admin@unichains.com
 www.unichains.com

This information is subject to alteration due to continuous development. Ammeraal Beltech will not be held liable for the incorrect use of the above stated information. This information replaces previous information. All activities performed and services rendered by Ammeraal Beltech are subject to general terms and conditions of sale and delivery, as applied by its operating companies.



Plastic Modular Belt

Serie **uni OPB 4V** Type **23% Rib**

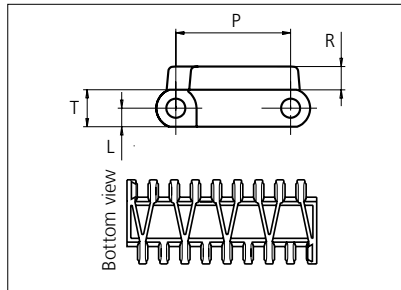

Straight running belt
 Nominal pitch: 50.0 mm (1.97 in)
 Surface type: Rib Top
 Surface opening: 23%
 Backflex radius: 300.0 mm (11.80 in)
 Pin diameter: ø8 mm (1.97 in)

*uni-chains recommends this travel direction. However, travel in both directions is possible.

Note: uni OPB 36% 4V are listed in the USDA "Accepted Meat and Poultry Equipment" publication as accepted food contact.

Belt material & color	PP-HW LB	PP G	mm		in	
			T	L	P (Nominal)	R
Pin and lock material & color	PP-HW LB	PP W	16.0	8.0	0.63	0.31

Non standard material and color: See uni Material and Color Overview.

Alternative pin and lock materials: Trilock: PP-HW **LB** Endlock: PP **W** **G** **B** PE **W** **B** Lockpin: PP **W** PE **W** PA6.6 **N** **B** PBT **LG**
 Pin: PP **W** PE **W** PBT **LG** SS304 and SS316

Belt width		Permissible tensile force (Belt/pin material)		Belt weight (Belt/pin material)		*Min. No. drive sprocket per shaft	Number of wear strips (Min. No.)	
		PP-HW/PP-HW		PP-HW/PP-HW			**Carry (pcs)	**Return (pcs)
mm	in	N	lbf	kg/m	lb/ft			
152	6.0	1672	376	1.5	0.99	2	2	2
303	11.9	3333	749	2.9	1.98	3	3	2
455	17.9	5005	1125	4.4	2.97	4	4	2
606	23.9	6666	1499	5.9	3.95	5	5	3
758	29.8	8338	1874	7.4	4.94	6	6	3
909	35.8	9999	2248	8.8	5.93	7	7	4
1061	41.8	11671	2624	10.3	6.92	8	8	4
1212	47.7	13332	2997	11.8	7.90	9	9	5
1364	53.7	15004	3373	13.2	8.89	10	10	5
1515	59.6	16665	3746	14.7	9.88	11	11	6
1667	65.6	18337	4122	16.2	10.87	12	12	6
1818	71.6	19998	4496	17.6	11.85	13	13	7

Additional standard belt widths are available in steps of 151.5 mm (5.96 in.) Additional non-standard belt widths are available in steps of 33.5 mm (1.32 in.)

2576	101.4	28336	6370	25.0	16.79	18	18	9
------	-------	-------	------	------	-------	----	----	---

Additional standard belt widths are available in steps of 151.5 mm (5.96 in.) Additional non-standard belt widths are available in steps of 33.5 mm (1.32 in.)

2879	113.3	31669	7119	27.9	18.77	20	20	10
------	-------	-------	------	------	-------	----	----	----

General belt tolerance is +0/-0.4% at 23°C/73°F and 50% RH. For exact belt width contact Customer Service. Non standard belt width on request.

*Max. Load per Drive Sprocket. Belt material: POM 2500 N (562 lbf), PP 1200 N (270 lbf), PE 500 N (270 lbf)

**Max. Spacing between wear strips, Carry: 152 mm (6 in.); Return: 304 mm (12 in.)



STANDARD

STRAIGHT RUNNING

PITCH 50.0 MM/1.97 IN

Accessories

Finger Plates

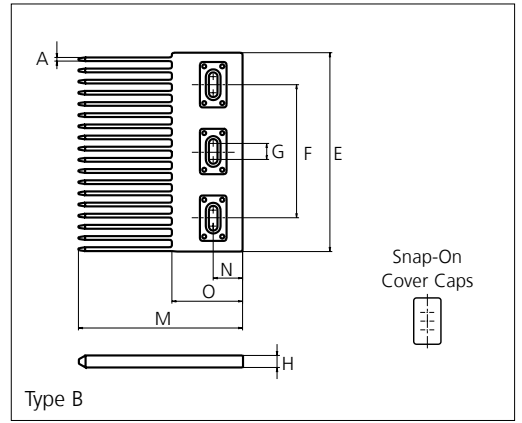
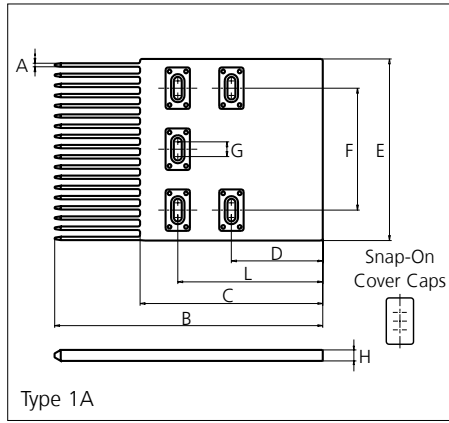

Type	Material & color	A		B		C		D		E					
		mm	in	mm	in	mm	in	mm	in	mm	in				
Single Sided	POM-DI G	2.8	0.11	220.0	8.66	150.0	5.91	75.0	2.95	149.0	5.87				
Single Sided															
		F		G		H		L		M		N		O	
		mm	in	mm	in	mm	in	mm	in	mm	in	mm	in	mm	in
		100.0	3.94	12.0	0.47	9.0	0.35	119.0	4.69	123.0	4.84	22.0	0.87	53.0	2.09

All uni-chains belt systems are available in a raised rib version that can be supplied with matching finger plates, also called combs.

The finger plates are supplied with cover caps which can be attached when the finger plate has been installed. The cover caps can be removed by using a screwdriver that can be inserted between the cover and finger plate. In order to adjust to belt width variations caused by temperature fluctuations, a slider facilitates the sideways movement of the finger plates.

Non Standard material and color: See uni Material and Color Overview.

Sprocket

No of teeth	Bore size													Overall diameter		Pitch-diameter		Hub-diameter		A-dimension		B-dimension		Single row/Two way	Double row/Two way	Molded PA6 LG	Machined PA6 N
	Pilot Bore		0.75	0.78	0.98	1.00	1.18	1.25	1.50	1.57	2.36	2.50	3.54														
	mm	in																									
Z06	x					●	●	●	■	■				94.5	3.72	100.3	3.95	65	2.56	35.5	1.40	58.6	2.31	x		x	
Z08	x					●	●	●	■	■				129	5.08	131.1	5.16	65	2.56	52.6	2.07	74	2.91	x		x	
Z10	x						●	●	■	■				160.1	6.30	162.4	6.39	65	2.56	69.2	2.72	89.7	3.53	x		x	
Z12	x						●	●	■	■				191.5	7.54	193.9	7.63	65	2.56	85.7	3.37	105.5	4.15	x		x	
Z13	x						●		■	■				207.3	8.16	209.7	8.26	72	2.83	93.8	3.69	113.4	4.46	x		x	
Z13														207.3	8.16	209.7	8.26	150	5.91	93.8	3.69	113.4	4.46	x			x
Z16	x						●		■	■				254.8	10.03	257.3	10.13	200	7.87	118.2	4.65	137.1	5.40	x			x

■ Molded sprocket

● Molded sprocket

■ Machined sprocket

● Machined sprocket

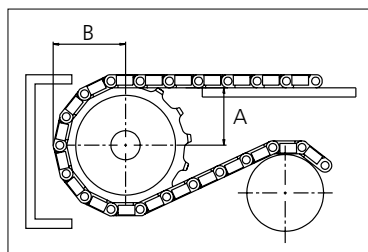
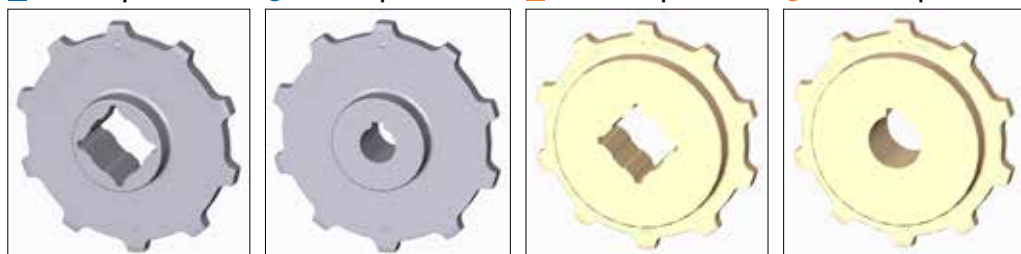

Other sprocket sizes are available upon request.
 Two-part sprocket are available upon request.
 Round bores are always delivered with keyway.
 Other bore sizes are available upon request.
 uni Retainer Rings: See uni Retainer Ring data sheet
 Width of tooth = 11.0 mm (0.43 in)
 Width of sprocket = 42.3 mm (1.67 in)

Max load per sprocket shown does not take bore size into account.
 Please also ensure that sufficient size shaft is chosen for corresponding load.

For correct sprocket position: See uni Assembly Instructions for uni OPB.
 For more detailed sprocket information, contact Customer Service.

Non standard material and color: See uni Material and Color Overview.



Conveyor



Seamless



Modular



Timing



Transmission



Fabrication & service

Solid advice
For all your belting needs
Local stock & service
www.ammeraalbeltech.com

Ammeraal Beltech Modular A/S
Hjulmagervej 21
DK-7100 Vejle

T +45 7572 3100
F +45 7572 3348
admin@unichains.com
www.unichains.com

This information is subject to alteration due to continuous development. Ammeraal Beltech will not be held liable for the incorrect use of the above stated information. This information replaces previous information. All activities performed and services rendered by Ammeraal Beltech are subject to general terms and conditions of sale and delivery, as applied by its operating companies.



Plastic Modular Belt

Serie **uni OPB 4V** Type **23%**

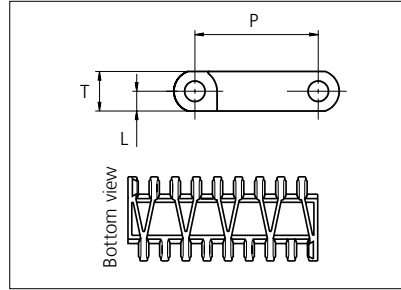
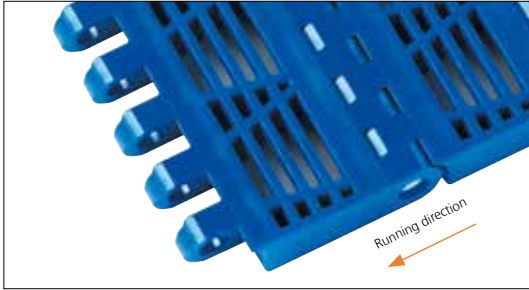

Straight running belt
 Nominal pitch: 50.0 mm (1.97 in)
 Surface type: Flat
 Surface opening: 23%
 Backflex radius: 75.0 mm (3.00 in)
 Pin diameter: ø8 mm (1.97 in)

*uni-chains recommends this travel direction. However, travel in both directions is possible.

Note: uni OPB 36% 4V are listed in the USDA "Accepted Meat and Poultry Equipment" publication as accepted food contact.

Belt material & color	PP-HW B	mm	in	mm	in
Pin and lock material & color	PP-HW LB	P (Nominal)	50.0	1.97	T
		L	8.0	0.31	-
					16.0
					0.63

Non standard material and color: See uni Material and Color Overview.

Alternative pin and lock materials: Trilock: PP-HW **LB** Endlock: PP **W** **G** **B** and PE **W** **B** Lockpin: PE **W** PA6.6 **N** **B** and PBT **LG**
 Pin: PP **W** PE **W** PBT **LG** SS304 and SS316

Belt width		Permissible tensile force (Belt/pin material)		Belt weight (Belt/pin material)		*Min. No. drive sprocket per shaft	Number of wear strips (Min. No.)	
		PP-HW/PP-HW		PP-HW/PP-HW			**Carry (pcs)	**Return (pcs)
mm	in	N	lbf	kg/m	lb/ft			
152	6.0	1672	376	1.0	0.69	2	2	2
303	11.9	3333	749	2.1	1.38	3	3	2
455	17.9	5005	1125	3.1	2.08	4	4	2
606	23.9	6666	1499	4.1	2.77	5	5	3
758	29.8	8338	1874	5.2	3.46	6	6	3
909	35.8	9999	2248	6.2	4.15	7	7	4
1061	41.8	11671	2624	7.2	4.85	8	8	4
1212	47.7	13332	2997	8.2	5.54	9	9	5
1364	53.7	15004	3373	9.3	6.23	10	10	5
1515	59.6	16665	3746	10.3	6.92	11	11	6
1667	65.6	18337	4122	11.3	7.62	12	12	6
1818	71.6	19998	4496	12.4	8.31	13	13	7

Additional standard belt widths are available in steps of 151.5 mm (5.96 in.) Additional non-standard belt widths are available in steps of 33.5 mm (1.32 in.)

2576	101.4	28336	6370	17.5	11.77	18	18	9
------	-------	-------	------	------	-------	----	----	---

Additional standard belt widths are available in steps of 151.5 mm (5.96 in.) Additional non-standard belt widths are available in steps of 33.5 mm (1.32 in.)

2879	113.3	31669	7119	19.6	13.16	20	20	10
------	-------	-------	------	------	-------	----	----	----

General belt tolerance is +0/-0.4% at 23°C/73°F and 50% RH. For exact belt width contact Customer Service. Non standard belt width on request.

*Max. Load per Drive Sprocket. Belt material: POM 2500 N (562 lbf), PP 1200 N (270 lbf), PE 500 N (270 lbf)

**Max. Spacing between wear strips, Carry: 152 mm (6 in.) ; Return: 304 mm (12 in.)



STANDARD

STRAIGHT RUNNING

PITCH 50.0 MM/1.97 IN

Accessories

Flight

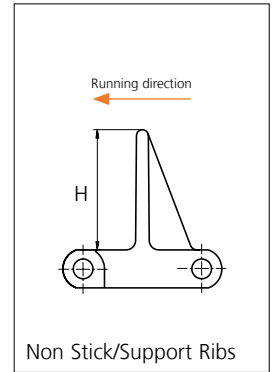
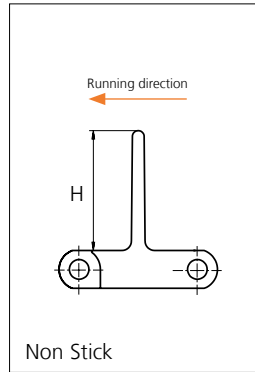

Type	Flight material & color	H		Link size	Width		Indent	
		mm	in		mm	in	mm	in
Non Stick	PP-HW B	50.8	2.00	K600	151.0	5.94	0.0	0.00
Non Stick/ Support Ribs		76.2	3.00					
		101.6	4.00					

Non Standard material and color: See uni Material and Color Overview.

Accessories

Side Guard

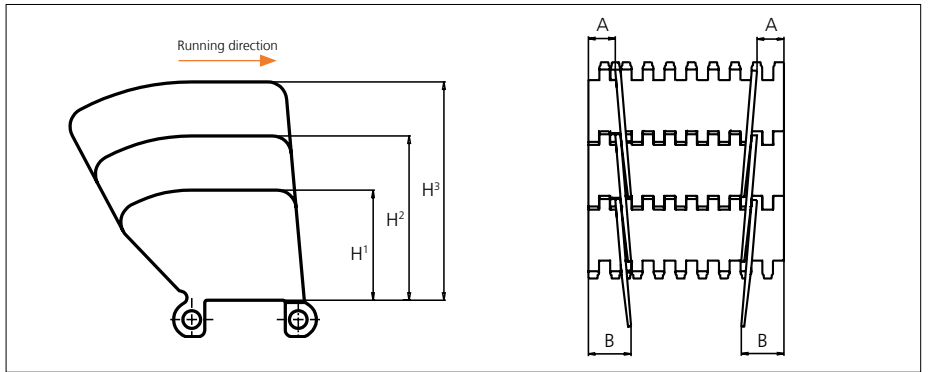

Type	Material & color	H ¹		H ²		H ³		A*		B*	
		mm	in	mm	in	mm	in	mm	in	mm	in
Closed	PP-HW B	51.8	2.04	77.2	3.04	102.6	4.04	21.0	0.83	34.0	1.34

* Min. indent Increment : 8.4 mm (0.33 in)

Note: Backflex radius when side guards are used: 200.0 mm (7.90 in)

Non Standard material and color: See uni Material and Color Overview.

Accessories

Tab/NON STANDARD

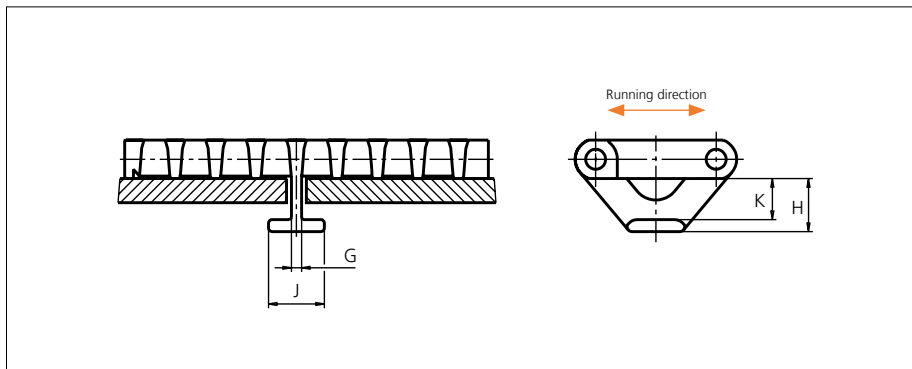

Type	Belt material & color	G		H		J		K	
		mm	in	mm	in	mm	in	mm	in
Bottom Hold Down	POM-D W	4.2	0.17	22.0	0.87	23.2	0.92	17.0	0.67
	POM-LF B								
	POM-D W								

Non Standard material and color: See uni Material and Color Overview.

Accessories

Reinforcement Link

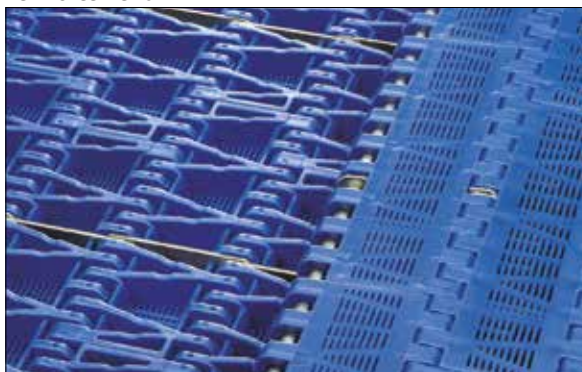

The use of uni-chains belts with the SS reinforcement /pitch control links in blanchers, cookers and other high temperature applications will reduce belt elongation due to temperature by more than 90%. This will simplify the belt take-up system and reduce maintenance.

uni-chains recommends one reinforcement link per K600 module.

Type	Material & color	N/row	Lbf/row
Steel Link	SS316	2500	562

Note: Reinforcement links require the use of SS pins.

Non Standard material and color: See uni Material and Color Overview.

Sprocket

No of teeth	Bore size													Overall diameter		Pitch-diameter		Hub-diameter		A-dimension		B-dimension		Single row/Two way	Double row/Two way	Molded PA6 LG	Machined PA6 N
	Pilot Bore	in	0.75	0.78	0.98	1.00	1.18	1.25	1.50	1.57	2.36	2.50	3.54														
	mm	19.1	20.0	25.0	25.4	30.0	31.8	38.1	40.0	60.0	63.5	90.0	mm	in	mm	in	mm	in	mm	in							
Z06	x				●	●	●	■	■				94.5	3.72	100.3	3.95	65	2.56	35.5	1.40	58.6	2.31	x		x		
Z08	x				●	●	●	■	■				129	5.08	131.1	5.16	65	2.56	52.6	2.07	74	2.91	x		x		
Z10	x					●	●	■	■				160.1	6.30	162.4	6.39	65	2.56	69.2	2.72	89.7	3.53	x		x		
Z12	x					●	●	■	■				191.5	7.54	193.9	7.63	65	2.56	85.7	3.37	105.5	4.15	x		x		
Z13	x					●		■	■				207.3	8.16	209.7	8.26	72	2.83	93.8	3.69	113.4	4.46	x		x		
Z13											■		207.3	8.16	209.7	8.26	150	5.91	93.8	3.69	113.4	4.46	x			x	
Z16	x					●		■	■		■		254.8	10.03	257.3	10.13	200	7.87	118.2	4.65	137.1	5.40	x			x	

■ Molded sprocket

● Molded sprocket

■ Machined sprocket

● Machined sprocket

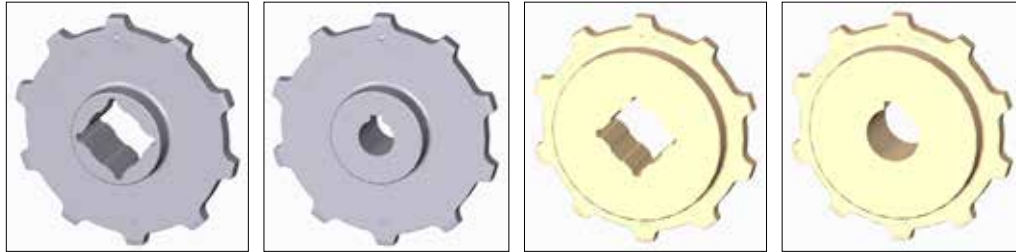

Non standard material and color: See uni Material and Color Overview.

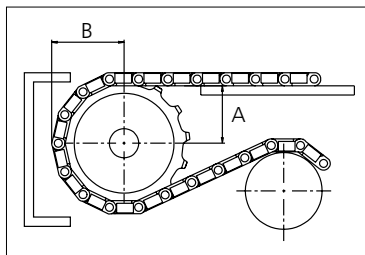

Other sprocket sizes are available upon request.
 Two-part sprocket are available upon request.
 Round bores are always delivered with keyway.
 Other bore sizes are available upon request.
 uni Retainer Rings: See uni Retainer Ring data sheet
 Width of tooth = 11.0 mm (0.43 in)
 Width of sprocket = 42.3 mm (1.67 in)

Max load per sprocket shown does not take bore size into account.
 Please also ensure that sufficient size shaft is chosen for corresponding load.

For correct sprocket position: See uni Assembly Instructions for uni OPB.
 For more detailed sprocket information. contact Customer Service.

uni OPB 4V 23%/1301



Solid advice
 For all your belting needs
 Local stock & service
www.ammeraalbeltech.com

Ammeraal Beltech Modular A/S
 Hjulmagervej 21
 DK-7100 Vejle

T +45 7572 3100
 F +45 7572 3348
 admin@unichains.com
 www.unichains.com

This information is subject to alteration due to continuous development. Ammeraal Beltech will not be held liable for the incorrect use of the above stated information. This information replaces previous information. All activities performed and services rendered by Ammeraal Beltech are subject to general terms and conditions of sale and delivery, as applied by its operating companies.



Plastic Modular Belt

Serie **uni OPB 4V** Type **36%**

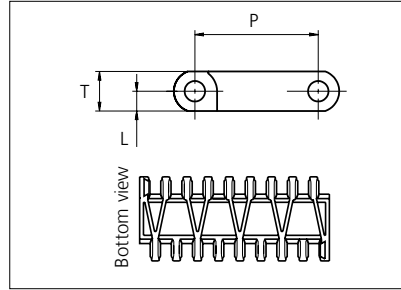

Straight running belt
 Nominal pitch: 50.0 mm (1.97 in)
 Surface type: Flat
 Surface opening: 36%
 Backflex radius: 75.0 mm (3.00 in)
 Pin diameter: ø8 mm (1.97 in)

*uni-chains recommends this travel direction. However, travel in both directions is possible.

Note: uni OPB 36% 4V are listed in the USDA "Accepted Meat and Poultry Equipment" publication as accepted food contact.

Belt material & color	PP W	mm	in		mm	in	
Pin and lock material & color	PP W	P (Nominal)	50.0	1.97	T	16.0	0.63
		L	8.0	0.31	-	-	-

Non standard material and color: See uni Material and Color Overview.

Alternative pin and lock materials: Trilock: PP-HW **LB** Endlock: PP **W** **G** **B** and PE **W** **B** Lockpin: PE **W** PA6.6 **N** **B** and PBT **LG**
 Pin: PP **W** PE **W** PBT **LG** SS304 and SS316

Belt width		Permissible tensile force (Belt/pin material)		Belt weight (Belt/pin material)		*Min. No. drive sprocket per shaft	Number of wear strips (Min. No.)	
		PP/PP		PP/PP			**Carry (pcs)	**Return (pcs)
mm	in	N	lbf	kg/m	lb/ft			
152	6.0	1672	376	1.0	0.65	2	2	2
303	11.9	3333	749	1.9	1.30	3	3	2
455	17.9	5005	1125	2.9	1.96	4	4	2
606	23.9	6666	1499	3.9	2.61	5	5	3
758	29.8	8338	1874	4.9	3.26	6	6	3
909	35.8	9999	2248	5.8	3.91	7	7	4
1061	41.8	11671	2624	6.8	4.56	8	8	4
1212	47.7	13332	2997	7.8	5.21	9	9	5
1364	53.7	15004	3373	8.7	5.87	10	10	5
1515	59.6	16665	3746	9.7	6.52	11	11	6
1667	65.6	18337	4122	10.7	7.17	12	12	6
1818	71.6	19998	4496	11.6	7.82	13	13	7

Additional standard belt widths are available in steps of 151.5 mm (5.96 in.) Additional non-standard belt widths are available in steps of 33.5 mm (1.32 in.)

2576	101.4	28336	6370	16.5	11.08	18	18	9
------	-------	-------	------	------	-------	----	----	---

Additional standard belt widths are available in steps of 151.5 mm (5.96 in.) Additional non-standard belt widths are available in steps of 33.5 mm (1.32 in.)

2879	113.3	31669	7119	18.4	12.38	20	20	10
------	-------	-------	------	------	-------	----	----	----

General belt tolerance is +0/-0.4% at 23°C/73°F and 50% RH. For exact belt width contact Customer Service. Non standard belt width on request.

*Max. Load per Drive Sprocket. Belt material: POM 2500 N (562 lbf), PP 1200 N (270 lbf), PE 500 N (270 lbf)

**Max. Spacing between wear strips, Carry: 152 mm (6 in.); Return: 304 mm (12 in.)



STANDARD

STRAIGHT RUNNING

PITCH 50.0 MM/1.97 IN

Accessories

Flight

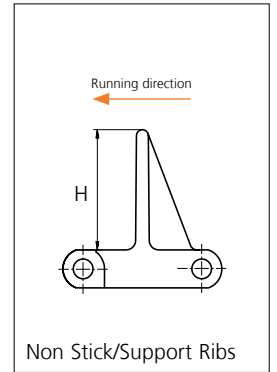
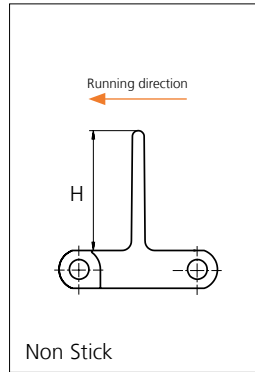

Type	Flight material & color	H		Link size	Width		Indent	
		mm	in		mm	in	mm	in
Non Stick	PP-HW B	50.8	2.00	K600	151.0	5.94	0.0	0.00
Non Stick/ Support Ribs		76.2	3.00					
		101.6	4.00					

Non Standard material and color: See uni Material and Color Overview.

Accessories

Side Guard

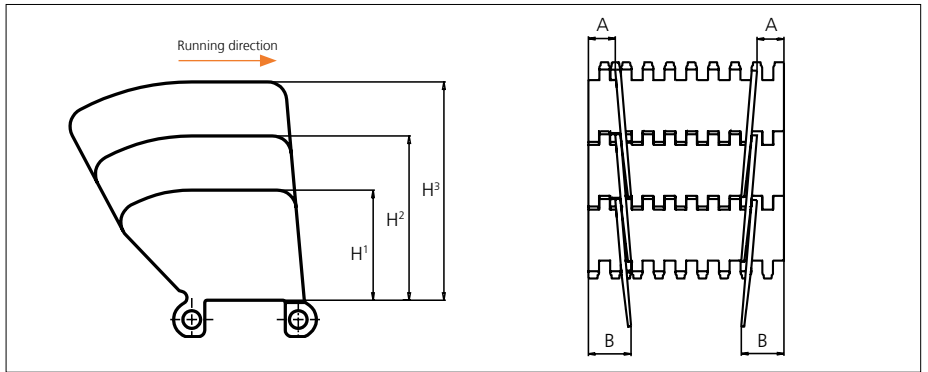

Type	Material & color	H ¹		H ²		H ³		A*		B*	
		mm	in	mm	in	mm	in	mm	in	mm	in
Closed	PP-HW B	51.8	2.04	77.2	3.04	102.6	4.04	21.0	0.83	34.0	1.34

* Min. indent Increment : 8.4 mm (0.33 in)

Note: Backflex radius when side guards are used: 200.0 mm (7.90 in)

Non Standard material and color: See uni Material and Color Overview.

Accessories

Tab/NON STANDARD

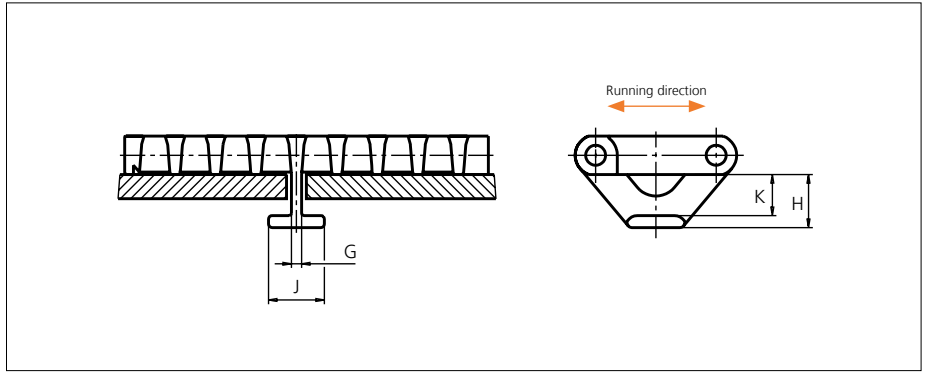

Type	Belt material & color	G		H		J		K	
		mm	in	mm	in	mm	in	mm	in
Bottom Hold Down	POM-D W	4.2	0.17	22.0	0.87	23.2	0.92	17.0	0.67
	POM-LF B								
	POM-D W								

Non Standard material and color: See uni Material and Color Overview.

Sprocket

No of teeth	Bore size													Overall diameter		Pitch diameter		Hub diameter		A-dimension		B-dimension		Single row/Two way	Double row/Two way	Molded PA6 LG	Machined PA6 N
	Pilot Bore	in	0.75	0.78	0.98	1.00	1.18	1.25	1.50	1.57	2.36	2.50	3.54														
	mm	19.1	20.0	25.0	25.4	30.0	31.8	38.1	40.0	60.0	63.5	90.0	mm	in	mm	in	mm	in	mm	in							
Z06	x				●	●	●	■	■				94.5	3.72	100.3	3.95	65	2.56	35.5	1.40	58.6	2.31	x		x		
Z08	x				●	●	●	■	■				129	5.08	131.1	5.16	65	2.56	52.6	2.07	74	2.91	x		x		
Z10	x					●	●	■	■				160.1	6.30	162.4	6.39	65	2.56	69.2	2.72	89.7	3.53	x		x		
Z12	x					●	●	■	■				191.5	7.54	193.9	7.63	65	2.56	85.7	3.37	105.5	4.15	x		x		
Z13	x					●		■	■				207.3	8.16	209.7	8.26	72	2.83	93.8	3.69	113.4	4.46	x		x		
Z13											■		207.3	8.16	209.7	8.26	150	5.91	93.8	3.69	113.4	4.46	x			x	
Z16	x					●		■	■		■		254.8	10.03	257.3	10.13	200	7.87	118.2	4.65	137.1	5.40	x			x	

■ Molded sprocket

● Molded sprocket

■ Machined sprocket

● Machined sprocket

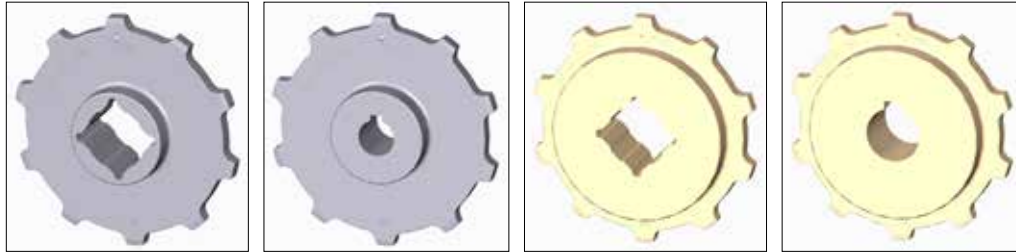

Non standard material and color: See uni Material and Color Overview.

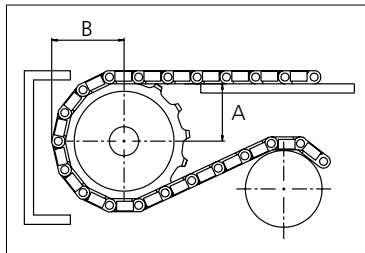

Other sprocket sizes are available upon request.
 Two-part sprocket are available upon request.
 Round bores are always delivered with keyway.
 Other bore sizes are available upon request.
 uni Retainer Rings: See uni Retainer Ring data sheet
 Width of tooth = 11.0 mm (0.43 in)
 Width of sprocket = 42.3 mm (1.67 in)

Max load per sprocket shown does not take bore size into account.
 Please also ensure that sufficient size shaft is chosen for corresponding load.

For correct sprocket position: See uni Assembly Instructions for uni OPB.
 For more detailed sprocket information, contact Customer Service.

uni OPB 4V 36%/1301



Solid advice
 For all your belting needs
 Local stock & service
www.ammeraalbeltech.com

Ammeraal Beltech Modular A/S
 Hjulmagervej 21
 DK-7100 Vejle

T +45 7572 3100
 F +45 7572 3348
 admin@unichains.com
 www.unichains.com

This information is subject to alteration due to continuous development. Ammeraal Beltech will not be held liable for the incorrect use of the above stated information. This information replaces previous information. All activities performed and services rendered by Ammeraal Beltech are subject to general terms and conditions of sale and delivery, as applied by its operating companies.



Plastic Modular Belt

Series **uni OPB 4V** Type **C**

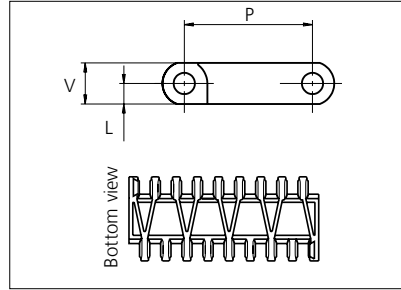

Straight running belt
 Nominal pitch: 50.0 mm (1.97 in)
 Surface type: Flat
 Surface opening: Closed
 Backflex radius: 75.0 mm (3.00 in)
 Pin diameter: ø8 mm (1.97 in)

*uni-chains recommends this travel direction. However, travel in both directions is possible.

Recommended belt material & color	POM-D W	mm	in	mm	in	
		P (Nominal)	50.0	1.97	V	16.0
Recommended pin and lock material & color	PP W	L	8.0	0.31	-	-

Non standard material and color: See uni Material and Color Overview.

Alternative materials: Belt: POM-LF, POM-SLF, PP, PE, PA6.6 and PA6.6H Rodlock: PP **W** Endlock: PP **W** **G** **B** and PE **W** **B**
 Lockpin: PE **W** PA6.6 **N** PP **W** Pin: PP **W** PE **W** SS304 and SS316

Belt width		Permissible tensile force (Belt/pin material)						Belt weight (Belt/pin material)						*Min. No. drive sprocket per shaft	Number of wear strips (Min. No.)	
		POM-D/PA6.6		PP/PA6.6		PE/PA6.6		POM-D/PA6.6		PP/PA6.6		PE/PA6.6			**Carry (pcs)	**Return (pcs)
mm	in	N	lbf	N	lbf	N	lbf	kg/m	lb/ft	kg/m	lb/ft	kg/m	lb/ft			
152	6.0	3344	752	1672	376	1003	226	1.8	1.20	1.1	0.77	1.2	0.83	2	2	2
303	11.9	6666	1499	3333	749	2000	450	3.5	2.38	2.3	1.53	2.5	1.65	3	3	2
455	17.9	10010	2250	5005	1125	3003	675	5.3	3.58	3.4	2.29	3.7	2.48	4	4	2
606	23.9	13332	2997	6666	1499	4000	899	7.1	4.76	4.5	3.05	4.9	3.30	5	5	3
758	29.8	16676	3749	8338	1874	5003	1125	8.9	5.96	5.7	3.82	6.1	4.13	6	6	3
909	35.8	19998	4496	9999	2248	5999	1349	10.6	7.15	6.8	4.58	7.4	4.95	7	7	4
1061	41.8	23342	5247	11671	2624	7003	1574	12.4	8.34	8.0	5.35	8.6	5.78	8	8	4
1212	47.7	26664	5994	13332	2997	7999	1798	14.2	9.53	9.1	6.11	9.8	6.60	9	9	5
1364	53.7	30008	6746	15004	3373	9002	2024	16.0	10.73	10.2	6.88	11.0	7.43	10	10	5
1515	59.6	33330	7493	16665	3746	9999	2248	17.7	11.91	11.4	7.64	12.3	8.25	11	11	6
1667	65.6	36674	8244	18337	4122	11002	2473	19.5	13.11	12.5	8.40	13.5	9.07	12	12	6
1818	71.6	39996	8991	19998	4496	11999	2697	21.3	14.29	13.6	9.16	14.7	9.90	13	13	7
1970	77.6	43340	9743	21670	4871	13002	2923	23.0	15.49	14.8	9.93	16.0	10.72	14	14	7

Additional standard belt widths are available in steps of 151.5 mm (5.96 in.) Additional non-standard belt widths are available in steps of 33.5 mm (1.32 in.)

2576	101.4	56672	12740	28336	6370	17002	3822	30.1	20.26	19.3	12.98	20.9	14.02	18	18	9
------	-------	-------	-------	-------	------	-------	------	------	-------	------	-------	------	-------	----	----	---

Additional standard belt widths are available in steps of 151.5 mm (5.96 in.) Additional non-standard belt widths are available in steps of 33.5 mm (1.32 in.)

2879	113.3	63338	14238	31669	7119	19001	4272	33.7	22.64	21.6	14.51	23.3	15.67	20	20	10
------	-------	-------	-------	-------	------	-------	------	------	-------	------	-------	------	-------	----	----	----

General belt tolerance is +0/-0.4% at 23°C/73°F and 50% RH. For exact belt width contact Customer Service. Non standard belt width on request.

*Max. Load per Drive Sprocket. Belt material: POM 2500 N (562 lbf), PP 1200 N (270 lbf), PE 500 N (270 lbf)

**Max. Spacing between wear strips, Carry: 152 mm (6 in.); Return: 304 mm (12 in.)



NON STANDARD

STRAIGHT RUNNING

PITCH 50.0 MM/1.97 IN

Accessories

Rubber Top

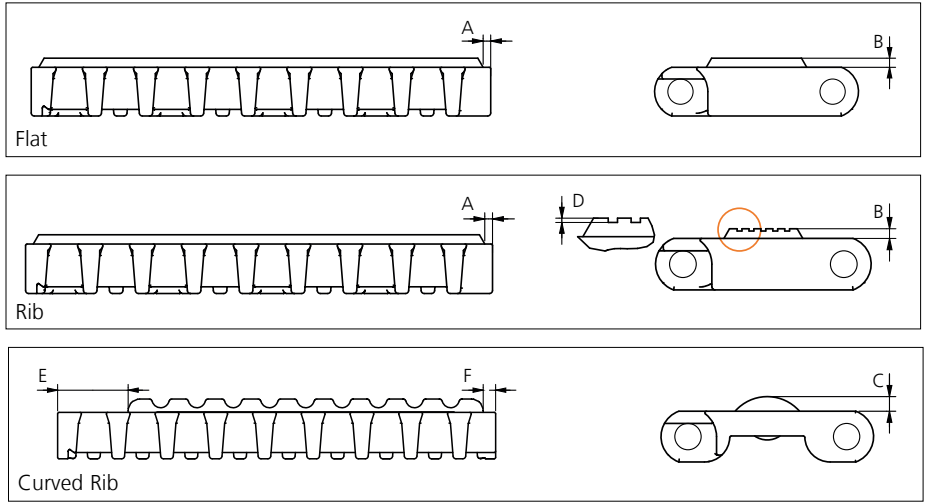

Type	Belt Material & color	Rubber Material & color	A		B		C		D		E		F		Link size	Width	
			mm	in	mm	in	mm	in	mm	in	mm	in	mm	in		mm	in
Flat	POM-LF BR	03 N															
Rib	POM-D W		2.5	0.10	3.0	0.12	4.5	0.18	0.7	0.03	24.0	0.94	4.0	0.16	K600	150.5	5.93
Curved Rib	POM-D W	03 K															

Other Non Standard Rubber profiles: See uni Rubber Profile Overview.

Accessories

Flight

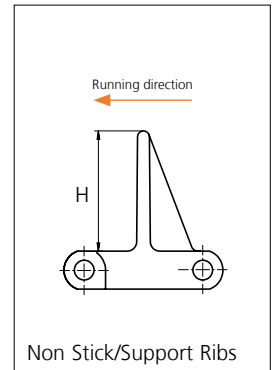
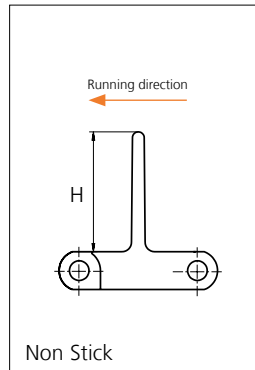

Type	Recommended Material & color	H		Link size	Width		Indent	
		mm	in		mm	in	mm	in
Non Stick	PP-HW B	50.8	2.00	K600	151.0	5.94	0.0	0.00
Non Stick/Support Ribs		76.2	3.00					
		101.6	4.00					

Non Standard material and color: See uni Material and Color Overview.

Accessories

Side Guard

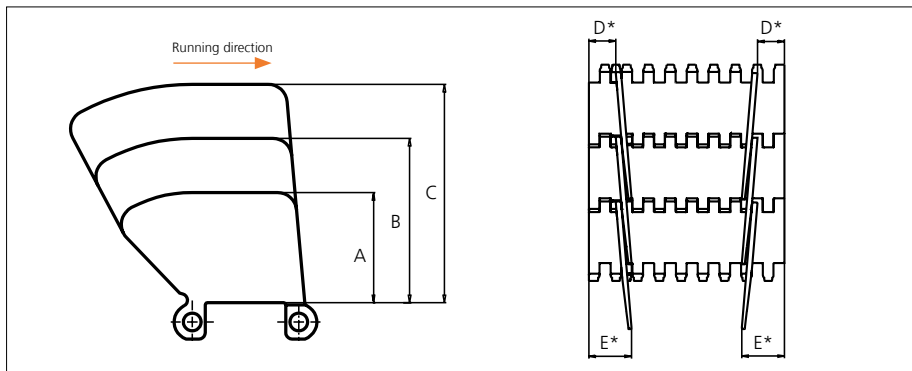

Type	Recommended Material & color	A		B		C		D*		E*	
		mm	in	mm	in	mm	in	mm	in	mm	in
Closed	PP-HW B	51.8	2.04	77.2	3.04	102.6	4.04	21.0	0.83	34.0	1.34

* Min. indent Increment : 8.4 mm (0.33 in)

Note: Backflex radius when side guard are used: 200.0 mm (7.90 in)

Non Standard material and color: See uni Material and Color Overview.

Accessories

Tab

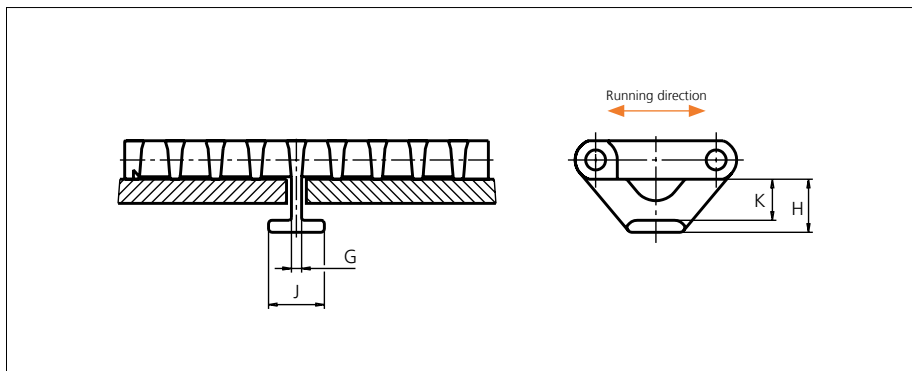

Type	Recommended Material & color	G		H		J		K	
		mm	in	mm	in	mm	in	mm	in
Bottom Hold Down	POM-D W	4.2	0.17	22.0	0.87	23.2	0.92	17.0	0.67
	POM-LF B								
	PP W								

Non Standard material and color: See uni Material and Color Overview.

Accessories

Non Standard uni AmFlight

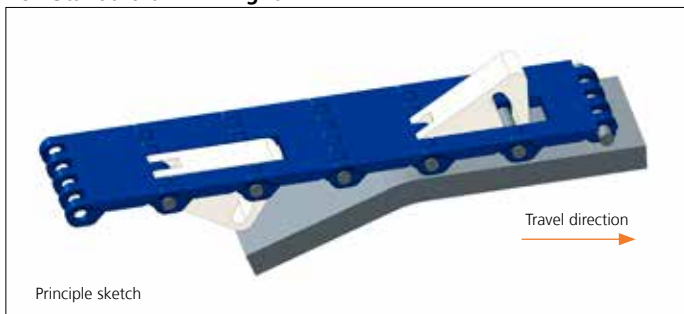

Other Non Standard option: See uni AmFlight Overview.

Sprocket

No of teeth	Bore size													Overall diameter		Pitch diameter		Hub diameter		A-dimension		B-dimension		Single row/Two way	Double row/Two way	Molded PA6 LG	Machined PA6 N
	Pilot Bore	in	0.75	0.78	0.98	1.00	1.18	1.25	1.50	1.57	2.36	2.50	3.54														
	mm	19.1	20.0	25.0	25.4	30.0	31.8	38.1	40.0	60.0	63.5	90.0	mm	in	mm	in	mm	in	mm	in							
Z06	x				●	●	●	■	■				94.5	3.72	100.3	3.95	65	2.56	35.5	1.40	58.6	2.31	x		x		
Z08	x				●	●	●	■	■				129	5.08	131.1	5.16	65	2.56	52.6	2.07	74	2.91	x		x		
Z10	x					●	●	■	■				160.1	6.30	162.4	6.39	65	2.56	69.2	2.72	89.7	3.53	x		x		
Z12	x					●	●	■	■				191.5	7.54	193.9	7.63	65	2.56	85.7	3.37	105.5	4.15	x		x		
Z13	x					●		■	■				207.3	8.16	209.7	8.26	72	2.83	93.8	3.69	113.4	4.46	x		x		
Z13													207.3	8.16	209.7	8.26	150	5.91	93.8	3.69	113.4	4.46	x			x	
Z16	x					●		■	■				254.8	10.03	257.3	10.13	200	7.87	118.2	4.65	137.1	5.40	x			x	

■ Molded sprocket

● Molded sprocket

■ Machined sprocket

● Machined sprocket

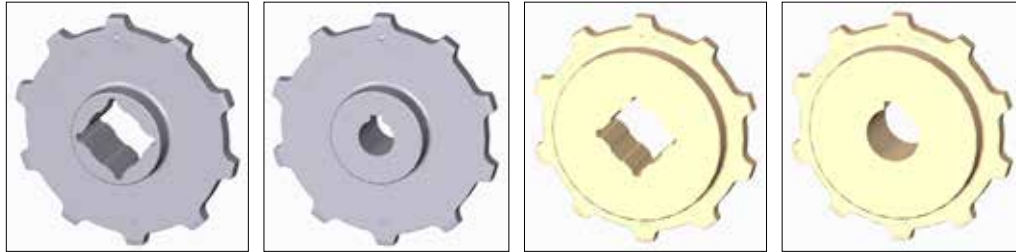

Non standard material and color: See uni Material and Color Overview.

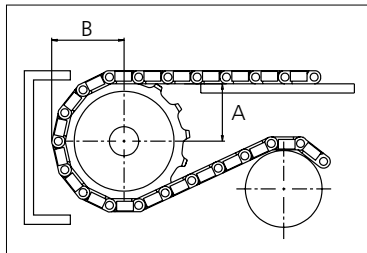

Other sprocket sizes are available upon request.
 Two-part sprocket are available upon request.
 Round bores are always delivered with keyway.
 Other bore sizes are available upon request.
 uni Retainer Rings: See uni Retainer Ring data sheet
 Width of tooth = 11.0 mm (0.43 in)
 Width of sprocket = 42.3 mm (1.67 in)

Max load per sprocket shown does not take bore size into account.
 Please also ensure that sufficient size shaft is chosen for corresponding load.

For correct sprocket position: See uni Assembly Instructions for uni OPB.
 For more detailed sprocket information, contact Customer Service.

uni OPB 4V C/1301



Solid advice
 For all your belting needs
 Local stock & service
www.ammeraalbeltech.com

Ammeraal Beltech Modular A/S
 Hjulmagervej 21
 DK-7100 Vejle

T +45 7572 3100
 F +45 7572 3348
 admin@unichains.com
 www.unichains.com

This information is subject to alteration due to continuous development. Ammeraal Beltech will not be held liable for the incorrect use of the above stated information. This information replaces previous information. All activities performed and services rendered by Ammeraal Beltech are subject to general terms and conditions of sale and delivery, as applied by its operating companies.



Plastic Modular Belt

Series **uni OPB 4V** Type **Rough**

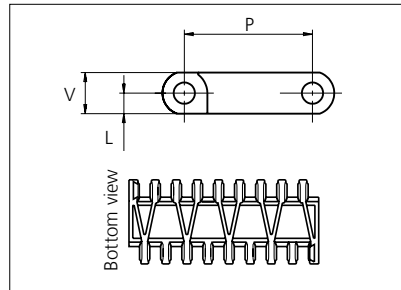

Straight running belt
 Nominal pitch: 50.0 mm (1.97 in)
 Surface type: Rough Top
 Surface opening: Closed
 Backflex radius: 75.0 mm (3.00 in)
 Pin diameter: \varnothing 8 mm (1.97 in)

*uni-chains recommends this travel direction. However, travel in both directions is possible.

Recommended belt material & color	POM-D W	mm	in	mm	in	
		P (Nominal)	50.0	1.97	V	16.0
Recommended pin and lock material & color	PP W	L	8.0	0.31	-	-

Non standard material and color: See uni Material and Color Overview.

Alternative materials: Belt: POM-LF, POM-SLF, PP, PE, PA6.6 and PA6.6H

Rodlock: PP **W**

Endlock: PP **W** **G** **B** and PE **W** **B**

Lockpin: PE **W** PA6.6 **N** PP **W**

Pin: PP **W** PE **W** SS304 and SS316

Belt width		Permissible tensile force (Belt/pin material)						Belt weight (Belt/pin material)						*Min. No. drive sprocket per shaft	Number of wear strips (Min. No.)	
		POM-D/PA6.6		PP/PA6.6		PE/PA6.6		POM-D/PA6.6		PP/PA6.6		PE/PA6.6			**Carry (pcs)	**Return (pcs)
mm	in	N	lbf	N	lbf	N	lbf	kg/m	lb/ft	kg/m	lb/ft	kg/m	lb/ft			
152	6.0	3344	752	1672	376	1003	226	1.8	1.20	1.1	0.77	1.2	0.83	2	2	2
303	11.9	6666	1499	3333	749	2000	450	3.5	2.38	2.3	1.53	2.5	1.65	3	3	2
455	17.9	10010	2250	5005	1125	3003	675	5.3	3.58	3.4	2.29	3.7	2.48	4	4	2
606	23.9	13332	2997	6666	1499	4000	899	7.1	4.76	4.5	3.05	4.9	3.30	5	5	3
758	29.8	16676	3749	8338	1874	5003	1125	8.9	5.96	5.7	3.82	6.1	4.13	6	6	3
909	35.8	19998	4496	9999	2248	5999	1349	10.6	7.15	6.8	4.58	7.4	4.95	7	7	4
1061	41.8	23342	5247	11671	2624	7003	1574	12.4	8.34	8.0	5.35	8.6	5.78	8	8	4
1212	47.7	26664	5994	13332	2997	7999	1798	14.2	9.53	9.1	6.11	9.8	6.60	9	9	5
1364	53.7	30008	6746	15004	3373	9002	2024	16.0	10.73	10.2	6.88	11.0	7.43	10	10	5
1515	59.6	33330	7493	16665	3746	9999	2248	17.7	11.91	11.4	7.64	12.3	8.25	11	11	6
1667	65.6	36674	8244	18337	4122	11002	2473	19.5	13.11	12.5	8.40	13.5	9.07	12	12	6
1818	71.6	39996	8991	19998	4496	11999	2697	21.3	14.29	13.6	9.16	14.7	9.90	13	13	7
1970	77.6	43340	9743	21670	4871	13002	2923	23.0	15.49	14.8	9.93	16.0	10.72	14	14	7

Additional standard belt widths are available in steps of 151.5 mm (5.96 in.) Additional non-standard belt widths are available in steps of 33.5 mm (1.32 in.)

2576	101.4	56672	12740	28336	6370	17002	3822	30.1	20.26	19.3	12.98	20.9	14.02	18	18	9
------	-------	-------	-------	-------	------	-------	------	------	-------	------	-------	------	-------	----	----	---

Additional standard belt widths are available in steps of 151.5 mm (5.96 in.) Additional non-standard belt widths are available in steps of 33.5 mm (1.32 in.)

2879	113.3	63338	14238	31669	7119	19001	4272	33.7	22.64	21.6	14.51	23.3	15.67	20	20	10
------	-------	-------	-------	-------	------	-------	------	------	-------	------	-------	------	-------	----	----	----

General belt tolerance is +0/-0.4% at 23°C/73°F and 50% RH. For exact belt width contact Customer Service. Non standard belt width on request.

*Max. Load per Drive Sprocket. Belt material: POM 2500 N (562 lbf), PP 1200 N (270 lbf), PE 500 N (270 lbf)

**Max. Spacing between wear strips, Carry: 152 mm (6 in.); Return: 304 mm (12 in.)



NON STANDARD

STRAIGHT RUNNING

PITCH 50.0 MM/1.97 IN

Accessories

Tab

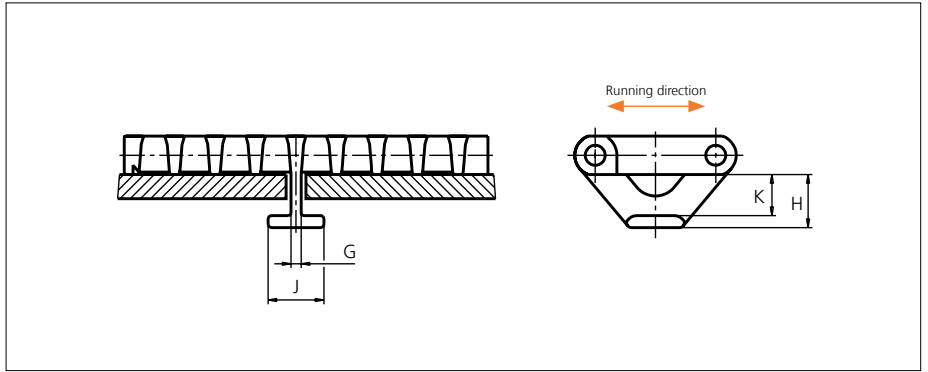

Type	Recommended material & color	G		H		J		K	
		mm	in	mm	in	mm	in	mm	in
Bottom Hold Down	POM-D W	4.2	0.17	22.0	0.87	23.2	0.92	17.0	0.67
	POM-LF B								
	POM-D W								

Non Standard material and color: See uni Material and Color Overview.

Sprocket

No of teeth	Bore size													Overall diameter		Pitch-diameter		Hub-diameter		A-dimension		B-dimension		Single row/Two way	Double row/Two way	Material		
	Pilot Bore	mm	in	0.75	0.78	0.98	1.00	1.18	1.25	1.50	1.57	2.36	2.50													3.54	mm	in
														PA6	PA6 LG													
Z06	x						●	●	●	■	■				94.5	3.72	100.3	3.95	65	2.56	35.5	1.40	58.6	2.31	x		x	
Z08	x						●	●	●	■	■				129	5.08	131.1	5.16	65	2.56	52.6	2.07	74	2.91	x		x	
Z10	x						●	●	●	■	■				160.1	6.30	162.4	6.39	65	2.56	69.2	2.72	89.7	3.53	x		x	
Z12	x						●	●	●	■	■				191.5	7.54	193.9	7.63	65	2.56	85.7	3.37	105.5	4.15	x		x	
Z13	x						●			■	■				207.3	8.16	209.7	8.26	72	2.83	93.8	3.69	113.4	4.46	x		x	
Z13												■			207.3	8.16	209.7	8.26	150	5.91	93.8	3.69	113.4	4.46	x			x
Z16	x						●			■	■		■		254.8	10.03	257.3	10.13	200	7.87	118.2	4.65	137.1	5.40	x			x

■ Molded sprocket

● Molded sprocket

■ Machined sprocket

● Machined sprocket

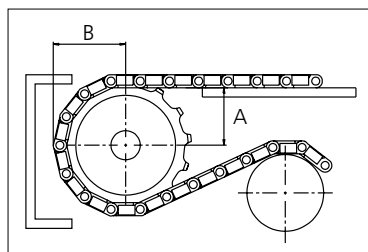
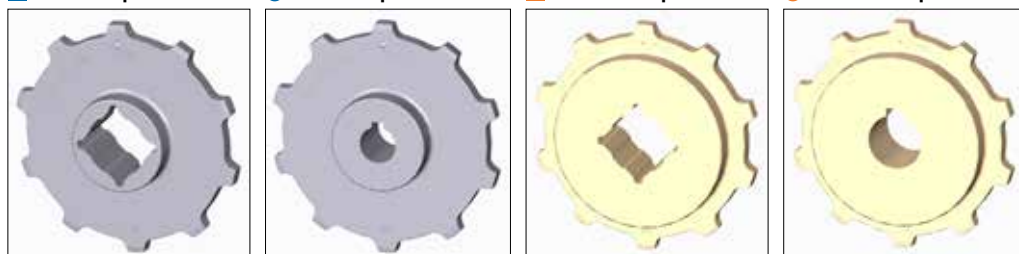

Other sprocket sizes are available upon request.
 Two-part sprocket are available upon request.
 Round bores are always delivered with keyway.
 Other bore sizes are available upon request.
 uni Retainer Rings: See uni Retainer Ring data sheet
 Width of tooth = 11.0 mm (0.43 in)
 Width of sprocket = 42.3 mm (1.67 in)

Max load per sprocket shown does not take bore size into account.
 Please also ensure that sufficient size shaft is chosen for corresponding load.

For correct sprocket position: See uni Assembly Instructions for uni OPB.
 For more detailed sprocket information, contact Customer Service.

Non standard material and color: See uni Material and Color Overview.



Conveyor



Seamless



Modular



Timing



Transmission



Fabrication & service

Solid advice
For all your belting needs
Local stock & service
www.ammeraalbeltech.com

Ammeraal Beltech Modular A/S
Hjulmagervej 21
DK-7100 Vejle

T +45 7572 3100
F +45 7572 3348
admin@unichains.com
www.unichains.com

This information is subject to alteration due to continuous development. Ammeraal Beltech will not be held liable for the incorrect use of the above stated information. This information replaces previous information. All activities performed and services rendered by Ammeraal Beltech are subject to general terms and conditions of sale and delivery, as applied by its operating companies.



Plastic Modular Belt

Series **uni OPB 4V** Type **Vacuum**

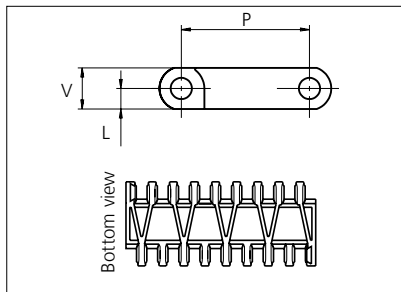

Straight running belt
 Nominal pitch: 50.0 mm (1.97 in)
 Surface type: Flat
 Surface opening: ø5.5 mm (0.22 in)
 Backflex radius: 75.0 mm (3.00 in)
 Pin diameter: ø8 mm (1.97 in)

*uni-chains recommends this travel direction. However, travel in both directions is possible.

Recommended belt material & color	POM-D W	mm	in	mm	in		
		P (Nominal)	50.0	1.97	V	16.0	0.63
Recommended pin and lock material & color	PP W	L	8.0	0.31	-	-	-

Non standard material and color: See uni Material and Color Overview.

Alternative materials: Belt: POM-LF, POM-SLF, PP, PE, PA6.6 and PA6.6H

Rodlock: PP **W**

Endlock: PP **W** **G** **B** and PE **W** **B**

Lockpin: PE **W** PA6.6 **N** PP **W**

Pin: PP **W** PE **W** SS304 and SS316

Belt width		Permissible tensile force (Belt/pin material)						Belt weight (Belt/pin material)						*Min. No. drive sprocket per shaft	Number of wear strips (Min. No.)	
		POM-D/PA6.6		PP/PA6.6		PE/PA6.6		POM-D/PA6.6		PP/PA6.6		PE/PA6.6			**Carry (pcs)	**Return (pcs)
mm	in	N	lbf	N	lbf	N	lbf	kg/m	lb/ft	kg/m	lb/ft	kg/m	lb/ft			
151	5.9	3322	747	1661	373	997	224	1.8	1.19	1.1	0.76	1.2	0.82	2	2	2
302	11.9	6644	1494	3322	747	1993	448	3.5	2.37	2.3	1.52	2.4	1.64	3	3	2
453	17.8	9966	2240	4983	1120	2990	672	5.3	3.56	3.4	2.28	3.7	2.47	4	4	2
604	23.8	13288	2987	6644	1494	3986	896	7.1	4.75	4.5	3.04	4.9	3.29	5	5	3
755	29.7	16610	3734	8305	1867	4983	1120	8.8	5.94	5.7	3.81	6.1	4.11	6	6	3
906	35.7	19932	4481	9966	2240	5980	1344	10.6	7.12	6.8	4.57	7.3	4.93	7	7	4
1057	41.6	23254	5227	11627	2614	6976	1568	12.4	8.31	7.9	5.33	8.6	5.75	8	8	4
1208	47.6	26576	5974	13288	2987	7973	1792	14.1	9.50	9.1	6.09	9.8	6.58	9	9	5
1359	53.5	29898	6721	14949	3361	8969	2016	15.9	10.69	10.2	6.85	11.0	7.40	10	10	5
1510	59.4	33220	7468	16610	3734	9966	2240	17.7	11.87	11.3	7.61	12.2	8.22	11	11	6
1661	65.4	36542	8215	18271	4107	10963	2464	19.4	13.06	12.5	8.37	13.5	9.04	12	12	6
1812	71.3	39864	8961	19932	4481	11959	2688	21.2	14.25	13.6	9.13	14.7	9.86	13	13	7
1963	77.3	43186	9708	21593	4854	12956	2912	23.0	15.44	14.7	9.89	15.9	10.69	14	14	7

Additional standard belt widths are available in steps of 151.0 mm (5.94 in.) Additional non-standard belt widths are available in steps of 33.6 mm (1.32 in.)

2567	101.1	56474	12695	28237	6348	16942	3809	30.0	20.18	19.3	12.94	20.8	13.97	18	18	9
------	-------	-------	-------	-------	------	-------	------	------	-------	------	-------	------	-------	----	----	---

Additional standard belt widths are available in steps of 151.0 mm (5.94 in.) Additional non-standard belt widths are available in steps of 33.6 mm (1.32 in.)

2869	113.0	63118	14189	31559	7094	18935	4257	33.6	22.56	21.5	14.46	23.2	15.62	20	20	10
------	-------	-------	-------	-------	------	-------	------	------	-------	------	-------	------	-------	----	----	----

General belt tolerance is +0/-0.4% at 23°C/73°F and 50% RH. For exact belt width contact Customer Service. Non standard belt width on request

*Max. Load per Drive Sprocket. Belt material: POM 2500 N (562 lbf), PP 1200 N (270 lbf), PE 500 N (270 lbf)

**Max. Spacing between wear strips, Carry: 152 mm (6 in) ; Return: 304 mm (12 in)

= Single Link



NON STANDARD

STRAIGHT RUNNING

PITCH 50.0 MM/1.97 IN

Accessories

Tab

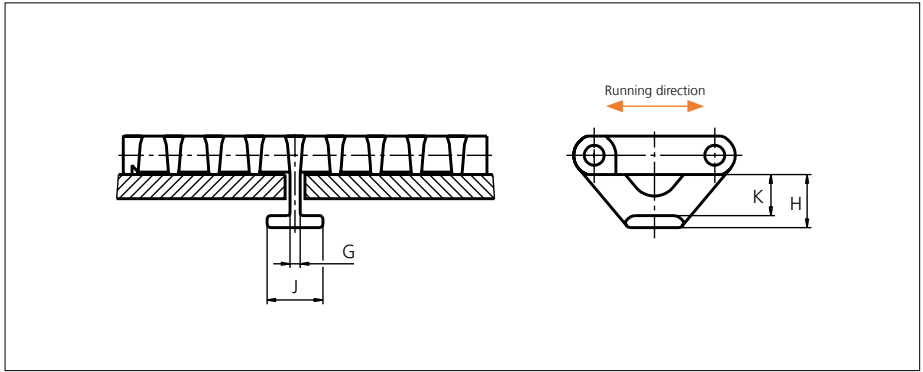

Type	Recommended material & color	G		H		J		K	
		mm	in	mm	in	mm	in	mm	in
Bottom Hold Down	POM-D W	4.2	0.17	22.0	0.87	23.2	0.92	17.0	0.67
	POM-LF B								
	PP W								

Non Standard material and color: See uni Material and Color Overview.

Sprocket

No of teeth	Bore size												Overall diameter		Pitch-diameter		Hub-diameter		A-dimension		B-dimension		Single row/Two way	Double row/Two way	Machined						
	Pilot Bore	mm	in	0.75	0.78	0.98	1.00	1.18	1.25	1.50	1.57	2.36													2.50	3.54	60.0	63.5	90.0	mm	in
													PA6	PA6 LG																	
Z06	x						●	●	●	■	■							94.5	3.72	100.3	3.95	65	2.56	35.5	1.40	58.6	2.31	x		x	
Z08	x						●	●	●	■	■							129	5.08	131.1	5.16	65	2.56	52.6	2.07	74	2.91	x		x	
Z10	x						●	●	●	■	■							160.1	6.30	162.4	6.39	65	2.56	69.2	2.72	89.7	3.53	x		x	
Z12	x						●	●	●	■	■							191.5	7.54	193.9	7.63	65	2.56	85.7	3.37	105.5	4.15	x		x	
Z13	x						●			■	■							207.3	8.16	209.7	8.26	72	2.83	93.8	3.69	113.4	4.46	x		x	
Z13														■				207.3	8.16	209.7	8.26	150	5.91	93.8	3.69	113.4	4.46	x			x
Z16	x						●			■	■			■				254.8	10.03	257.3	10.13	200	7.87	118.2	4.65	137.1	5.40	x			x

■ Molded sprocket

● Molded sprocket

■ Machined sprocket

● Machined sprocket

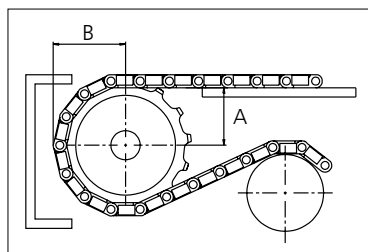
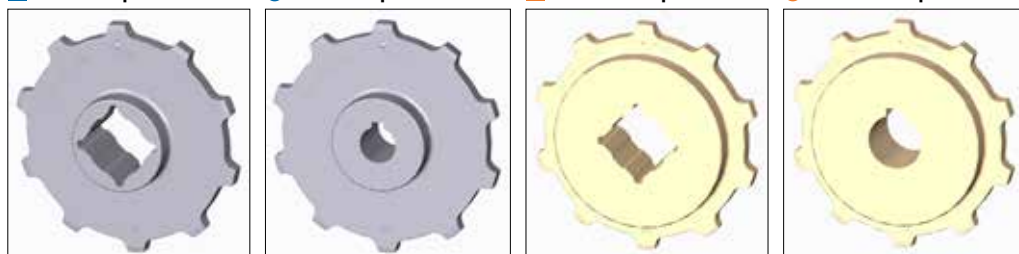

Other sprocket sizes are available upon request.
 Two-part sprocket are available upon request.
 Round bores are always delivered with keyway.
 Other bore sizes are available upon request.
 uni Retainer Rings: See uni Retainer Ring data sheet
 Width of tooth = 11.0 mm (0.43 in)
 Width of sprocket = 42.3 mm (1.67 in)

Max load per sprocket shown does not take bore size into account.
 Please also ensure that sufficient size shaft is chosen for corresponding load.

For correct sprocket position: See uni Assembly Instructions for uni OPB.
 For more detailed sprocket information, contact Customer Service.

Non standard material and color: See uni Material and Color Overview.



Conveyor



Seamless



Modular



Timing



Transmission



Fabrication & service

Solid advice
For all your belting needs
Local stock & service
www.ammeraalbeltech.com

Ammeraal Beltech Modular A/S
Hjulmagervej 21
DK-7100 Vejle

T +45 7572 3100
F +45 7572 3348
admin@unichains.com
www.unichains.com

This information is subject to alteration due to continuous development. Ammeraal Beltech will not be held liable for the incorrect use of the above stated information. This information replaces previous information. All activities performed and services rendered by Ammeraal Beltech are subject to general terms and conditions of sale and delivery, as applied by its operating companies.



Plastic Modular Belt

Series **uni OPB 8** Type **20%**

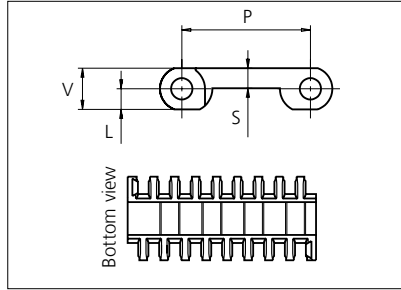

Straight running belt
 Nominal pitch: 50.0 mm (1.97 in)
 Surface type: Flat
 Surface opening: 20%
 Backflex radius: 75.0 mm (3.00 in)
 Pin diameter: ø8 mm (1.97 in)

*uni-chains recommends this travel direction. However, travel in both directions is possible.

Recommended belt material & color	POM-D W		mm	in		mm	in
		P (Nominal)	50.0	1.97	V	16.0	0.63
Recommended pin and lock material & color	PP W						
		L	8.0	0.31	S	7.8	0.31

Non standard material and color: See uni Material and Color Overview.

Alternative materials: Belt: POM-LF, POM-SLF, PP, PE, PA6.6 and PA6.6H

Rodlock: PP **W**

Endlock: PP **W** **G** **B** and PE **W** **B**

Lockpin: PE **W** PA6.6 **N** PP **W**

Pin: PP **W** PE **W** SS304 and SS316

Belt width		Permissible tensile force (Belt/pin material)						Belt weight (Belt/pin material)						*Min. No. drive sprocket per shaft	Number of wear strips (Min. No.)	
		POM-D/PA6.6		PP/PA6.6		PE/PA6.6		POM-D/PA6.6		PP/PA6.6		PE/PA6.6			**Carry (pcs)	**Return (pcs)
mm	in	N	lbf	N	lbf	N	lbf	kg/m	lb/ft	kg/m	lb/ft	kg/m	lb/ft			
152	6.0	3344	752	1672	376	1003	226	1.5	1.03	1.0	0.70	1.1	0.75	2	2	2
303	11.9	6666	1499	3333	749	2000	450	3.1	2.06	2.1	1.41	2.2	1.49	3	3	2
455	17.9	10010	2250	5005	1125	3003	675	4.6	3.09	3.1	2.11	3.3	2.23	4	4	2
606	23.9	13332	2997	6666	1499	4000	899	6.1	4.11	4.2	2.81	4.4	2.97	5	5	3
758	29.8	16676	3749	8338	1874	5003	1125	7.7	5.15	5.2	3.51	5.5	3.72	6	6	3
909	35.8	19998	4496	9999	2248	5999	1349	9.2	6.17	6.3	4.22	6.6	4.46	7	7	4
1061	41.8	23342	5247	11671	2624	7003	1574	10.7	7.20	7.3	4.92	7.7	5.21	8	8	4
1212	47.7	26664	5994	13332	2997	7999	1798	12.2	8.23	8.4	5.62	8.8	5.95	9	9	5
1364	53.7	30008	6746	15004	3373	9002	2024	13.8	9.26	9.4	6.33	10.0	6.69	10	10	5
1515	59.6	33330	7493	16665	3746	9999	2248	15.3	10.28	10.5	7.03	11.1	7.43	11	11	6
1667	65.6	36674	8244	18337	4122	11002	2473	16.8	11.32	11.5	7.73	12.2	8.18	12	12	6
1818	71.6	39996	8991	19998	4496	11999	2697	18.4	12.34	12.5	8.43	13.3	8.92	13	13	7
1970	77.6	43340	9743	21670	4871	13002	2923	19.9	13.37	13.6	9.14	14.4	9.66	14	14	7

Additional standard belt widths are available in steps of 151.5 mm (5.96 in.) Additional non-standard belt widths are available in steps of 33.5 mm (1.32 in.)

2576	101.4	56672	12740	28336	6370	17002	3822	26.0	17.49	17.8	11.95	18.8	12.64	18	18	9
------	-------	-------	-------	-------	------	-------	------	------	-------	------	-------	------	-------	----	----	---

Additional standard belt widths are available in steps of 151.5 mm (5.96 in.) Additional non-standard belt widths are available in steps of 33.5 mm (1.32 in.)

2879	113.3	63338	14238	31669	7119	19001	4272	29.1	19.54	19.9	13.35	21.0	14.12	20	20	10
------	-------	-------	-------	-------	------	-------	------	------	-------	------	-------	------	-------	----	----	----

General belt tolerance is +0/-0.4% at 23°C/73°F and 50% RH. For exact belt width contact Customer Service. Non standard belt width on request.

*Max. Load per Drive Sprocket. Belt material: POM 2500 N (562 lbf), PP 1200 N (270 lbf), PE 500 N (270 lbf)

**Max. Spacing between wear strips, Carry: 152 mm (6 in.); Return: 304 mm (12 in.)



NON STANDARD

STRAIGHT RUNNING

PITCH 50.0 MM/1.97 IN

Accessories

Flight

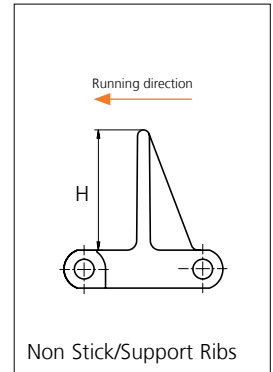
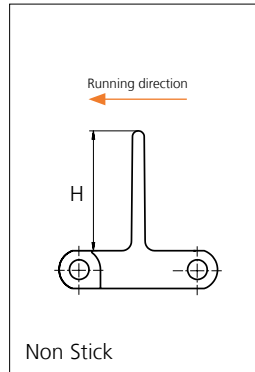

Type	Recommended Material & color	H		Link size	Width		Indent	
		mm	in		mm	in	mm	in
Non Stick	PP-HW B	50.8	2.00	K600	151.0	5.94	0.0	0.00
Non Stick/ Support Ribs		76.2	3.00					
		101.6	4.00					

Non Standard material and color: See uni Material and Color Overview.

Accessories

Side Guard

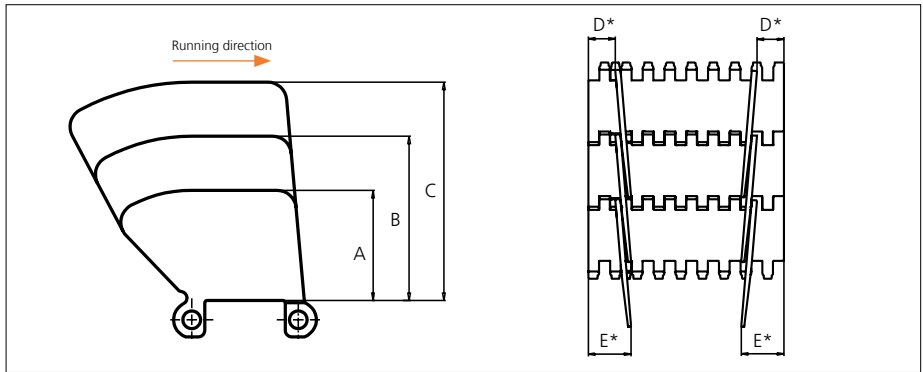

Type	Recommended Material & color	A		B		C		D*		E*	
		mm	in	mm	in	mm	in	mm	in	mm	in
Closed	PP-HW B	51.8	2.04	77.2	3.04	102.6	4.04	21.0	0.83	34.0	1.34

* Min. indent Increment : 8.4 mm (0.33 in)

Note: Backflex radius when side guards are used: 200.0 mm (7.90 in)

Non Standard material and color: See uni Material and Color Overview.

Accessories

Tab

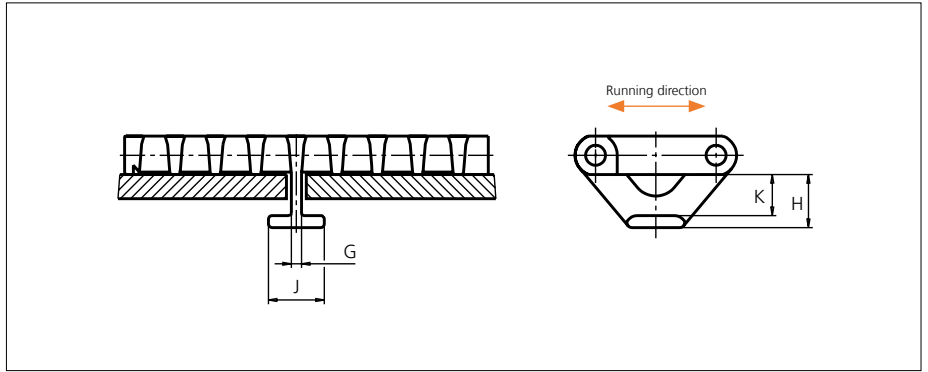

Type	Recommended material & color	G		H		J		K	
		mm	in	mm	in	mm	in	mm	in
Bottom Hold Down	POM-D W	4.2	0.17	22.0	0.87	23.2	0.92	17.0	0.67
	POM-LF B								
	POM-D W								

Non Standard material and color: See uni Material and Color Overview.

Sprocket

No of teeth	Bore size													Overall diameter		Pitch-diameter		Hub-diameter		A-dimension		B-dimension		Single row/Two way	Double row/Two way	Molded PA6 LG	Machined PA6 N
	Pilot Bore	in	0.75	0.78	0.98	1.00	1.18	1.25	1.50	1.57	2.36	2.50	3.54														
	mm	19.1	20.0	25.0	25.4	30.0	31.8	38.1	40.0	60.0	63.5	90.0	mm	in	mm	in	mm	in	mm	in							
Z06	x				●	●	●	■	■				94.5	3.72	100.3	3.95	65	2.56	35.5	1.40	58.6	2.31	x		x		
Z08	x				●	●	●	■	■				129	5.08	131.1	5.16	65	2.56	52.6	2.07	74	2.91	x		x		
Z10	x					●	●	■	■				160.1	6.30	162.4	6.39	65	2.56	69.2	2.72	89.7	3.53	x		x		
Z12	x					●	●	■	■				191.5	7.54	193.9	7.63	65	2.56	85.7	3.37	105.5	4.15	x		x		
Z13	x					●		■	■				207.3	8.16	209.7	8.26	72	2.83	93.8	3.69	113.4	4.46	x		x		
Z13											■		207.3	8.16	209.7	8.26	150	5.91	93.8	3.69	113.4	4.46	x			x	
Z16	x					●		■	■		■		254.8	10.03	257.3	10.13	200	7.87	118.2	4.65	137.1	5.40	x			x	

■ Molded sprocket

● Molded sprocket

■ Machined sprocket

● Machined sprocket

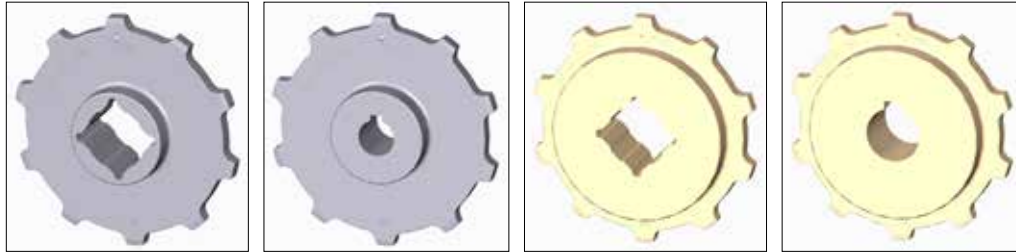

Non standard material and color: See uni Material and Color Overview.

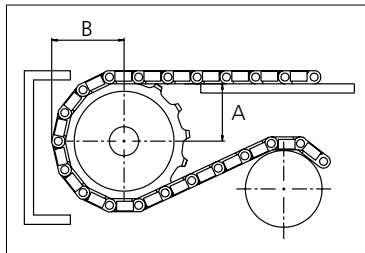

Other sprocket sizes are available upon request.
 Two-part sprocket are available upon request.
 Round bores are always delivered with keyway.
 Other bore sizes are available upon request.
 uni Retainer Rings: See uni Retainer Ring data sheet
 Width of tooth = 11.0 mm (0.43 in)
 Width of sprocket = 42.3 mm (1.67 in)

Max load per sprocket shown does not take bore size into account.
 Please also ensure that sufficient size shaft is chosen for corresponding load.

For correct sprocket position: See uni Assembly Instructions for uni OPB.
 For more detailed sprocket information, contact Customer Service.

uni OPB 8 20%/1301



Solid advice
 For all your belting needs
 Local stock & service
www.ammeraalbeltech.com

Ammeraal Beltech Modular A/S
 Hjulmagervej 21
 DK-7100 Vejle

T +45 7572 3100
 F +45 7572 3348
 admin@unichains.com
 www.unichains.com

This information is subject to alteration due to continuous development. Ammeraal Beltech will not be held liable for the incorrect use of the above stated information. This information replaces previous information. All activities performed and services rendered by Ammeraal Beltech are subject to general terms and conditions of sale and delivery, as applied by its operating companies.



Plastic Modular Belt

Series **uni OPB 8** Type **25%**

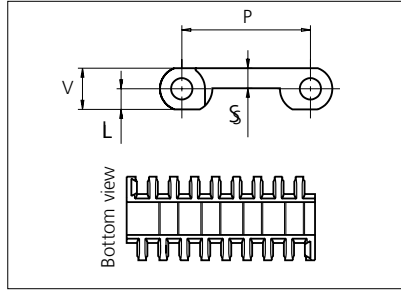

Straight running belt
 Nominal pitch: 50.0 mm (1.97 in)
 Surface type: Flat
 Surface opening: 25%
 Backflex radius: 75.0 mm (3.00 in)
 Pin diameter: \varnothing 8 mm (1.97 in)

*uni-chains recommends this travel direction. However, travel in both directions is possible.

Recommended belt material & color	POM-D W		mm	in		mm	in
		P (Nominal)	50.0	1.97	V	16.0	0.63
Recommended pin and lock material & color	PP W						
		L	8.0	0.31	S	7.8	0.31

Non standard material and color: See uni Material and Color Overview.

Alternative materials: Belt: POM-LF, POM-SLF, PP, PE, PA6.6 and PA6.6H

Rodlock: PP **W**

Endlock: PP **W** **G** **B** and PE **W** **B**

Lockpin: PE **W** PA6.6 **N** PP **W**

Pin: PP **W** PE **W** SS304 and SS316

Belt width		Permissible tensile force (Belt/pin material)						Belt weight (Belt/pin material)						*Min. No. drive sprocket per shaft	Number of wear strips (Min. No.)	
		POM-D/PA6.6		PP/PA6.6		PE/PA6.6		POM-D/PA6.6		PP/PA6.6		PE/PA6.6			**Carry (pcs)	**Return (pcs)
mm	in	N	lbf	N	lbf	N	lbf	kg/m	lb/ft	kg/m	lb/ft	kg/m	lb/ft			
152	6.0	3344	752	1672	376	1003	226	1.5	1.03	1.0	0.70	1.1	0.75	2	2	2
303	11.9	6666	1499	3333	749	2000	450	3.1	2.06	2.1	1.41	2.2	1.49	3	3	2
455	17.9	10010	2250	5005	1125	3003	675	4.6	3.09	3.1	2.11	3.3	2.23	4	4	2
606	23.9	13332	2997	6666	1499	4000	899	6.1	4.11	4.2	2.81	4.4	2.97	5	5	3
758	29.8	16676	3749	8338	1874	5003	1125	7.7	5.15	5.2	3.51	5.5	3.72	6	6	3
909	35.8	19998	4496	9999	2248	5999	1349	9.2	6.17	6.3	4.22	6.6	4.46	7	7	4
1061	41.8	23342	5247	11671	2624	7003	1574	10.7	7.20	7.3	4.92	7.7	5.21	8	8	4
1212	47.7	26664	5994	13332	2997	7999	1798	12.2	8.23	8.4	5.62	8.8	5.95	9	9	5
1364	53.7	30008	6746	15004	3373	9002	2024	13.8	9.26	9.4	6.33	10.0	6.69	10	10	5
1515	59.6	33330	7493	16665	3746	9999	2248	15.3	10.28	10.5	7.03	11.1	7.43	11	11	6
1667	65.6	36674	8244	18337	4122	11002	2473	16.8	11.32	11.5	7.73	12.2	8.18	12	12	6
1818	71.6	39996	8991	19998	4496	11999	2697	18.4	12.34	12.5	8.43	13.3	8.92	13	13	7
1970	77.6	43340	9743	21670	4871	13002	2923	19.9	13.37	13.6	9.14	14.4	9.66	14	14	7

Additional standard belt widths are available in steps of 151.5 mm (5.96 in.) Additional non-standard belt widths are available in steps of 33.5 mm (1.32 in.)

2576	101.4	56672	12740	28336	6370	17002	3822	26.0	17.49	17.8	11.95	18.8	12.64	18	18	9
------	-------	-------	-------	-------	------	-------	------	------	-------	------	-------	------	-------	----	----	---

Additional standard belt widths are available in steps of 151.5 mm (5.96 in.) Additional non-standard belt widths are available in steps of 33.5 mm (1.32 in.)

2879	113.3	63338	14238	31669	7119	19001	4272	29.1	19.54	19.9	13.35	21.0	14.12	20	20	10
------	-------	-------	-------	-------	------	-------	------	------	-------	------	-------	------	-------	----	----	----

General belt tolerance is +0/-0.4% at 23°C/73°F and 50% RH. For exact belt width contact Customer Service. Non standard belt width on request.

*Max. Load per Drive Sprocket. Belt material: POM 2500 N (562 lbf), PP 1200 N (270 lbf), PE 500 N (270 lbf)

**Max. Spacing between wear strips, Carry: 152 mm (6 in.); Return: 304 mm (12 in.)



NON STANDARD

STRAIGHT RUNNING

PITCH 50.0 MM/1.97 IN

Accessories

Flight

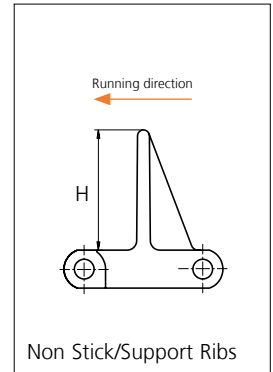
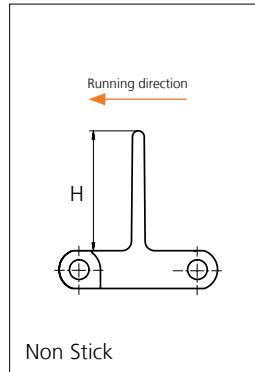

Type	Recommended Material & color	H		Link size	Width		Indent	
		mm	in		mm	in	mm	in
Non Stick	PP-HW B	50.8	2.00	K600	151.0	5.94	0.0	0.00
Non Stick/ Support Ribs		76.2	3.00					
		101.6	4.00					

Non Standard material and color: See uni Material and Color Overview.

Accessories

Side Guard

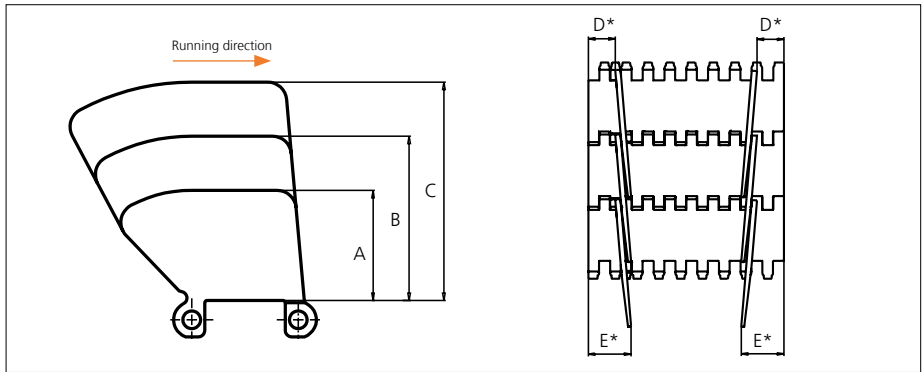

Type	Recommended Material & color	A		B		C		D*		E*	
		mm	in	mm	in	mm	in	mm	in	mm	in
Closed	PP-HW B	51.8	2.04	77.2	3.04	102.6	4.04	21.0	0.83	34.0	1.34

* Min. indent Increment : 8.4 mm (0.33 in)

Note: Backflex radius when side guards are used: 200.0 mm (7.90 in)

Non Standard material and color: See uni Material and Color Overview.

Accessories

Tab

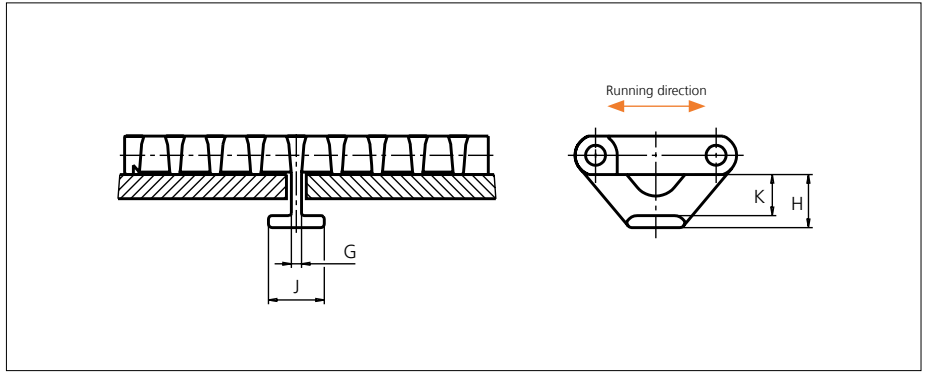

Type	Recommended material & color	G		H		J		K	
		mm	in	mm	in	mm	in	mm	in
Bottom Hold Down	POM-D W	4.2	0.17	22.0	0.87	23.2	0.92	17.0	0.67
	POM-LF B								
	PP W								

Non Standard material and color: See uni Material and Color Overview.

Sprocket

No of teeth	Bore size													Overall diameter		Pitch diameter		Hub diameter		A-dimension		B-dimension		Single row/Two way	Double row/Two way	Molded PA6 LG	Machined PA6 N
	Pilot Bore	in	0.75	0.78	0.98	1.00	1.18	1.25	1.50	1.57	2.36	2.50	3.54														
	mm	19.1	20.0	25.0	25.4	30.0	31.8	38.1	40.0	60.0	63.5	90.0	mm	in	mm	in	mm	in	mm	in							
Z06	x				●	●	●	■	■				94.5	3.72	100.3	3.95	65	2.56	35.5	1.40	58.6	2.31	x		x		
Z08	x				●	●	●	■	■				129	5.08	131.1	5.16	65	2.56	52.6	2.07	74	2.91	x		x		
Z10	x					●	●	■	■				160.1	6.30	162.4	6.39	65	2.56	69.2	2.72	89.7	3.53	x		x		
Z12	x					●	●	■	■				191.5	7.54	193.9	7.63	65	2.56	85.7	3.37	105.5	4.15	x		x		
Z13	x					●		■	■				207.3	8.16	209.7	8.26	72	2.83	93.8	3.69	113.4	4.46	x		x		
Z13													207.3	8.16	209.7	8.26	150	5.91	93.8	3.69	113.4	4.46	x			x	
Z16	x					●		■	■				254.8	10.03	257.3	10.13	200	7.87	118.2	4.65	137.1	5.40	x			x	

■ Molded sprocket

● Molded sprocket

■ Machined sprocket

● Machined sprocket

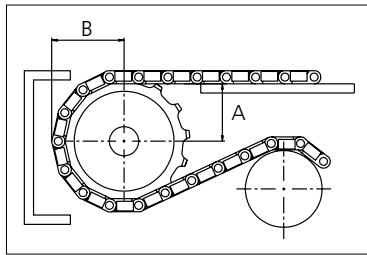
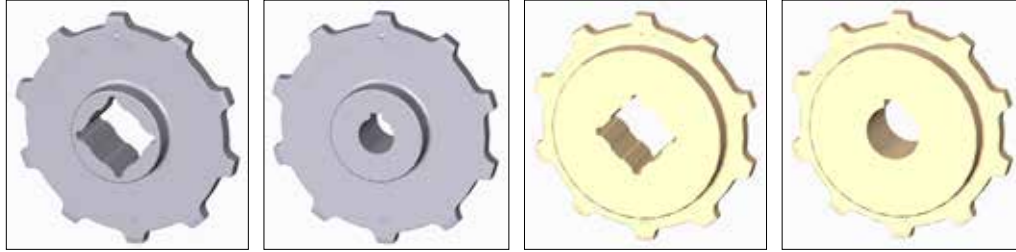

Other sprocket sizes are available upon request.
 Two-part sprocket are available upon request.
 Round bores are always delivered with keyway.
 Other bore sizes are available upon request.
 uni Retainer Rings: See uni Retainer Ring data sheet
 Width of tooth = 11.0 mm (0.43 in)
 Width of sprocket = 42.3 mm (1.67 in)

Max load per sprocket shown does not take bore size into account.
 Please also ensure that sufficient size shaft is chosen for corresponding load.

For correct sprocket position: See uni Assembly Instructions for uni OPB.
 For more detailed sprocket information, contact Customer Service.

Non standard material and color: See uni Material and Color Overview.

uni OPB 8 25%/1301



Solid advice
 For all your belting needs
 Local stock & service
www.ammeraalbeltech.com

Ammeraal Beltech Modular A/S
 Hjulmagervej 21
 DK-7100 Vejle

T +45 7572 3100
 F +45 7572 3348
 admin@unichains.com
 www.unichains.com

This information is subject to alteration due to continuous development. Ammeraal Beltech will not be held liable for the incorrect use of the above stated information. This information replaces previous information. All activities performed and services rendered by Ammeraal Beltech are subject to general terms and conditions of sale and delivery, as applied by its operating companies.



Plastic Modular Belt

Series **uni OPB 8** Type **C**

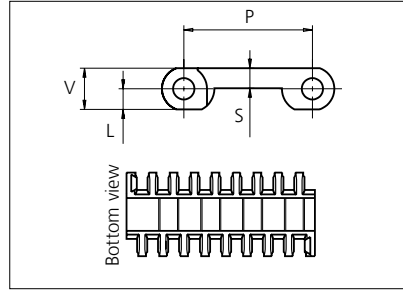

Straight running belt
 Nominal pitch: 50.0 mm (1.97 in)
 Surface type: Flat
 Surface opening: Closed
 Backflex radius: 75.0 mm (3.00 in)
 Pin diameter: \varnothing 8 mm (1.97 in)

*uni-chains recommends this travel direction. However, travel in both directions is possible.

Recommended belt material & color	POM-D W		mm	in		mm	in
		P (Nominal)	50.0	1.97	V	16.0	0.63
Recommended pin and lock material & color	PP W						
		L	8.0	0.31	S	7.8	0.31

Non standard material and color: See uni Material and Color Overview.

Alternative materials: Belt: POM-LF, POM-SLF, PP, PE, PA6.6 and PA6.6H

Rodlock: PP **W**

Endlock: PP **W** **G** **B** and PE **W** **B**

Lockpin: PE **W** PA6.6 **N** PP **W**

Pin: PP **W** PE **W** SS304 and SS316

Belt width		Permissible tensile force (Belt/pin material)						Belt weight (Belt/pin material)						*Min. No. drive sprocket per shaft	Number of wear strips (Min. No.)	
		POM-D/PA6.6		PP/PA6.6		PE/PA6.6		POM-D/PA6.6		PP/PA6.6		PE/PA6.6			**Carry (pcs)	**Return (pcs)
mm	in	N	lbf	N	lbf	N	lbf	kg/m	lb/ft	kg/m	lb/ft	kg/m	lb/ft			
152	6.0	3344	752	1672	376	1003	226	1.7	1.14	1.1	0.77	1.2	0.83	2	2	2
303	11.9	6666	1499	3333	749	2000	450	3.4	2.28	2.3	1.53	2.5	1.65	3	3	2
455	17.9	10010	2250	5005	1125	3003	675	5.1	3.42	3.4	2.29	3.7	2.48	4	4	2
606	23.9	13332	2997	6666	1499	4000	899	6.8	4.56	4.5	3.05	4.9	3.30	5	5	3
758	29.8	16676	3749	8338	1874	5003	1125	8.5	5.71	5.7	3.82	6.1	4.13	6	6	3
909	35.8	19998	4496	9999	2248	5999	1349	10.2	6.84	6.8	4.58	7.4	4.95	7	7	4
1061	41.8	23342	5247	11671	2624	7003	1574	11.9	7.99	8.0	5.35	8.6	5.78	8	8	4
1212	47.7	26664	5994	13332	2997	7999	1798	13.6	9.12	9.1	6.11	9.8	6.60	9	9	5
1364	53.7	30008	6746	15004	3373	9002	2024	15.3	10.27	10.2	6.88	11.0	7.43	10	10	5
1515	59.6	33330	7493	16665	3746	9999	2248	17.0	11.40	11.4	7.64	12.3	8.25	11	11	6
1667	65.6	36674	8244	18337	4122	11002	2473	18.7	12.55	12.5	8.40	13.5	9.07	12	12	6
1818	71.6	39996	8991	19998	4496	11999	2697	20.4	13.68	13.6	9.16	14.7	9.90	13	13	7
1970	77.6	43340	9743	21670	4871	13002	2923	22.1	14.83	14.8	9.93	16.0	10.72	14	14	7

Additional standard belt widths are available in steps of 151.5 mm (5.96 in.) Additional non-standard belt widths are available in steps of 33.5 mm (1.32 in.)

2576	101.4	56672	12740	28336	6370	17002	3822	28.9	19.39	19.3	12.98	20.9	14.02	18	18	9
------	-------	-------	-------	-------	------	-------	------	------	-------	------	-------	------	-------	----	----	---

Additional standard belt widths are available in steps of 151.5 mm (5.96 in.) Additional non-standard belt widths are available in steps of 33.5 mm (1.32 in.)

2879	113.3	63338	14238	31669	7119	19001	4272	32.2	21.67	21.6	14.51	23.3	15.67	20	20	10
------	-------	-------	-------	-------	------	-------	------	------	-------	------	-------	------	-------	----	----	----

General belt tolerance is +0/-0.4% at 23°C/73°F and 50% RH. For exact belt width contact Customer Service. Non standard belt width on request.

*Max. Load per Drive Sprocket. Belt material: POM 2500 N (562 lbf), PP 1200 N (270 lbf), PE 500 N (270 lbf)

**Max. Spacing between wear strips, Carry: 152 mm (6 in.); Return: 304 mm (12 in.)



NON STANDARD

STRAIGHT RUNNING

PITCH 50.0 MM/1.97 IN

Accessories

Rubber Top

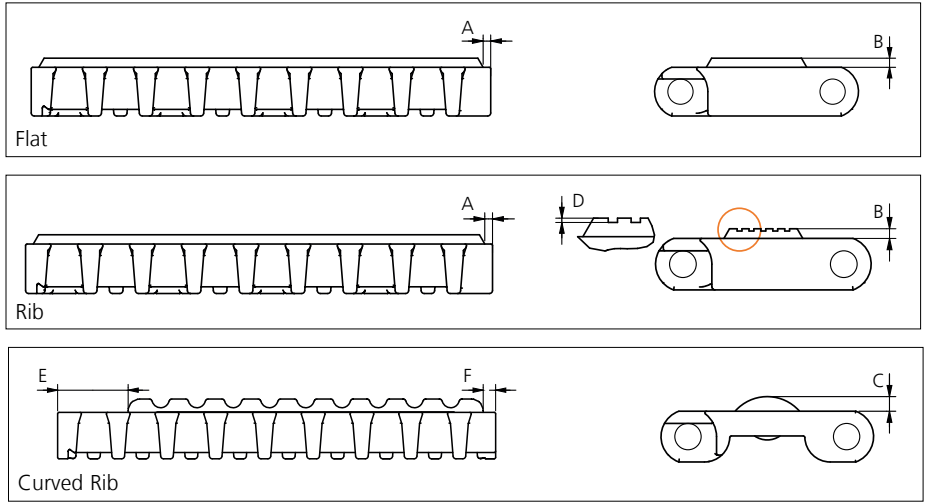

Type	Belt Material & color	Rubber Material & color	A		B		C		D		E		F		Link size	Width	
			mm	in	mm	in	mm	in	mm	in	mm	in	mm	in		mm	in
Flat	POM-LF BR	03 N															
Rib	POM-D W		2.5	0.10	3.0	0.12	4.5	0.18	0.7	0.03	24.0	0.94	4.0	0.16	K600	150.5	5.93
Curved Rib	POM-D W	03 K															

Other Non Standard Rubber profiles: See uni Rubber Profile Overview.

Accessories

Flight

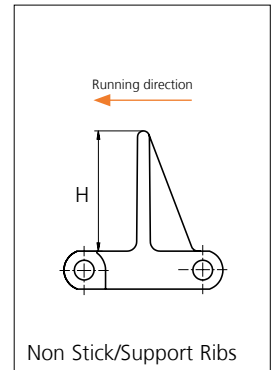
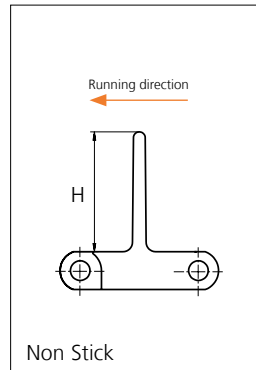

Type	Recommended Material & color	H		Link size	Width		Indent	
		mm	in		mm	in	mm	in
Non Stick	PP-HW B	50.8	2.00	K600	151.0	5.94	0.0	0.00
Non Stick/		76.2	3.00					
Support Ribs		101.6	4.00					

Non Standard material and color: See uni Material and Color Overview.

Accessories

Side Guard

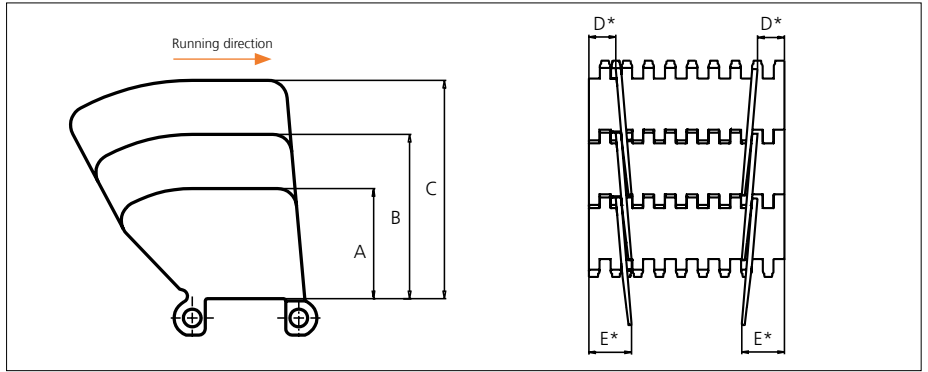

Type	Recommended Material & color	A		B		C		D*		E*	
		mm	in	mm	in	mm	in	mm	in	mm	in
Closed	PP-HW B	51.8	2.04	77.2	3.04	102.6	4.04	21.0	0.83	34.0	1.34

* Min. indent Increment : 8.4 mm (0.33 in)

Note: Backflex radius when side guard are used: 200.0 mm (7.90 in)

Non Standard material and color: See uni Material and Color Overview.

Accessories

Tab

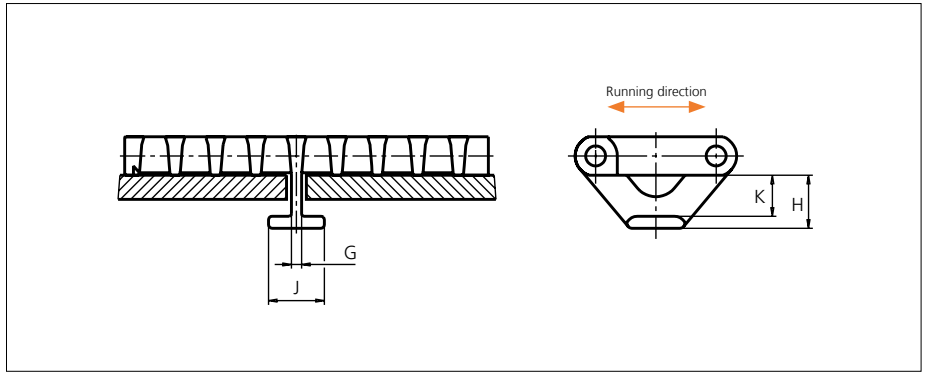

Type	Recommended material & color	G		H		J		K	
		mm	in	mm	in	mm	in	mm	in
Bottom Hold Down	POM-D W	4.2	0.17	22.0	0.87	23.2	0.92	17.0	0.67
	POM-LF B								
	PP W								

Non Standard material and color: See uni Material and Color Overview.

Accessories

Non Standard uni AmFlight

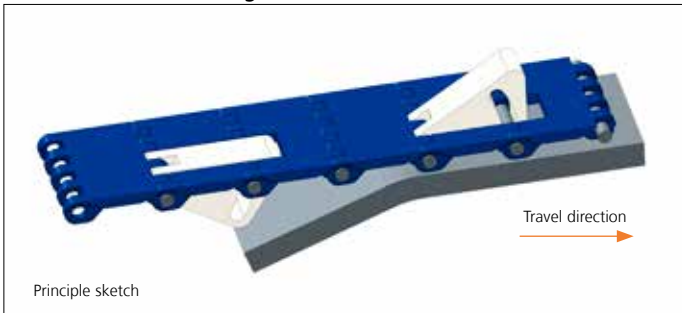

Other Non Standard option: See uni AmFlight Overview.

Sprocket

No of teeth	Bore size													Overall diameter		Pitch-diameter		Hub-diameter		A-dimension		B-dimension		Single row/Two way	Double row/Two way	Molded PA6 LG	Machined PA6 N
	Pilot Bore	in	0.75	0.78	0.98	1.00	1.18	1.25	1.50	1.57	2.36	2.50	3.54														
	mm	19.1	20.0	25.0	25.4	30.0	31.8	38.1	40.0	60.0	63.5	90.0	mm	in	mm	in	mm	in	mm	in							
Z06	x				●	●	●	■	■				94.5	3.72	100.3	3.95	65	2.56	35.5	1.40	58.6	2.31	x		x		
Z08	x				●	●	●	■	■				129	5.08	131.1	5.16	65	2.56	52.6	2.07	74	2.91	x		x		
Z10	x					●	●	■	■				160.1	6.30	162.4	6.39	65	2.56	69.2	2.72	89.7	3.53	x		x		
Z12	x					●	●	■	■				191.5	7.54	193.9	7.63	65	2.56	85.7	3.37	105.5	4.15	x		x		
Z13	x					●		■	■				207.3	8.16	209.7	8.26	72	2.83	93.8	3.69	113.4	4.46	x		x		
Z13											■		207.3	8.16	209.7	8.26	150	5.91	93.8	3.69	113.4	4.46	x			x	
Z16	x					●		■	■		■		254.8	10.03	257.3	10.13	200	7.87	118.2	4.65	137.1	5.40	x			x	

■ Molded sprocket

● Molded sprocket

■ Machined sprocket

● Machined sprocket

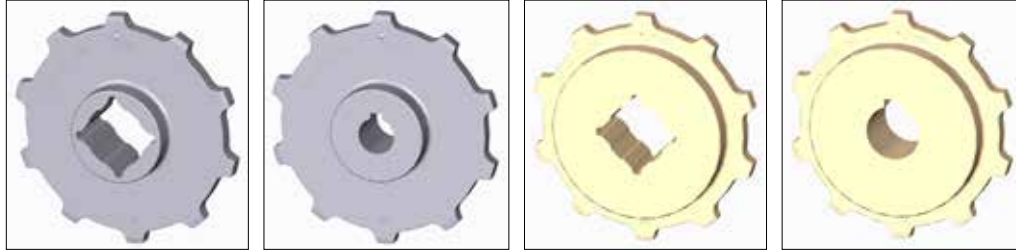

Non standard material and color: See uni Material and Color Overview.

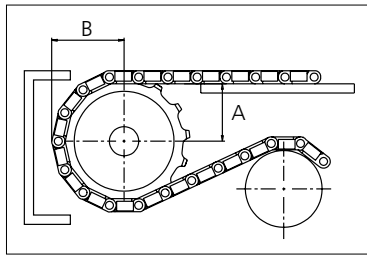

Other sprocket sizes are available upon request.
 Two-part sprocket are available upon request.
 Round bores are always delivered with keyway.
 Other bore sizes are available upon request.
 uni Retainer Rings: See uni Retainer Ring data sheet
 Width of tooth = 11.0 mm (0.43 in)
 Width of sprocket = 42.3 mm (1.67 in)

Max load per sprocket shown does not take bore size into account.
 Please also ensure that sufficient size shaft is chosen for corresponding load.

For correct sprocket position: See uni Assembly Instructions for uni OPB.
 For more detailed sprocket information, contact Customer Service.

uni OPB 8 C/1301



Solid advice
 For all your belting needs
 Local stock & service
www.ammeraalbeltech.com

Ammeraal Beltech Modular A/S
 Hjulmagervej 21
 DK-7100 Vejle

T +45 7572 3100
 F +45 7572 3348
 admin@unichains.com
 www.unichains.com

This information is subject to alteration due to continuous development. Ammeraal Beltech will not be held liable for the incorrect use of the above stated information. This information replaces previous information. All activities performed and services rendered by Ammeraal Beltech are subject to general terms and conditions of sale and delivery, as applied by its operating companies.



Plastic Modular Belt

Series **uni OPB 8M** Type **C**

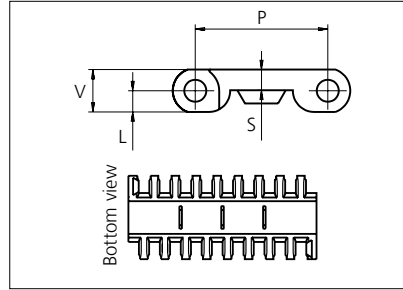

Straight running belt
 Nominal pitch: 50.0 mm (1.97 in)
 Surface type: Flat
 Surface opening: Closed
 Backflex radius: 75.0 mm (3.00 in)
 Pin diameter: \varnothing 8 mm (1.97 in)

*uni-chains recommends this travel direction. However, travel in both directions is possible.

Recommended belt material & color	POM-D W		mm	in		mm	in
		P (Nominal)	50.0	1.97	V	16.0	0.63
Recommended pin and lock material & color	PP W						
		L	8.0	0.31	S	7.8	0.31

Non standard material and color: See uni Material and Color Overview.

Alternative materials: Belt: POM-LF, POM-SLF, PP, PE, PA6.6 and PA6.6H

Rodlock: PP **W**

Endlock: PP **W** **G** **B** and PE **W** **B**

Lockpin: PE **W** PA6.6 **N** PP **W**

Pin: PP **W** PE **W** SS304 and SS316

Belt width		Permissible tensile force (Belt/pin material)						Belt weight (Belt/pin material)						*Min. No. drive sprocket per shaft	Number of wear strips (Min. No.)	
		POM-D/PA6.6		PP/PA6.6		PE/PA6.6		POM-D/PA6.6		PP/PA6.6		PE/PA6.6			**Carry (pcs)	**Return (pcs)
mm	in	N	lbf	N	lbf	N	lbf	kg/m	lb/ft	kg/m	lb/ft	kg/m	lb/ft			
152	6.0	3344	752	1672	376	1003	226	1.8	1.20	1.1	0.77	1.2	0.83	2	2	2
303	11.9	6666	1499	3333	749	2000	450	3.5	2.38	2.3	1.53	2.5	1.65	3	3	2
455	17.9	10010	2250	5005	1125	3003	675	5.3	3.58	3.4	2.29	3.7	2.48	4	4	2
606	23.9	13332	2997	6666	1499	4000	899	7.1	4.76	4.5	3.05	4.9	3.30	5	5	3
758	29.8	16676	3749	8338	1874	5003	1125	8.9	5.96	5.7	3.82	6.1	4.13	6	6	3
909	35.8	19998	4496	9999	2248	5999	1349	10.6	7.15	6.8	4.58	7.4	4.95	7	7	4
1061	41.8	23342	5247	11671	2624	7003	1574	12.4	8.34	8.0	5.35	8.6	5.78	8	8	4
1212	47.7	26664	5994	13332	2997	7999	1798	14.2	9.53	9.1	6.11	9.8	6.60	9	9	5
1364	53.7	30008	6746	15004	3373	9002	2024	16.0	10.73	10.2	6.88	11.0	7.43	10	10	5
1515	59.6	33330	7493	16665	3746	9999	2248	17.7	11.91	11.4	7.64	12.3	8.25	11	11	6
1667	65.6	36674	8244	18337	4122	11002	2473	19.5	13.11	12.5	8.40	13.5	9.07	12	12	6
1818	71.6	39996	8991	19998	4496	11999	2697	21.3	14.29	13.6	9.16	14.7	9.90	13	13	7
1970	77.6	43340	9743	21670	4871	13002	2923	23.0	15.49	14.8	9.93	16.0	10.72	14	14	7

Additional standard belt widths are available in steps of 151.5 mm (5.96 in.) Additional non-standard belt widths are available in steps of 33.5 mm (1.32 in.)

2576	101.4	56672	12740	28336	6370	17002	3822	30.1	20.26	19.3	12.98	20.9	14.02	18	18	9
------	-------	-------	-------	-------	------	-------	------	------	-------	------	-------	------	-------	----	----	---

Additional standard belt widths are available in steps of 151.5 mm (5.96 in.) Additional non-standard belt widths are available in steps of 33.5 mm (1.32 in.)

2879	113.3	63338	14238	31669	7119	19001	4272	33.7	22.64	21.6	14.51	23.3	15.67	20	20	10
------	-------	-------	-------	-------	------	-------	------	------	-------	------	-------	------	-------	----	----	----

General belt tolerance is +0/-0.4% at 23°C/73°F and 50% RH. For exact belt width contact Customer Service. Non standard belt width on request.

*Max. Load per Drive Sprocket. Belt material: POM 2500 N (562 lbf), PP 1200 N (270 lbf), PE 500 N (270 lbf)

**Max. Spacing between wear strips, Carry: 152 mm (6 in.); Return: 304 mm (12 in.)



NON STANDARD

STRAIGHT RUNNING

PITCH 50.0 MM/1.97 IN

Accessories

Rubber Top

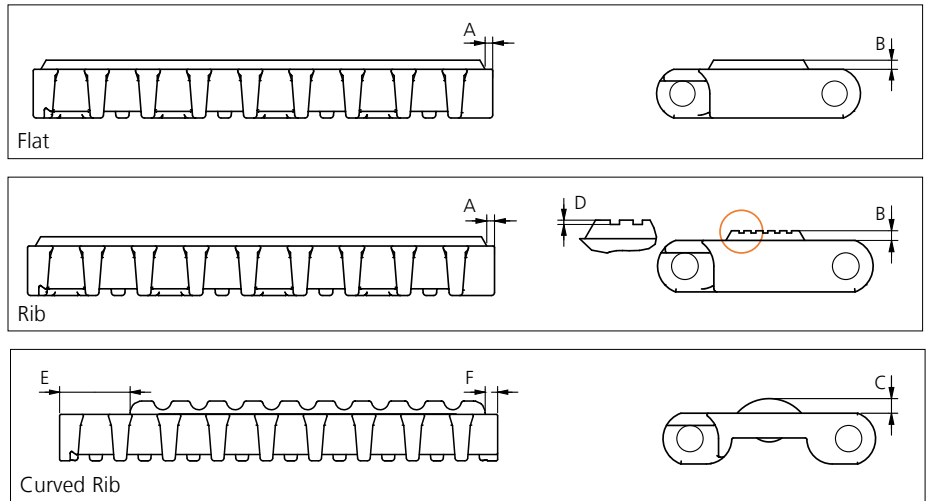

Type	Belt Material & color	Rubber Material & color	A		B		C		D		E		F		Link size	Width	
			mm	in	mm	in	mm	in	mm	in	mm	in	mm	in		mm	in
Flat	POM-LF BR	03 N															
Rib	POM-D W		2.5	0.10	3.0	0.12	4.5	0.18	0.7	0.03	24.0	0.94	4.0	0.16	K600	150.5	5.93
Curved Rib	POM-D W	03 K															

Other Non Standard Rubber profiles: See uni Rubber Profile Overview.

Accessories

Flight

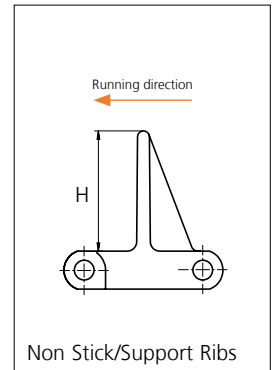
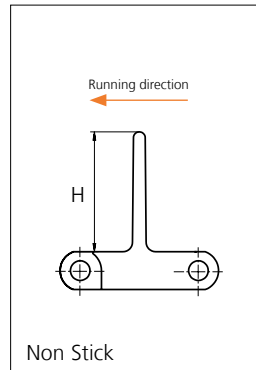

Type	Recommended Material & color	H		Link size	Width		Indent	
		mm	in		mm	in	mm	in
Non Stick	PP-HW B	50.8	2.00	K600	151.0	5.94	0.0	0.00
Non Stick/		76.2	3.00					
Support Ribs		101.6	4.00					

Non Standard material and color: See uni Material and Color Overview.

Accessories

Side Guard

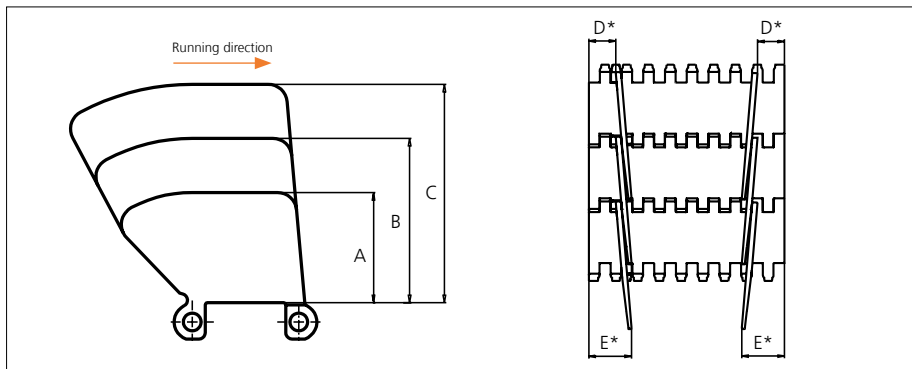

Type	Recommended Material & color	A		B		C		D*		E*	
		mm	in	mm	in	mm	in	mm	in	mm	in
Closed	PP-HW B	51.8	2.04	77.2	3.04	102.6	4.04	21.0	0.83	34.0	1.34

* Min. indent Increment : 8.4 mm (0.33 in)

Note: Backflex radius when side guard are used: 200.0 mm (7.90 in)

Non Standard material and color: See uni Material and Color Overview.

Accessories

Tab

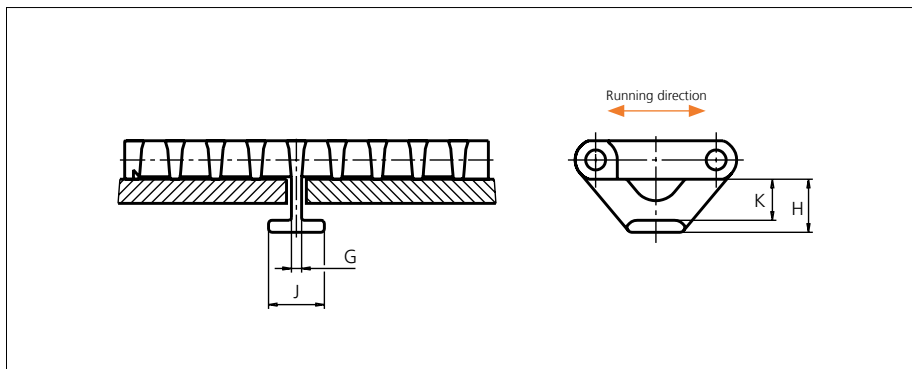

Type	Recommended Material & color	G		H		J		K	
		mm	in	mm	in	mm	in	mm	in
Bottom Hold Down	POM-D W	4.2	0.17	22.0	0.87	23.2	0.92	17.0	0.67
	POM-LF B								
	PP W								

Non Standard material and color: See uni Material and Color Overview.

Accessories

Non Standard uni AmFlight

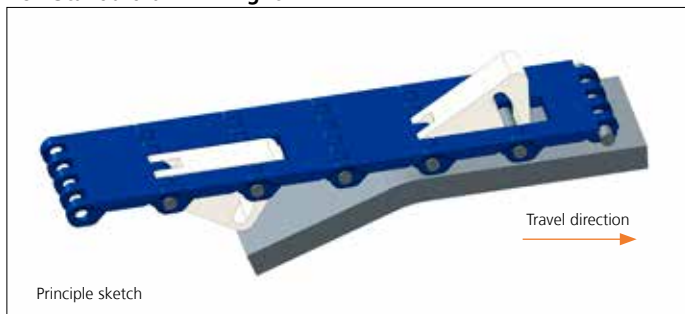

Other Non Standard option: See uni AmFlight Overview.

Sprocket

No of teeth	Bore size													Overall diameter		Pitch diameter		Hub diameter		A-dimension		B-dimension		Single row/Two way	Double row/Two way	Molded PA6 LG	Machined PA6 N
	Pilot Bore	in	0.75	0.78	0.98	1.00	1.18	1.25	1.50	1.57	2.36	2.50	3.54														
	mm	19.1	20.0	25.0	25.4	30.0	31.8	38.1	40.0	60.0	63.5	90.0	mm	in	mm	in	mm	in	mm	in							
Z06	x				●	●	●	■	■				89.1	3.51	100.3	3.95	65	2.56	35.5	1.40	58.6	2.31	x		x		
Z08	x				●	●	●	■	■				120.9	4.76	131.1	5.16	65	2.56	52.6	2.07	74	2.91	x		x		
Z10	x					●	●	■	■				153.0	6.02	162.4	6.39	65	2.56	69.2	2.72	89.7	3.53	x		x		
Z12	x					●	●	■	■				185.5	7.30	193.9	7.63	65	2.56	85.7	3.37	105.5	4.15	x		x		
Z13	x					●		■	■				201.0	7.91	209.7	8.26	72	2.83	93.8	3.69	113.4	4.46	x		x		
Z13													201.0	7.91	209.7	8.26	150	5.91	93.8	3.69	113.4	4.46	x			x	
Z16	x					●		■	■				250.8	9.87	257.3	10.13	200	7.87	118.2	4.65	137.1	5.40	x			x	

■ Molded sprocket

● Molded sprocket

■ Machined sprocket

● Machined sprocket

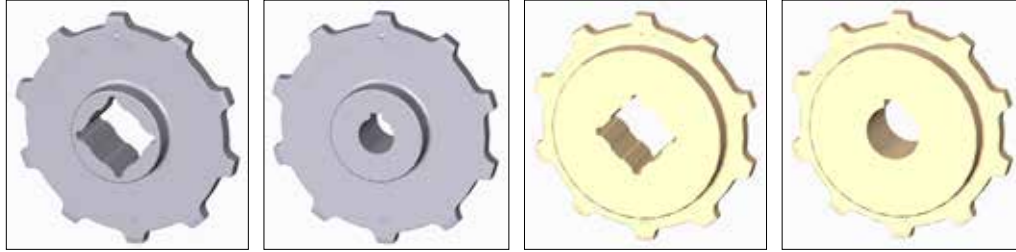

Non standard material and color: See uni Material and Color Overview.

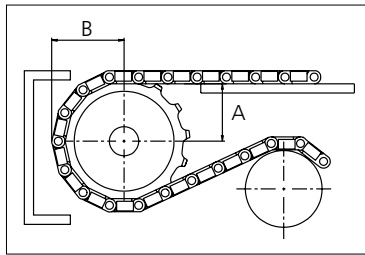

Other sprocket sizes are available upon request.
 Two-part sprocket are available upon request.
 Round bores are always delivered with keyway.
 Other bore sizes are available upon request.
 uni Retainer Rings: See uni Retainer Ring data sheet
 Width of tooth = 11.0 mm (0.43 in)
 Width of sprocket = 42.3 mm (1.67 in)

Max load per sprocket shown does not take bore size into account.
 Please also ensure that sufficient size shaft is chosen for corresponding load.

For correct sprocket position: See uni Assembly Instructions for uni OPB.
 For more detailed sprocket information, contact Customer Service.

uni OPB 8M C/1301



Solid advice
 For all your belting needs
 Local stock & service
www.ammeraalbeltech.com

Ammeraal Beltech Modular A/S
 Hjulmagervej 21
 DK-7100 Vejle

T +45 7572 3100
 F +45 7572 3348
 admin@unichains.com
 www.unichains.com

This information is subject to alteration due to continuous development. Ammeraal Beltech will not be held liable for the incorrect use of the above stated information. This information replaces previous information. All activities performed and services rendered by Ammeraal Beltech are subject to general terms and conditions of sale and delivery, as applied by its operating companies.



Plastic Modular Belt

Series **uni OPB 8P** Type **C**

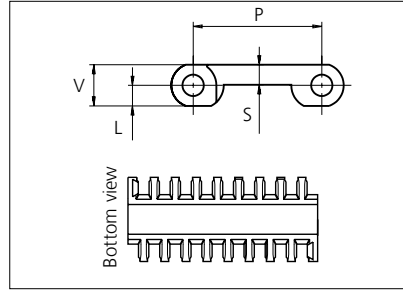

Straight running belt
 Nominal pitch: 50.0 mm (1.97 in)
 Surface type: Flat
 Surface opening: Closed
 Backflex radius: 75.0 mm (3.00 in)
 Pin diameter: \varnothing 8 mm (1.97 in)

*uni-chains recommends this travel direction. However, travel in both directions is possible.

Recommended belt material & color	POM-D W		mm	in		mm	in
		P (Nominal)	50.0	1.97	V	16.0	0.63
Recommended pin and lock material & color	PP W						
		L	8.0	0.31	S	7.8	0.31

Non standard material and color: See uni Material and Color Overview.

Alternative materials: Belt: POM-LF, POM-SLF, PP, PE, PA6.6 and PA6.6H Rodlock: PP **W** Endlock: PP **W G B** and PE **W B**
 Lockpin: PE **W** PA6.6 **N** PP **W** Pin: PP **W** PE **W** SS304 and SS316

Belt width		Permissible tensile force (Belt/pin material)						Belt weight (Belt/pin material)						*Min. No. drive sprocket per shaft	Number of wear strips (Min. No.)	
		POM-D/PA6.6		PP/PA6.6		PE/PA6.6		POM-D/PA6.6		PP/PA6.6		PE/PA6.6			**Carry (pcs)	**Return (pcs)
mm	in	N	lbf	N	lbf	N	lbf	kg/m	lb/ft	kg/m	lb/ft	kg/m	lb/ft			
152	6.0	1672	376	836	188	502	113	1.8	1.20	1.1	0.77	1.2	0.83	2	2	2
303	11.9	3333	749	1667	375	1000	225	3.5	2.38	2.3	1.53	2.5	1.65	3	3	2
455	17.9	5005	1125	2503	563	1502	338	5.3	3.58	3.4	2.29	3.7	2.48	4	4	2
606	23.9	6666	1499	3333	749	2000	450	7.1	4.76	4.5	3.05	4.9	3.30	5	5	3
758	29.8	8338	1874	4169	937	2501	562	8.9	5.96	5.7	3.82	6.1	4.13	6	6	3
909	35.8	9999	2248	5000	1124	3000	674	10.6	7.15	6.8	4.58	7.4	4.95	7	7	4
1061	41.8	11671	2624	5836	1312	3501	787	12.4	8.34	8.0	5.35	8.6	5.78	8	8	4
1212	47.7	13332	2997	6666	1499	4000	899	14.2	9.53	9.1	6.11	9.8	6.60	9	9	5
1364	53.7	15004	3373	7502	1686	4501	1012	16.0	10.73	10.2	6.88	11.0	7.43	10	10	5
1515	59.6	16665	3746	8333	1873	5000	1124	17.7	11.91	11.4	7.64	12.3	8.25	11	11	6
1667	65.6	18337	4122	9169	2061	5501	1237	19.5	13.11	12.5	8.40	13.5	9.07	12	12	6
1818	71.6	19998	4496	9999	2248	5999	1349	21.3	14.29	13.6	9.16	14.7	9.90	13	13	7
1970	77.6	21670	4871	10835	2436	6501	1461	23.0	15.49	14.8	9.93	16.0	10.72	14	14	7

Additional standard belt widths are available in steps of 151.5 mm (5.96 in.) Additional non-standard belt widths are available in steps of 33.5 mm (1.32 in.)

2576	101.4	28336	6370	14168	3185	8501	1911	30.1	20.26	19.3	12.98	20.9	14.02	18	18	9
------	-------	-------	------	-------	------	------	------	------	-------	------	-------	------	-------	----	----	---

Additional standard belt widths are available in steps of 151.5 mm (5.96 in.) Additional non-standard belt widths are available in steps of 33.5 mm (1.32 in.)

2879	113.3	31669	7119	15835	3560	9501	2136	33.7	22.64	21.6	14.51	23.3	15.67	20	20	10
------	-------	-------	------	-------	------	------	------	------	-------	------	-------	------	-------	----	----	----

General belt tolerance is +0/-0.4% at 23°C/73°F and 50% RH. For exact belt width contact Customer Service. Non standard belt width on request.

*Max. Load per Drive Sprocket. Belt material: POM 2500 N (562 lbf), PP 1200 N (270 lbf), PE 500 N (270 lbf)

**Max. Spacing between wear strips, Carry: 152 mm (6 in.); Return: 304 mm (12 in.)



NON STANDARD

STRAIGHT RUNNING

PITCH 50.0 MM/1.97 IN

Accessories

Rubber Top

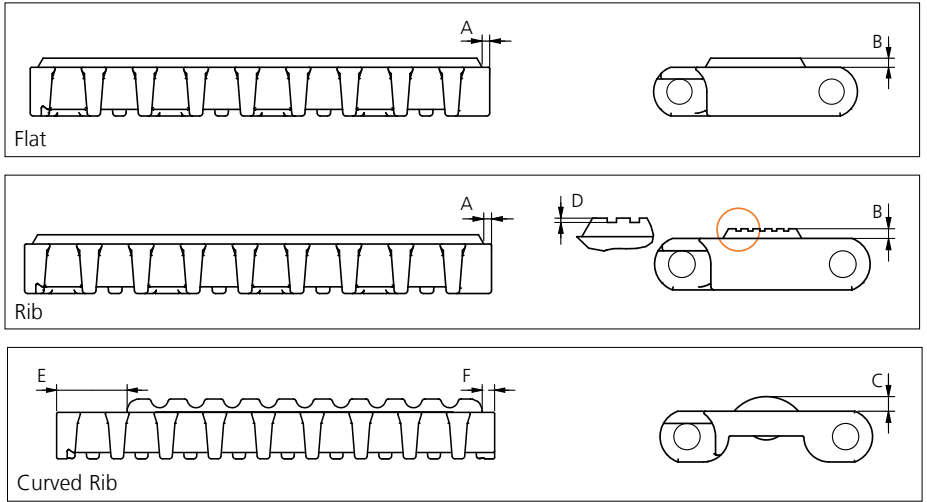

Type	Belt Material & color	Rubber Material & color	A		B		C		D		E		F		Link size	Width	
			mm	in	mm	in	mm	in	mm	in	mm	in	mm	in		mm	in
Flat	POM-LF BR	03 N															
Rib	POM-D W		2.5	0.10	3.0	0.12	4.5	0.18	0.7	0.03	24.0	0.94	4.0	0.16	K600	150.5	5.93
Curved Rib	POM-D W	03 K															

Other Non Standard Rubber profiles: See uni Rubber Profile Overview.

Accessories

Flight

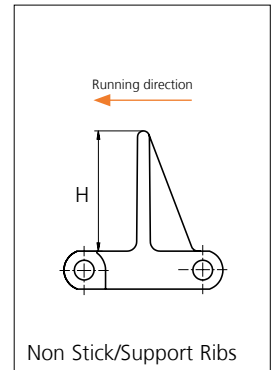
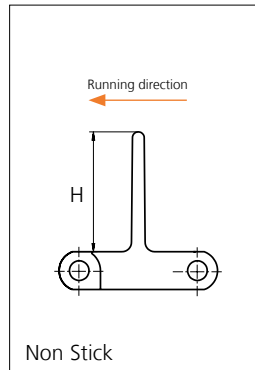

Type	Recommended Material & color	H		Link size	Width		Indent	
		mm	in		mm	in	mm	in
Non Stick	PP-HW B	50.8	2.00	K600	151.0	5.94	0.0	0.00
Non Stick/Support Ribs		76.2	3.00					
		101.6	4.00					

Non Standard material and color: See uni Material and Color Overview.

Accessories

Side Guard

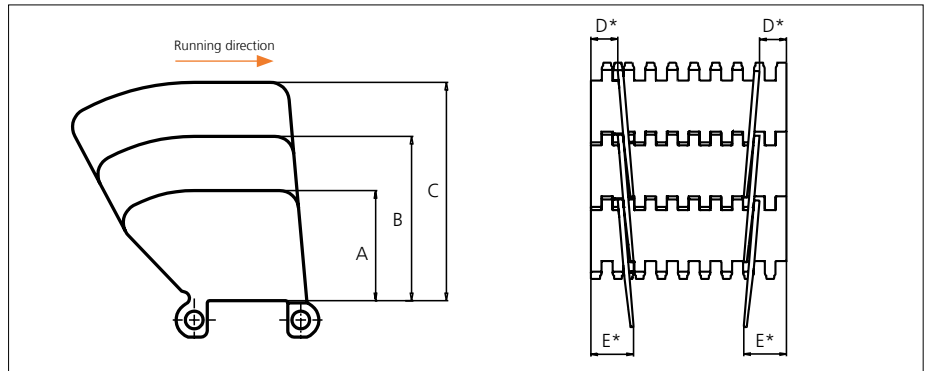

Type	Recommended Material & color	A		B		C		D*		E*	
		mm	in	mm	in	mm	in	mm	in	mm	in
Closed	PP-HW B	51.8	2.04	77.2	3.04	102.6	4.04	21.0	0.83	34.0	1.34

* Min. indent Increment : 8.4 mm (0.33 in)

Note: Backflex radius when side guard are used: 200.0 mm (7.90 in)

Non Standard material and color: See uni Material and Color Overview.

Accessories

Tab

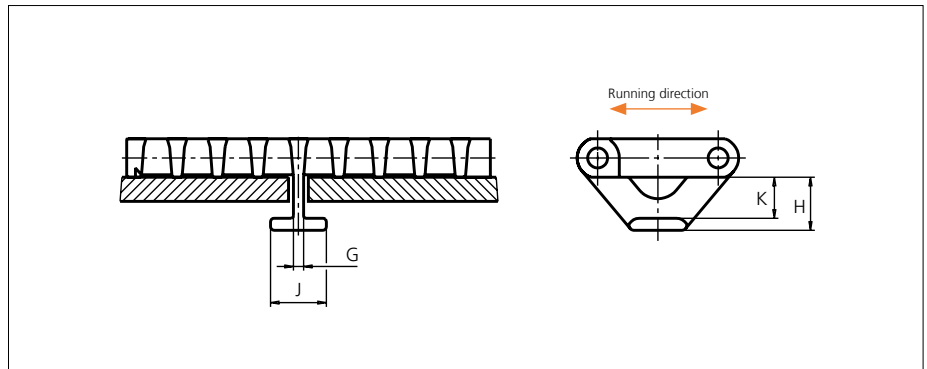

Type	Recommended Material & color	G		H		J		K	
		mm	in	mm	in	mm	in	mm	in
Bottom Hold Down	POM-D W	4.2	0.17	22.0	0.87	23.2	0.92	17.0	0.67
	POM-LF B								
	PP W								

Non Standard material and color: See uni Material and Color Overview.

Accessories

Non Standard uni AmFlight

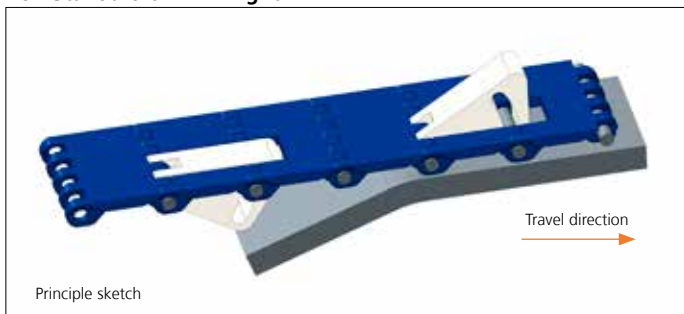

Other Non Standard option: See uni AmFlight Overview.

Sprocket

No of teeth	Bore size													Overall diameter		Pitch diameter		Hub diameter		A-dimension		B-dimension		Single row/Two way	Double row/Two way	Molded PA6 LG	Machined PA6 N
	Pilot Bore	in	0.75	0.78	0.98	1.00	1.18	1.25	1.50	1.57	2.36	2.50	3.54														
	mm	19.1	20.0	25.0	25.4	30.0	31.8	38.1	40.0	60.0	63.5	90.0	mm	in	mm	in	mm	in	mm	in							
Z06	x				●	●	●	■	■				89.1	3.51	100.3	3.95	65	2.56	35.5	1.40	58.6	2.31	x		x		
Z08	x				●	●	●	■	■				120.9	4.76	131.1	5.16	65	2.56	52.6	2.07	74	2.91	x		x		
Z10	x					●	●	■	■	■			153.0	6.02	162.4	6.39	65	2.56	69.2	2.72	89.7	3.53	x		x		
Z12	x					●	●	■	■	■			185.5	7.30	193.9	7.63	65	2.56	85.7	3.37	105.5	4.15	x		x		
Z13	x					●		■	■	■			201.0	7.91	209.7	8.26	72	2.83	93.8	3.69	113.4	4.46	x		x		
Z13													201.0	7.91	209.7	8.26	150	5.91	93.8	3.69	113.4	4.46	x			x	
Z16	x					●		■	■	■			250.8	9.87	257.3	10.13	200	7.87	118.2	4.65	137.1	5.40	x			x	

■ Molded sprocket

● Molded sprocket

■ Machined sprocket

● Machined sprocket

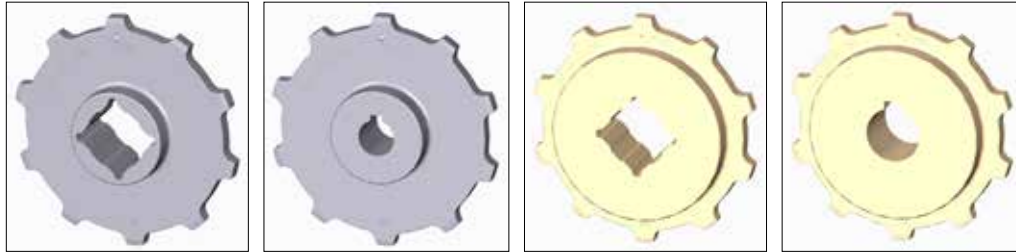

Non standard material and color: See uni Material and Color Overview.

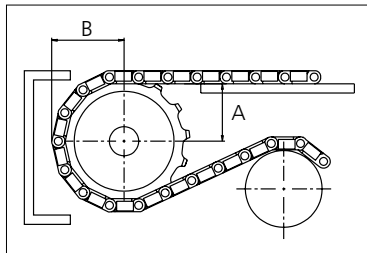

Other sprocket sizes are available upon request.
 Two-part sprocket are available upon request.
 Round bores are always delivered with keyway.
 Other bore sizes are available upon request.
 uni Retainer Rings: See uni Retainer Ring data sheet
 Width of tooth = 11.0 mm (0.43 in)
 Width of sprocket = 42.3 mm (1.67 in)

Max load per sprocket shown does not take bore size into account.
 Please also ensure that sufficient size shaft is chosen for corresponding load.

For correct sprocket position: See uni Assembly Instructions for uni OPB.
 For more detailed sprocket information, contact Customer Service.

uni OPB 8P C/1301



Solid advice
 For all your belting needs
 Local stock & service
www.ammeraalbeltech.com

Ammeraal Beltech Modular A/S
 Hjulmagervej 21
 DK-7100 Vejle

T +45 7572 3100
 F +45 7572 3348
 admin@unichains.com
 www.unichains.com

This information is subject to alteration due to continuous development. Ammeraal Beltech will not be held liable for the incorrect use of the above stated information. This information replaces previous information. All activities performed and services rendered by Ammeraal Beltech are subject to general terms and conditions of sale and delivery, as applied by its operating companies.



Plastic Modular Belt

Series **uni OPB 8** Type **Rough**

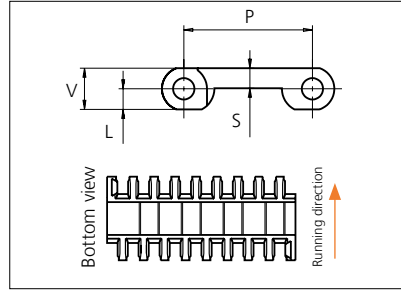

Straight running belt
 Nominal pitch: 50.0 mm (1.97 in)
 Surface type: Rough
 Surface opening: Closed
 Backflex radius: 75.0 mm (3.00 in)
 Pin diameter: \varnothing 8 mm (1.97 in)

*uni-chains recommends this travel direction. However, travel in both directions is possible.

Recommended belt material & color	POM-D W	mm	in	mm	in		
		P (Nominal)	50.0	1.97	V	16.0	0.63
Recommended pin and lock material & color	PP W	L	8.0	0.31	S	7.8	0.31

Non standard material and color: See uni Material and Color Overview.

Alternative materials: Belt: POM-LF, POM-SLF, PP, PE, PA6.6 and PA6.6H Rodlock: PP **W** Endlock: PP **W** **G** **B** and PE **W** **B**
 Lockpin: PE **W** PA6.6 **N** PP **W** Pin: PP **W** PE **W** SS304 and SS316

Belt width		Permissible tensile force (Belt/pin material)						Belt weight (Belt/pin material)						*Min. No. drive sprocket per shaft	Number of wear strips (Min. No.)	
		POM-D/PA6.6		PP/PA6.6		PE/PA6.6		POM-D/PA6.6		PP/PA6.6		PE/PA6.6			**Carry (pcs)	**Return (pcs)
mm	in	N	lbf	N	lbf	N	lbf	kg/m	lb/ft	kg/m	lb/ft	kg/m	lb/ft			
152	6.0	3344	752	1672	376	1003	226	1.8	1.20	1.1	0.77	1.2	0.83	2	2	2
303	11.9	6666	1499	3333	749	2000	450	3.5	2.38	2.3	1.53	2.5	1.65	3	3	2
455	17.9	10010	2250	5005	1125	3003	675	5.3	3.58	3.4	2.29	3.7	2.48	4	4	2
606	23.9	13332	2997	6666	1499	4000	899	7.1	4.76	4.5	3.05	4.9	3.30	5	5	3
758	29.8	16676	3749	8338	1874	5003	1125	8.9	5.96	5.7	3.82	6.1	4.13	6	6	3
909	35.8	19998	4496	9999	2248	5999	1349	10.6	7.15	6.8	4.58	7.4	4.95	7	7	4
1061	41.8	23342	5247	11671	2624	7003	1574	12.4	8.34	8.0	5.35	8.6	5.78	8	8	4
1212	47.7	26664	5994	13332	2997	7999	1798	14.2	9.53	9.1	6.11	9.8	6.60	9	9	5
1364	53.7	30008	6746	15004	3373	9002	2024	16.0	10.73	10.2	6.88	11.0	7.43	10	10	5
1515	59.6	33330	7493	16665	3746	9999	2248	17.7	11.91	11.4	7.64	12.3	8.25	11	11	6
1667	65.6	36674	8244	18337	4122	11002	2473	19.5	13.11	12.5	8.40	13.5	9.07	12	12	6
1818	71.6	39996	8991	19998	4496	11999	2697	21.3	14.29	13.6	9.16	14.7	9.90	13	13	7
1970	77.6	43340	9743	21670	4871	13002	2923	23.0	15.49	14.8	9.93	16.0	10.72	14	14	7

Additional standard belt widths are available in steps of 151.5 mm (5.96 in.) Additional non-standard belt widths are available in steps of 33.5 mm (1.32 in.)

2576	101.4	56672	12740	28336	6370	17002	3822	30.1	20.26	19.3	12.98	20.9	14.02	18	18	9
------	-------	-------	-------	-------	------	-------	------	------	-------	------	-------	------	-------	----	----	---

Additional standard belt widths are available in steps of 151.5 mm (5.96 in.) Additional non-standard belt widths are available in steps of 33.5 mm (1.32 in.)

2879	113.3	63338	14238	31669	7119	19001	4272	33.7	22.64	21.6	14.51	23.3	15.67	20	20	10
------	-------	-------	-------	-------	------	-------	------	------	-------	------	-------	------	-------	----	----	----

General belt tolerance is +0/-0.4% at 23°C/73°F and 50% RH. For exact belt width contact Customer Service. Non standard belt width on request.

*Max. Load per Drive Sprocket. Belt material: POM 2500 N (562 lbf), PP 1200 N (270 lbf), PE 500 N (270 lbf)

**Max. Spacing between wear strips, Carry: 152 mm (6 in.); Return: 304 mm (12 in.)



NON STANDARD

STRAIGHT RUNNING

PITCH 50.0 MM/1.97 IN

Accessories

Tab

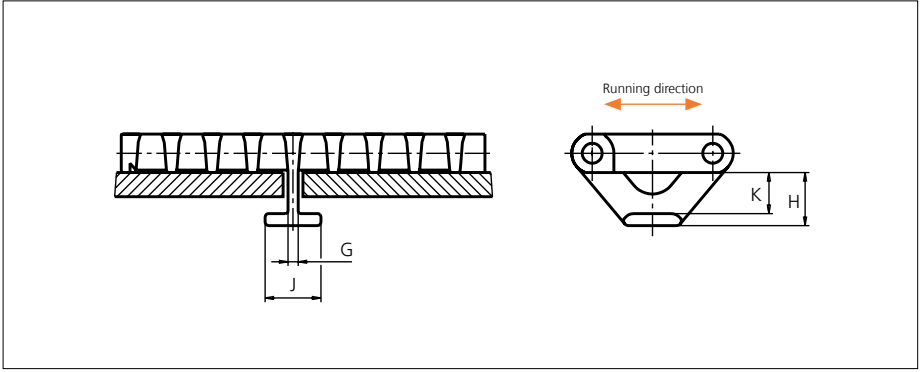

Type	Recommended material & color	G		H		J		K	
		mm	in	mm	in	mm	in	mm	in
Bottom Hold Down	POM-D W	4.2	0.17	22.0	0.87	23.2	0.92	17.0	0.67
	POM-LF B								
	POM-D W								

Non Standard material and color: See uni Material and Color Overview.

Sprocket

No of teeth	Bore size													Overall diameter		Pitch-diameter		Hub-diameter		A-dimension		B-dimension		Single row/Two way	Double row/Two way	Material					
	Pilot Bore	mm	in	0.75	0.78	0.98	1.00	1.18	1.25	1.50	1.57	2.36	2.50													3.54	60.0	63.5	90.0	mm	in
														PA6	PA6 LG																
Z06	x						●	●	●	■	■							94.5	3.72	100.3	3.95	65	2.56	35.5	1.40	58.6	2.31	x		x	
Z08	x						●	●	●	■	■							129	5.08	131.1	5.16	65	2.56	52.6	2.07	74	2.91	x		x	
Z10	x							●	●	■	■							160.1	6.30	162.4	6.39	65	2.56	69.2	2.72	89.7	3.53	x		x	
Z12	x							●	●	■	■							191.5	7.54	193.9	7.63	65	2.56	85.7	3.37	105.5	4.15	x		x	
Z13	x							●		■	■							207.3	8.16	209.7	8.26	72	2.83	93.8	3.69	113.4	4.46	x		x	
Z13															■			207.3	8.16	209.7	8.26	150	5.91	93.8	3.69	113.4	4.46	x			x
Z16	x							●		■	■						■	254.8	10.03	257.3	10.13	200	7.87	118.2	4.65	137.1	5.40	x			x

■ Molded sprocket

● Molded sprocket

■ Machined sprocket

● Machined sprocket

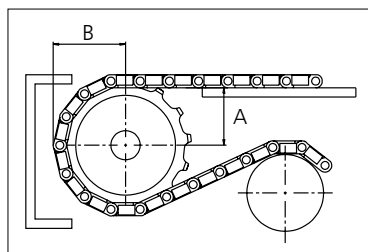
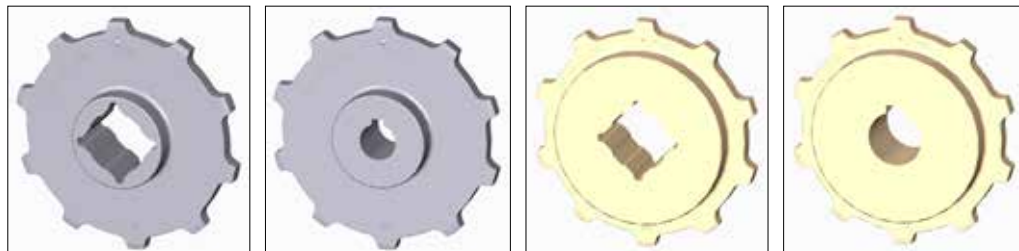

Other sprocket sizes are available upon request.
 Two-part sprocket are available upon request.
 Round bores are always delivered with keyway.
 Other bore sizes are available upon request.
 uni Retainer Rings: See uni Retainer Ring data sheet
 Width of tooth = 11.0 mm (0.43 in)
 Width of sprocket = 42.3 mm (1.67 in)

Max load per sprocket shown does not take bore size into account.
 Please also ensure that sufficient size shaft is chosen for corresponding load.

For correct sprocket position: See uni Assembly Instructions for uni OPB.
 For more detailed sprocket information, contact Customer Service.

Non standard material and color: See uni Material and Color Overview.



Conveyor



Seamless



Modular



Timing



Transmission



Fabrication & service

Solid advice
For all your belting needs
Local stock & service
www.ammeraalbeltech.com

Ammeraal Beltech Modular A/S
Hjulmagervej 21
DK-7100 Vejle

T +45 7572 3100
F +45 7572 3348
admin@unichains.com
www.unichains.com

This information is subject to alteration due to continuous development. Ammeraal Beltech will not be held liable for the incorrect use of the above stated information. This information replaces previous information. All activities performed and services rendered by Ammeraal Beltech are subject to general terms and conditions of sale and delivery, as applied by its operating companies.

Local Contacts

Austria

T +43 171728 133
info-de@ammeraalbeltech.com
www.ammeraalbeltech.at

Belgium

T +32 2 466 03 00
info-be@ammeraalbeltech.com
www.ammeraalbeltech.be

Canada

T +1 905 890 1311
info-ca@ammeraalbeltech.com
www.ammeraalbeltech.com

Chile

T +56 2 233 12900
info-cl@ammeraalbeltech.com
www.ammeraalbeltech.cl

China

T +86 512 8287 2709
info-cn@ammeraalbeltech.com
www.ammeraalbeltech.com.cn

Czech Republic

T +420 567 117 211
info-cz@ammeraalbeltech.com
www.ammeraalbeltech.cz

Denmark

T + 45 7572 3100
info-dk@ammeraalbeltech.com
www.unichains.com

Finland

T +358 207 911 400
info-fi@ammeraalbeltech.com
www.ammeraalbeltech.fi

France

T +33 3 20 90 36 00
info-fr@ammeraalbeltech.com
www.ammeraalbeltech.fr

Germany

T +49 4152 937-0
info-de@ammeraalbeltech.com
www.ammeraalbeltech.de

Hungary

T +36 30 311 6099
info-hu@ammeraalbeltech.com
www.ammeraalbeltech.hu

India

T +91 44 265 34 244
info-in@ammeraalbeltech.com
www.ammeraalbeltech.com

Italy

T +39 051 660 60 06
info-it@ammeraalbeltech.com
www.ammeraalbeltech.it

Luxembourg

T +352 26 48 38 56
info-lu@ammeraalbeltech.com
www.ammeraal-beltech.lu

Malaysia

T +60 3 806 188 49
info-my@ammeraalbeltech.com
www.ammeraalbeltech.com

Netherlands

T +31 72 57 51212
info-nl@ammeraalbeltech.com
www.ammeraalbeltech.nl

Poland

T +48 32 44 77 179
info-pl@ammeraalbeltech.com
www.ammeraalbeltech.com

Portugal

T +351 22 947 94 40
info-pt@ammeraalbeltech.com
www.ammeraalbeltech.pt

Singapore

T +65 62739767
info-sg@ammeraalbeltech.com
www.ammeraalbeltech.com

Slovakia

T +421 2 55648541-2
info-sk@ammeraalbeltech.com
www.ammeraalbeltech.sk

South Korea

T +82 31 448 3613-7
info-kr@ammeraalbeltech.com
www.ammeraalbeltech.co.kr

Spain

T +34 93 718 3054
info-es@ammeraalbeltech.com
www.ammeraalbeltech.es

Sweden

T +46 44 780 3010
info-se@ammeraalbeltech.com
www.ammeraalbeltech.se

Switzerland

T +41 55 2253 535
info-ch@ammeraalbeltech.com
www.ammeraalbeltech.ch

Thailand

T +66 2 902 2604-13
info-th@ammeraalbeltech.com
www.ammeraalbeltech.com

United Kingdom

T +44 1992 500550
info-uk@ammeraalbeltech.com
www.ammeraalbeltech.co.uk

United States

T +1 847 673 6720
info-us@ammeraalbeltech.com
www.ammeraalbeltech.com

Vietnam

T +84 8 376 562 05
info-vn@ammeraalbeltech.com
www.ammeraalbeltech.com.vn

Global Headquarters:

Ammeraal Beltech Holding B.V.

P.O. Box 38
1700 AA Heerhugowaard
The Netherlands

T +31 (0)72 575 1212
F +31 (0)72 571 6455

info@ammeraalbeltech.com
www.ammeraalbeltech.com

Expert advice, quality solutions
and local service
for all your belting needs

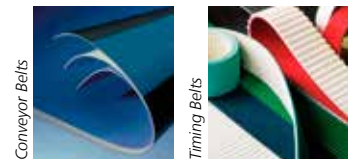

Conveyor Belts

Timing Belts

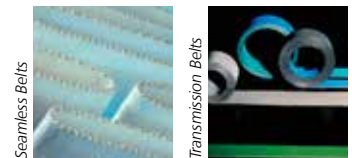

Seamless Belts

Transmission Belts



Modular Belts

Fabrication & service

... and 150 more service contact points on www.ammeraalbeltech.com